

Arts & Entertainment

Central Business District

Brickell

- DESTINATIONS
- DOWNTOWN DISTRICTS
 - Arts & Entertainment
 - Central Business District
 - Brickell
- SUBDISTRICTS
 - Flagler St Shopping
 - Brickell Village
- Transportation
 - State/US Road

Wayfinding & Signage System Program

Downtown Miami, FL



Downtown Miami Parking Program

Sign No. 304



Downtown Miami Parking Program

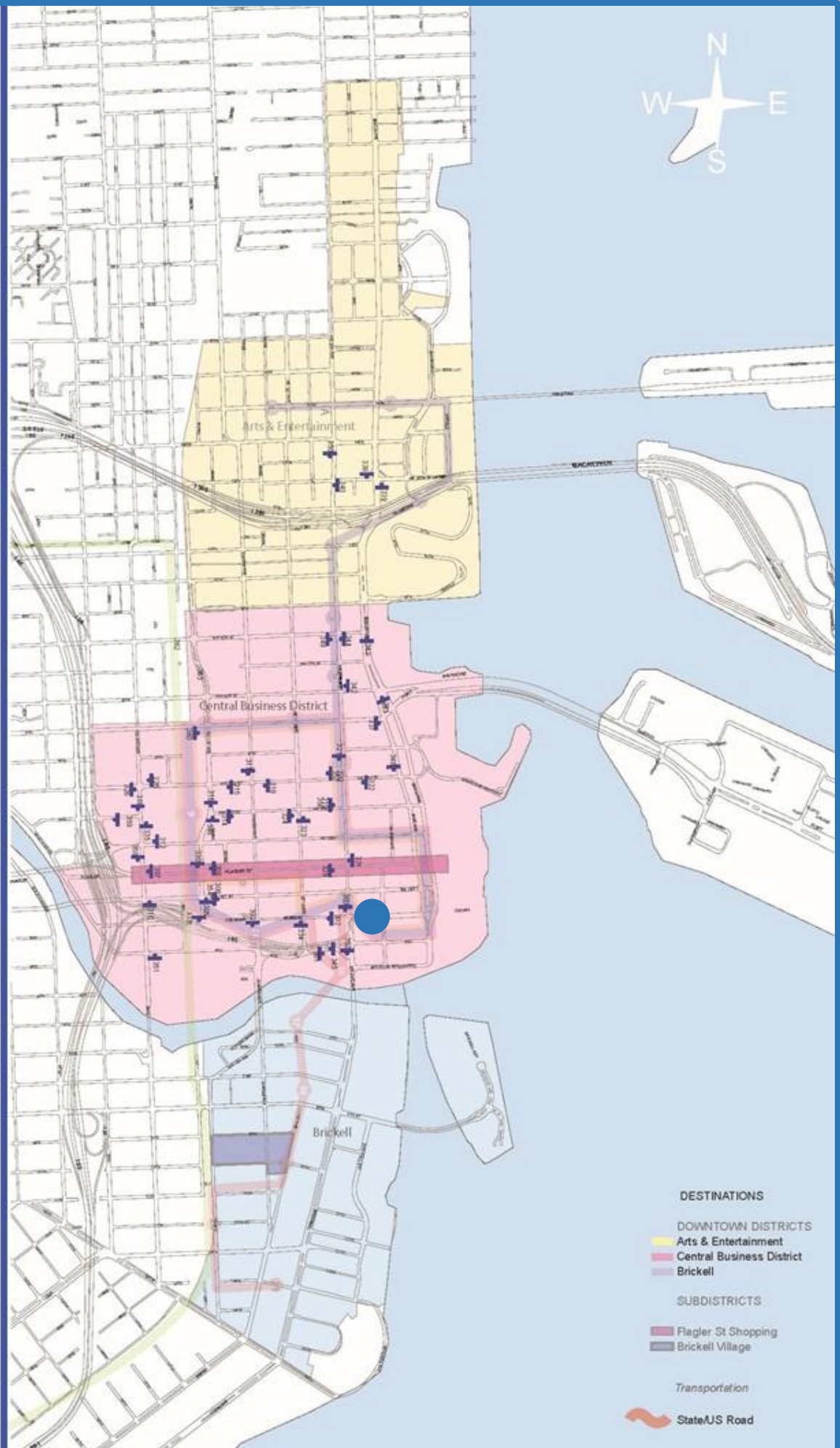

Wayfinding & Signage System Program

Downtown Miami, Florida

SIGN NO. 304

Location Aerial View:

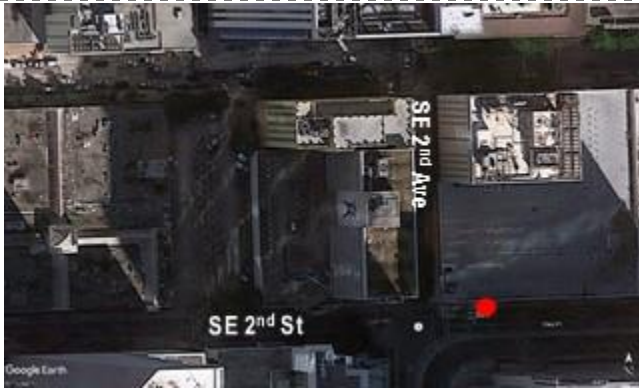

Location Photo:



Reference Intersection: SE 2nd St @ SE 2nd Ave

Detailed Location: 25' west of overhang sign

Orientation: WB

Right-of-Way Summary	Utilities Summary
State of Florida	FPL Duct Bank FPL Fibernet Cable Street Light Cable

Sign Type: PARK.2

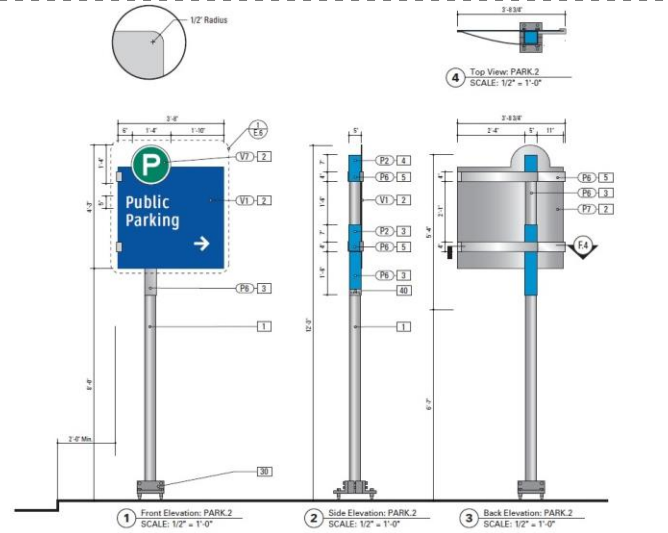

Sign Message:

Face A	P Convention / Knight Center Garage ↑
Face B	None

Ground Condition: Concrete

Foundation Type: 2' X 4' 9" Square

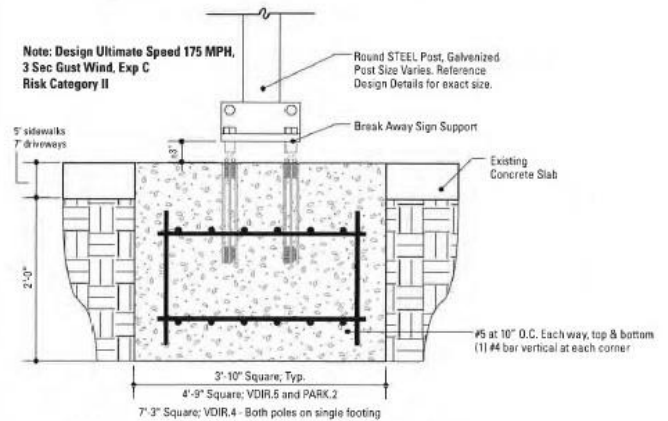

SPECIFIC PURPOSE SURVEY PROPOSED POLE 304

SURVEYOR'S REPORT :

- THE SPECIFIC PURPOSE OF THIS SURVEY IS TO SHOW THE LOCATION OF THE PROPOSED POLE IN RELATION TO THE MONUMENT LINES AND RIGHT-OF-WAY LINES.
- THIS IS NOT A BOUNDARY SURVEY
- THE LOCATION OF THE PROPOSED POLE SHOWN HEREON WAS PROVIDED BY THE CLIENT.
- THERE ARE EXISTING IMPROVEMENTS LYING WITHIN THE LIMITS OF THE SKETCH, WHICH ARE NOT SHOWN ON THIS SURVEY.
- REVIEW OF TITLE SEARCH WAS NOT PART OF THE SCOPE OF SERVICES.
- RIGHT-OF-WAY LINES ARE AS PER CITY OF MIAMI ATLAS SHEET AND MIAMI-DADE COUNTY PLATS OF RECORD.
- POLE 304 LIES WITHIN THE JURISDICTION OF STATE OF FLORIDA.
- INFORMATION REGARDING STREET JURISDICTION WAS TAKEN FROM MAP ENTITLED : DOWNTOWN MIAMI STREETS BY JURISDICTION PREPARED BY CITY OF MIAMI DATED SEPTEMBER 1, 2015 AND FURNISHED BY THE CLIENT.

SURVEYOR'S CERTIFICATION :

I HEREBY CERTIFY THAT THIS SPECIFIC PURPOSE SURVEY WAS PREPARED UNDER MY DIRECT SUPERVISION AND THAT IT IS TRUE AND CORRECT TO THE BEST OF MY KNOWLEDGE AND BELIEF AND I FURTHER CERTIFY THAT SAID SURVEY IS IN COMPLIANCE WITH THE STANDARDS OF PRACTICE AS SET FORTH BY THE FLORIDA BOARD OF LAND SURVEYORS AND MAPPERS IN CHAPTER 5J-17 FLORIDA ADMINISTRATIVE CODE PURSUANT TO SECTION 472.027 OF THE FLORIDA STATUTES.

 MANUEL G. VERA JR.
 PROFESSIONAL SURVEYOR AND MAPPER No. 5291
 STATE OF FLORIDA
 NOTICE: NOT VALID WITHOUT THE SIGNATURE AND ORIGINAL RAISED SEAL OF THE FLORIDA LICENSED SURVEYOR AND MAPPER.
 EACH SHEET AS INCORPORATED HEREIN SHALL NOT BE CONSIDERED FULL, VALID AND COMPLETE UNLESS ATTACHED TO THE OTHERS.

FOR SKETCH SEE SHEET 2

MANUEL G.VERA AND ASSOCIATES, INC.
 ENGINEERS-SURVEYORS & MAPPERS
 13960 S.W. 47th ST. MIAMI, FLORIDA 33175 L.B. No.2439
 PHONE: (305) 221-6210 e-mail: mverajr@mgvera.com

PROJECT NUMBER: 16-574		
TYPE OF PROJECT: SPECIFIC PURPOSE SURVEY		
PROJECT NAME: POLE LOCATION		
DATE: 09-22-16	SCALE	SHEET
DRAWN BY: JCF	N.A.	1 OF 2

NOT A BOUNDARY SURVEY

SPECIFIC PURPOSE SURVEY PROPOSED POLE 304

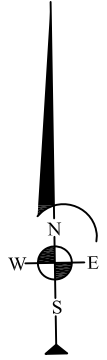

LEGEND:

- EXISTING RIGHT OF WAY LINE
- CENTER LINE
- MONUMENT LINE

MANUEL G.VERA AND ASSOCIATES, INC.
 ENGINEERS-SURVEYORS & MAPPERS
 13960 S.W. 47th ST. MIAMI, FLORIDA 33175 L.B. No.2439
 PHONE: (305) 221-6210 e-mail: mverajr@mgvera.com

PROJECT NUMBER: 16-574		
TYPE OF PROJECT: SPECIFIC PURPOSE SURVEY		
PROJECT NAME: POLE LOCATION		
DATE: 09-22-16	SCALE	SHEET
DRAWN BY: JCF	1"=30'	2 OF 2

NOT A BOUNDARY SURVEY



LOCATION DESCRIPTION:

SE 2nd St E/O SE 2nd Ave.

FOR EXACT SIGN POST LOCATION
PLEASE REFER TO ATTACHED
SPECIFIC PURPOSE SURVEY SKETCH

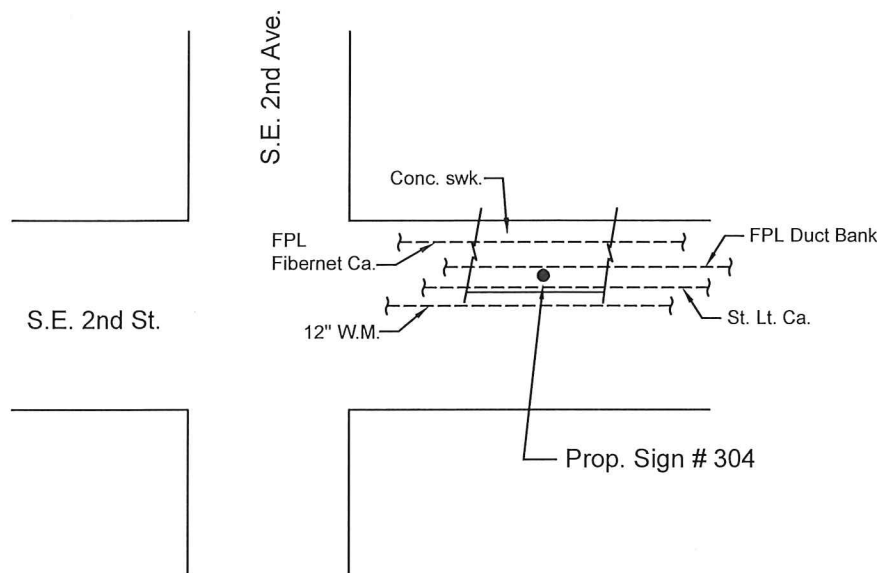

PLAN
NTS

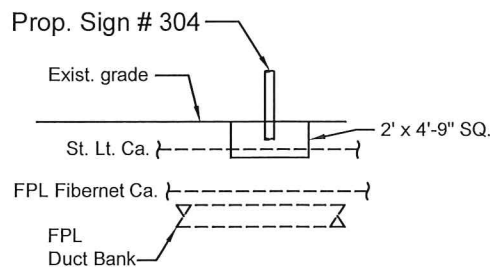

PROFILE
NTS

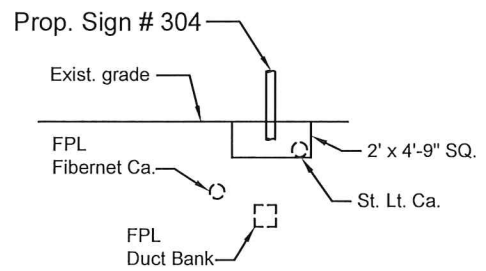

SECTION
(LOOKING EAST)
NTS

COMMENTS: Best Footer for Prop. Sign # 304 is: 2' x 4'-9" SQ.

MIAMI DDA - WAYFINDING AND SIGNAGE SYSTEM PROGRAM

DISCLAIMER:

This sketch has been prepared for utility coordination purposes only. This sketch is Not for Construction.

Utility coordination done by:
JRA Inc.
engineers-planners
10661 N Kendall Dr., Ste. 206B
Miami, FL 33176-1550
Phone 305-270-7800
CA 7613

F.D.O.T.

SIGN No. 304

Type PARK.2

DATE: 04-05-2017

Sign No.
341



Downtown
Miami Parking
Program

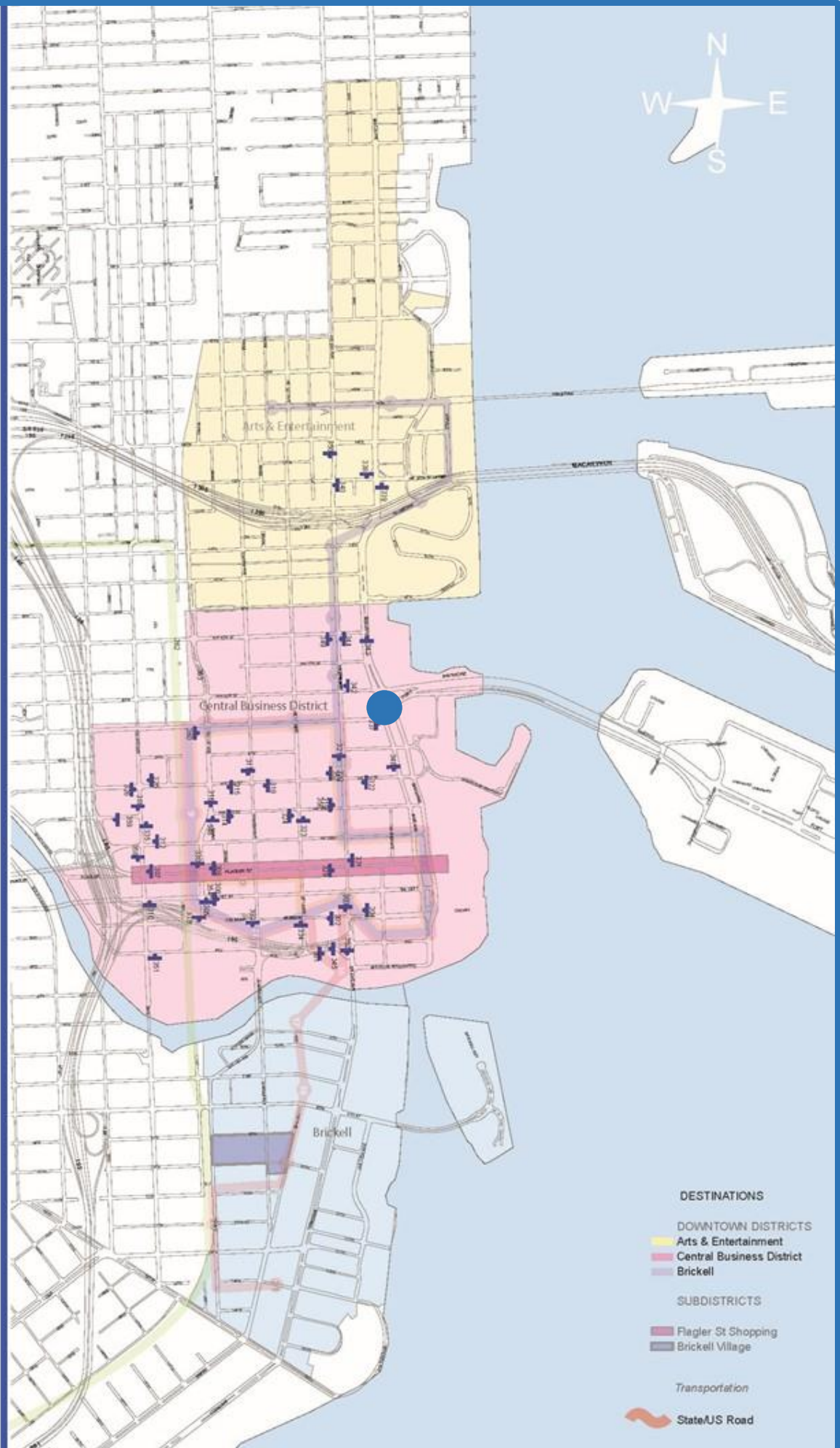

Wayfinding & Signage System Program

Downtown Miami, Florida

SIGN NO. 341

Location Aerial View:



Location Photo:

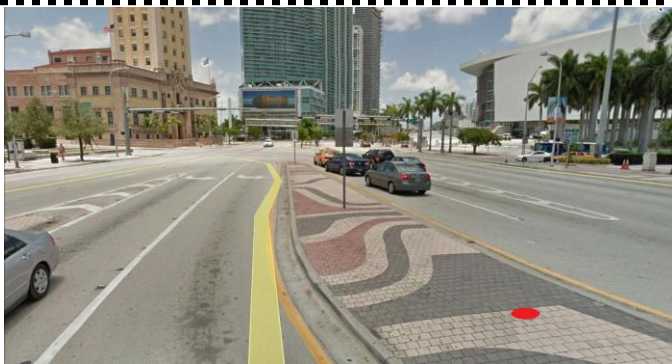

Sign Type: PARK.1A

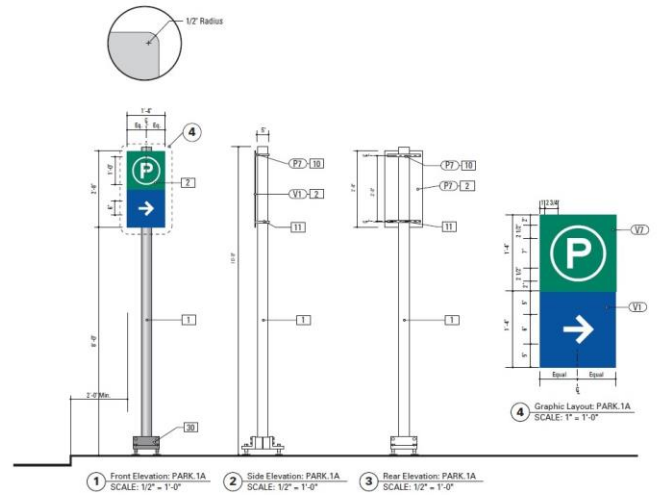

Sign Message:

Face A	P ←
Face B	None

Ground Condition: Concrete

Foundation Type: 5' 6" X 3' Diameter

Reference Intersection: N Biscayne Blvd @ NE 6th St

Detailed Location: Parallel with start of left lane

Orientation: NB

Right-of-Way Summary	Utilities Summary
State of Florida	Sanitary Sewer

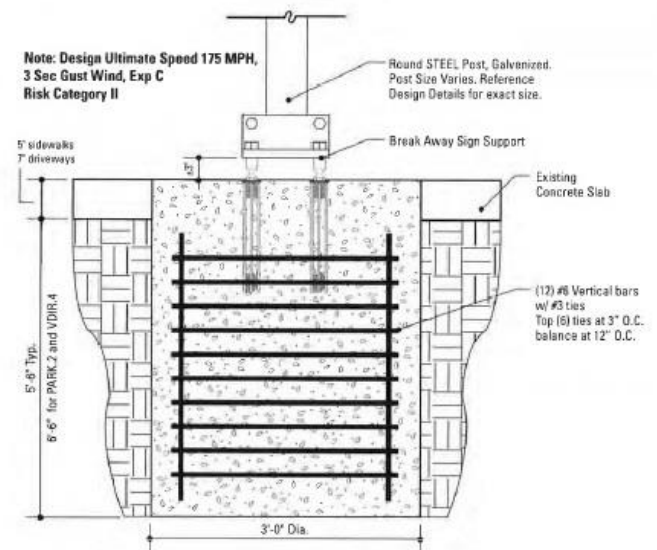

SPECIFIC PURPOSE SURVEY PROPOSED POLES 341

SURVEYOR'S REPORT :

- THE SPECIFIC PURPOSE OF THIS SURVEY IS TO SHOW THE LOCATION OF THE PROPOSED POLE IN RELATION TO THE MONUMENT LINES AND RIGHT-OF-WAY LINES.
- THIS IS NOT A BOUNDARY SURVEY
- THE LOCATION OF THE PROPOSED POLE SHOWN HEREON WAS PROVIDED BY THE CLIENT.
- THERE ARE EXISTING IMPROVEMENTS LYING WITHIN THE LIMITS OF THE SKETCH, WHICH ARE NOT SHOWN ON THIS SURVEY.
- REVIEW OF TITLE SEARCH WAS NOT PART OF THE SCOPE OF SERVICES.
- RIGHT-OF-WAY LINES AND MAPPED (ZONED) STREET LINES ARE AS PER CITY OF MIAMI ATLAS SHEET AND MIAMI-DADE COUNTY PLATS OF RECORD.
- POLE 341 LIES WITHIN THE JURISDICTION OF STATE OF FLORIDA.
- INFORMATION REGARDING STREET JURISDICTION WAS TAKEN FROM MAP ENTITLED : DOWNTOWN MIAMI STREETS BY JURISDICTION PREPARED BY CITY OF MIAMI DATED SEPTEMBER 1, 2015 AND FURNISHED BY THE CLIENT.

SURVEYOR'S CERTIFICATION :

I HEREBY CERTIFY THAT THIS SPECIFIC PURPOSE SURVEY WAS PREPARED UNDER MY DIRECT SUPERVISION AND THAT IT IS TRUE AND CORRECT TO THE BEST OF MY KNOWLEDGE AND BELIEF AND I FURTHER CERTIFY THAT SAID SURVEY IS IN COMPLIANCE WITH THE STANDARDS OF PRACTICE AS SET FORTH BY THE FLORIDA BOARD OF LAND SURVEYORS AND MAPPERS IN CHAPTER 5J-17 FLORIDA ADMINISTRATIVE CODE PURSUANT TO SECTION 472.027 OF THE FLORIDA STATUTES.

 MANUEL G. VERA JR.
 PROFESSIONAL SURVEYOR AND MAPPER No. 5291
 STATE OF FLORIDA
 NOTICE: NOT VALID WITHOUT THE SIGNATURE AND ORIGINAL RAISED SEAL OF THE FLORIDA LICENSED SURVEYOR AND MAPPER.
 EACH SHEET AS INCORPORATED HEREIN SHALL NOT BE CONSIDERED FULL, VALID AND COMPLETE UNLESS ATTACHED TO THE OTHERS.

FOR SKETCH SEE SHEET 2

MANUEL G.VERA AND ASSOCIATES, INC.
 ENGINEERS-SURVEYORS & MAPPERS
 13960 S.W. 47th ST. MIAMI, FLORIDA 33175 L.B. No.2439
 PHONE: (305) 221-6210 e-mail: mverajr@mgvera.com

PROJECT NUMBER: 16-574		
TYPE OF PROJECT: SPECIFIC PURPOSE SURVEY		
PROJECT NAME: POLE LOCATION		
DATE: 07-01-2016	SCALE	SHEET
DRAWN BY: JCF	N.A.	1 OF 2

NOT A BOUNDARY SURVEY

SPECIFIC PURPOSE SURVEY PROPOSED POLE 341

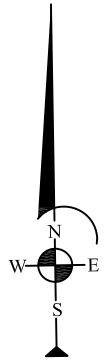

LEGEND:

- EXISTING RIGHT OF WAY LINE
- - - MAPPED (ZONED) STREET LINE
- ⊕ CENTER LINE
- M MONUMENT LINE

ABBREVIATIONS:

- SR - STATE ROAD
- US - UNITED STATE HIGHWAY

NOT A BOUNDARY SURVEY

MANUEL G.VERA AND ASSOCIATES, INC.
ENGINEERS-SURVEYORS & MAPPERS
 13960 S.W. 47th ST. MIAMI, FLORIDA 33175 L.B. No.2439
 PHONE: (305) 221-6210 e-mail: mverajr@mgvera.com

PROJECT NUMBER: 16-574		
TYPE OF PROJECT: SPECIFIC PURPOSE SURVEY		
PROJECT NAME: POLE LOCATION		
DATE: 07-01-2016	SCALE: 1"=40'	SHEET: 2 OF 2
DRAWN BY: JCF		

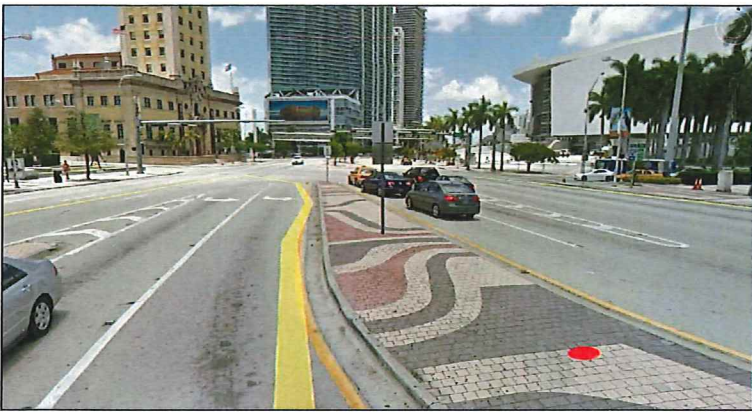

LOCATION DESCRIPTION:

Biscayne Blvd S/O NE 6th St

FOR EXACT SIGN POST LOCATION
PLEASE REFER TO ATTACHED
SPECIFIC PURPOSE SURVEY SKETCH

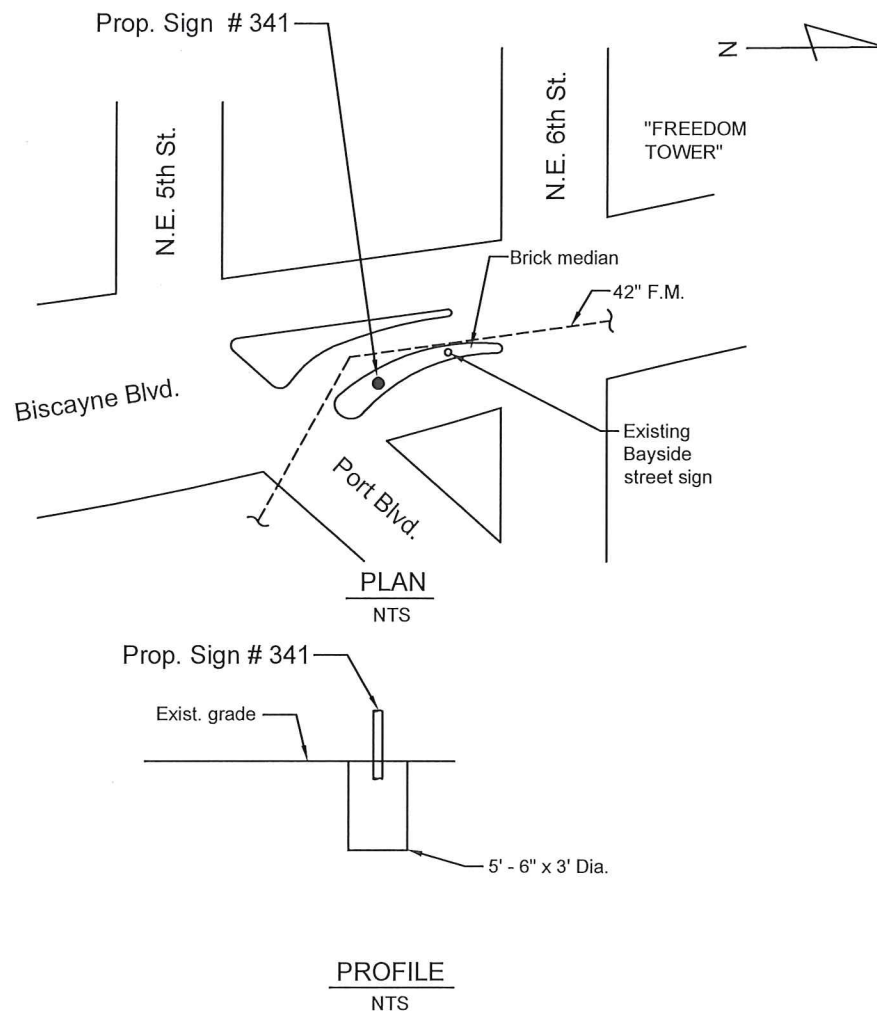

COMMENTS: Best Footer for Prop. Sign # 341 is: 5'-6" x 3' Dia.

MIAMI DDA - WAYFINDING AND SIGNAGE SYSTEM PROGRAM

DISCLAIMER:

This sketch has been prepared for utility coordination purposes only. This sketch is Not for Construction.

Utility coordination done by:
JRA Inc.
engineers-planners
10661 N Kendall Dr., Ste. 206B
Miami, FL 33176-1550
Phone 305-270-7800
CA 7613

F. D. O. T.

SIGN No. 341

Type PARK.1A

DATE: 04-05-2017

Sign No.
343



Downtown
Miami Parking
Program

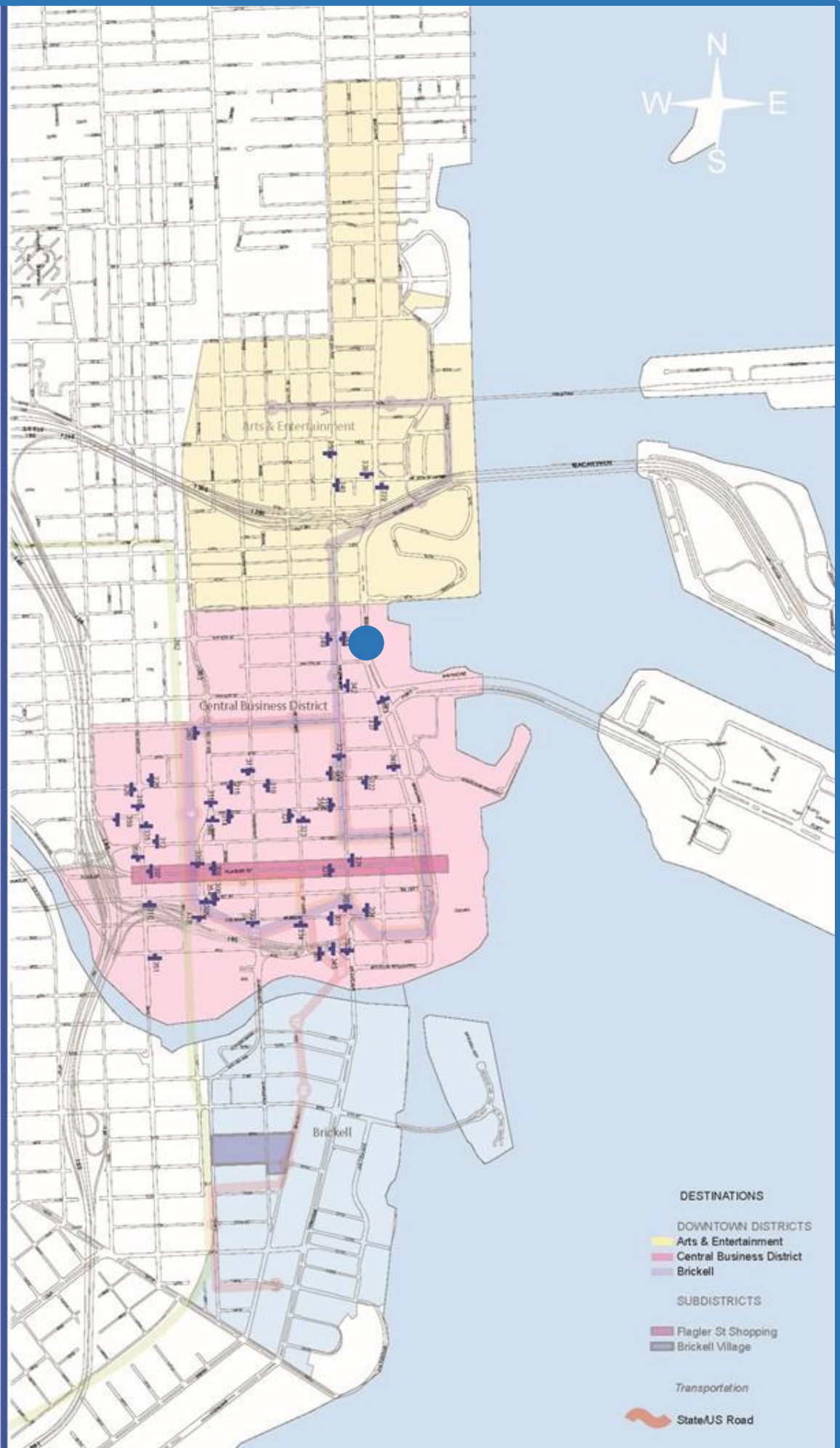

Wayfinding & Signage System Program

Downtown Miami, Florida

SIGN NO. 343

Location Aerial View:



Location Photo:



Reference Intersection: N Biscayne Blvd @ NE 8th St

Detailed Location: Parallel with start of left lane

Orientation: NB

Right-of-Way Summary	Utilities Summary
State of Florida	C.I. Gas Water Main FPL Duct Bank F.M. Water Main B Tel. F.O.

Sign Type: PARK.1A

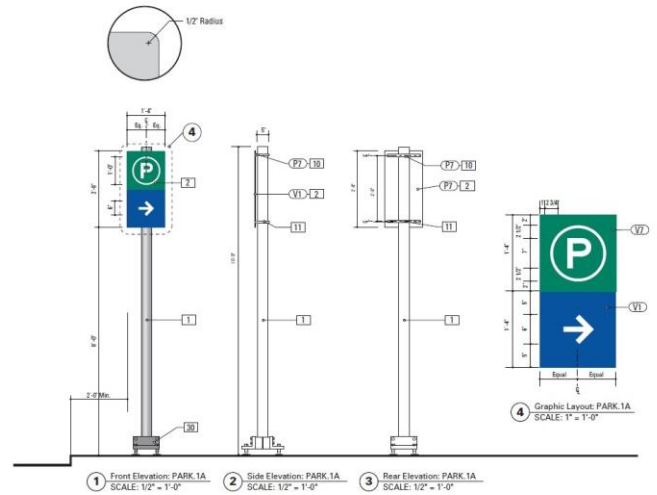

Sign Message:

Face A	P ←
Face B	None

Ground Condition: Concrete

Foundation Type: 2' X 3' 10" Square

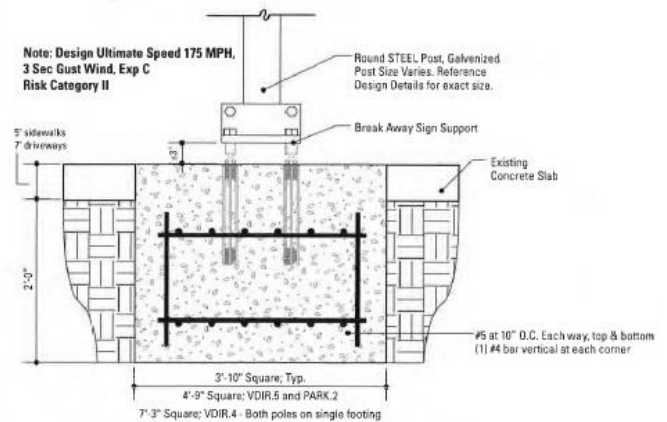

SPECIFIC PURPOSE SURVEY PROPOSED POLES 343

SURVEYOR'S REPORT :

- THE SPECIFIC PURPOSE OF THIS SURVEY IS TO SHOW THE LOCATION OF THE PROPOSED POLE IN RELATION TO THE MONUMENT LINES AND RIGHT-OF-WAY LINES.
- THIS IS NOT A BOUNDARY SURVEY
- THE LOCATION OF THE PROPOSED POLE SHOWN HEREON WAS PROVIDED BY THE CLIENT.
- THERE ARE EXISTING IMPROVEMENTS LYING WITHIN THE LIMITS OF THE SKETCH, WHICH ARE NOT SHOWN ON THIS SURVEY.
- REVIEW OF TITLE SEARCH WAS NOT PART OF THE SCOPE OF SERVICES.
- RIGHT-OF-WAY LINES AND MAPPED (ZONED) STREET LINES ARE AS PER CITY OF MIAMI ATLAS SHEET AND MIAMI-DADE COUNTY PLATS OF RECORD.
- POLE 343 LIES WITHIN THE JURISDICTION OF STATE OF FLORIDA.
- INFORMATION REGARDING STREET JURISDICTION WAS TAKEN FROM MAP ENTITLED : DOWNTOWN MIAMI STREETS BY JURISDICTION PREPARED BY CITY OF MIAMI DATED SEPTEMBER 1, 2015 AND FURNISHED BY THE CLIENT.

SURVEYOR'S CERTIFICATION :

I HEREBY CERTIFY THAT THIS SPECIFIC PURPOSE SURVEY WAS PREPARED UNDER MY DIRECT SUPERVISION AND THAT IT IS TRUE AND CORRECT TO THE BEST OF MY KNOWLEDGE AND BELIEF AND I FURTHER CERTIFY THAT SAID SURVEY IS IN COMPLIANCE WITH THE STANDARDS OF PRACTICE AS SET FORTH BY THE FLORIDA BOARD OF LAND SURVEYORS AND MAPPERS IN CHAPTER 5J-17 FLORIDA ADMINISTRATIVE CODE PURSUANT TO SECTION 472.027 OF THE FLORIDA STATUTES.

 MANUEL G. VERA JR.
 PROFESSIONAL SURVEYOR AND MAPPER No. 5291
 STATE OF FLORIDA
 NOTICE: NOT VALID WITHOUT THE SIGNATURE AND ORIGINAL RAISED SEAL OF THE FLORIDA LICENSED SURVEYOR AND MAPPER.
 EACH SHEET AS INCORPORATED HEREIN SHALL NOT BE CONSIDERED FULL, VALID AND COMPLETE UNLESS ATTACHED TO THE OTHERS.

FOR SKETCH SEE SHEET 2

MANUEL G.VERA AND ASSOCIATES, INC.
 ENGINEERS-SURVEYORS & MAPPERS
 13960 S.W. 47th ST. MIAMI, FLORIDA 33175 L.B. No.2439
 PHONE: (305) 221-6210 e-mail: mvera jr@mgvera.com

PROJECT NUMBER: 16-574		
TYPE OF PROJECT: SPECIFIC PURPOSE SURVEY		
PROJECT NAME: POLE LOCATION		
DATE: 07-01-2016	SCALE	SHEET
DRAWN BY: JCF	N.A.	1 OF 2

NOT A BOUNDARY SURVEY

**SPECIFIC PURPOSE SURVEY
PROPOSED POLE 343**

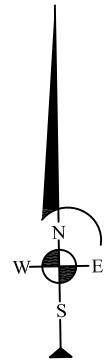

LEGEND:

- EXISTING RIGHT OF WAY LINE
- MAPPED (ZONED) STREET LINE
- CENTER LINE
- MONUMENT LINE

ABBREVIATIONS:

- SR - STATE ROAD
- US - UNITED STATE HIGHWAY

NOT A BOUNDARY SURVEY

MANUEL G.VERA AND ASSOCIATES, INC.
ENGINEERS-SURVEYORS & MAPPERS
 13960 S.W. 47th ST. MIAMI, FLORIDA 33175 L.B. No.2439
 PHONE: (305) 221-6210 e-mail: mverajr@mgvera.com

PROJECT NUMBER: 16-574		
TYPE OF PROJECT: SPECIFIC PURPOSE SURVEY		
PROJECT NAME: POLE LOCATION		
DATE: 07-01-2016	SCALE	SHEET
DRAWN BY: JCF	1"=30'	2 OF 2



LOCATION DESCRIPTION:

Biscayne Blvd S/O NE 8th St

FOR EXACT SIGN POST LOCATION
PLEASE REFER TO ATTACHED
SPECIFIC PURPOSE SURVEY SKETCH

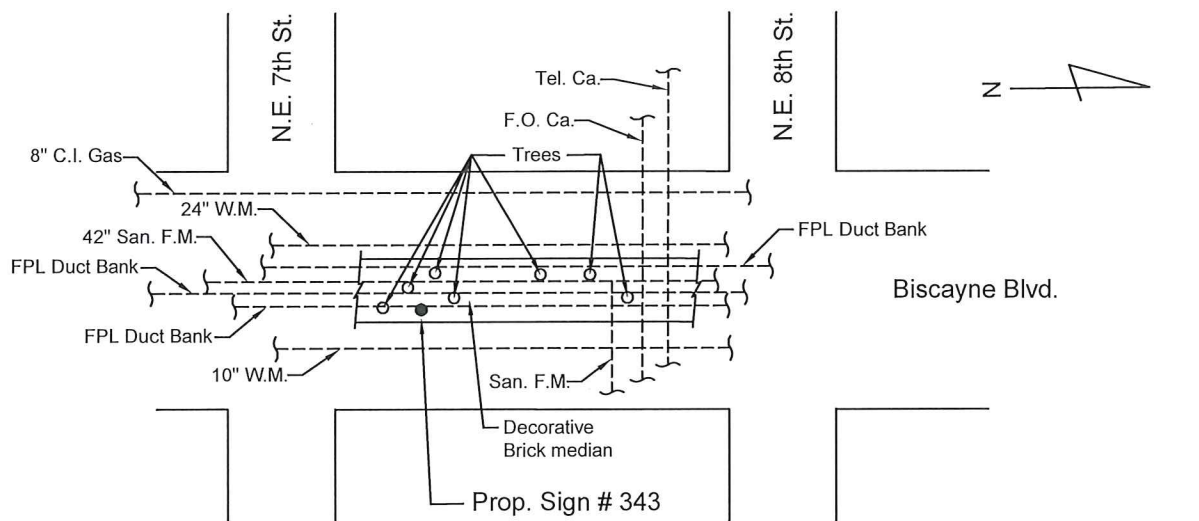

PLAN
NTS

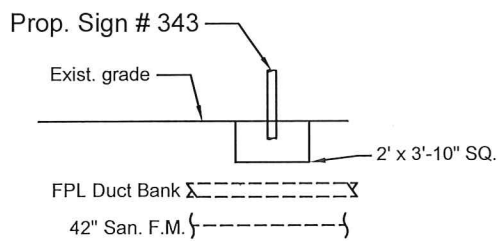

PROFILE
NTS

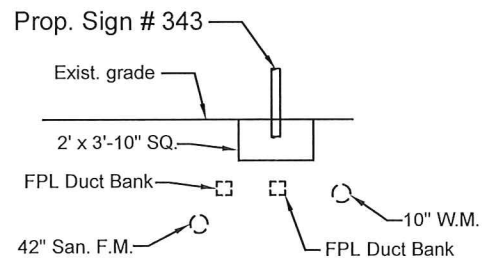

SECTION
(LOOKING NORTH)
NTS

COMMENTS: Best Footer for Prop. Sign # 343 is: 2' x 3'-10" SQ.

MIAMI DDA - WAYFINDING AND SIGNAGE SYSTEM PROGRAM

DISCLAIMER:

This sketch has been prepared for utility coordination purposes only. This sketch is Not for Construction.

Utility coordination done by:
JRA Inc.
engineers-planners
10661 N Kendall Dr., Ste. 206B
Miami, FL 33176-1550
Phone 305-270-7800
CA 7613

F. D. O. T.

SIGN No. 343

Type PARK.1A

DATE: 04-05-2017

Sign No.
348



Downtown
Miami Parking
Program

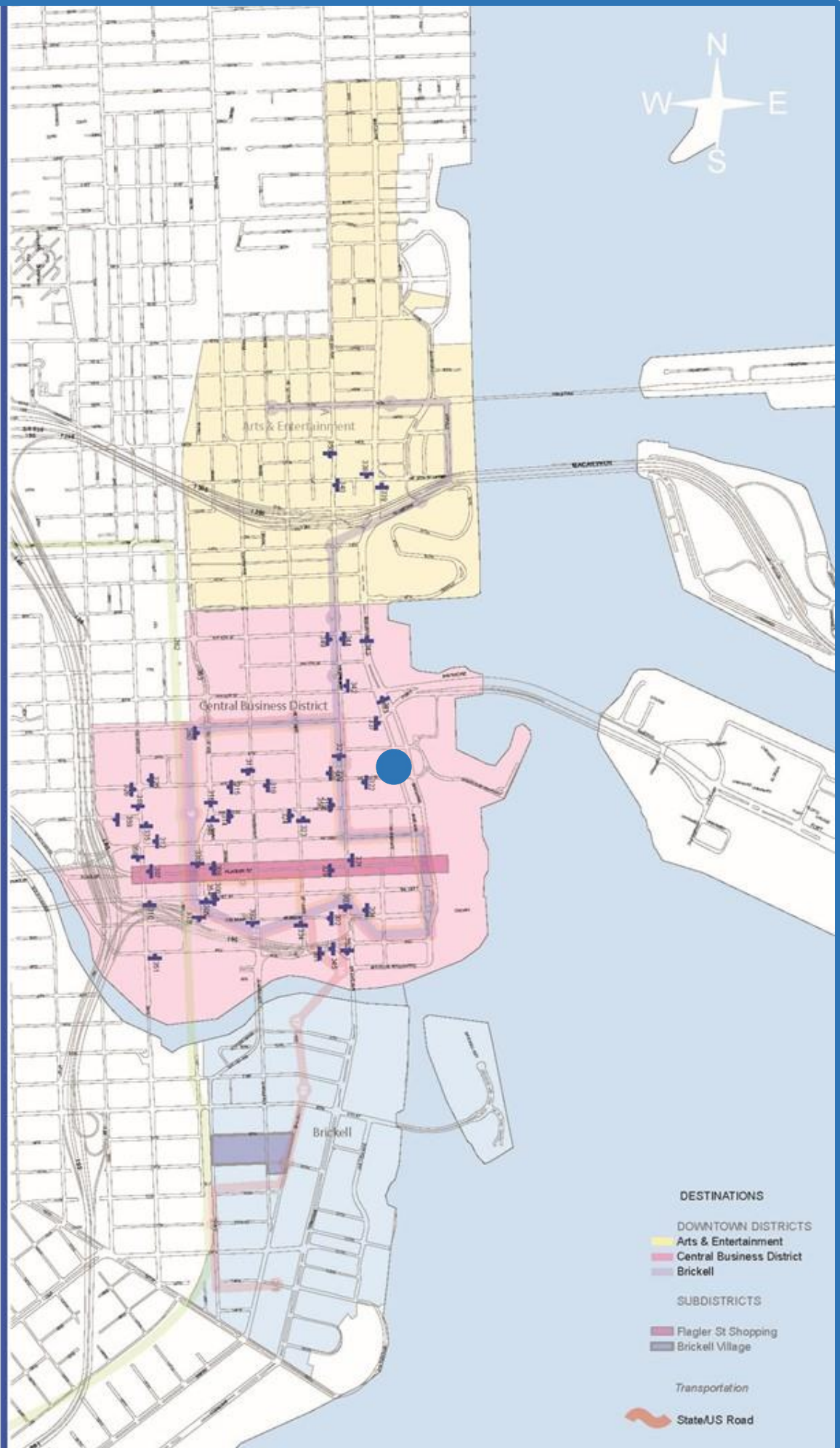

Wayfinding & Signage System Program

Downtown Miami, Florida

SIGN NO. 348

Location Aerial View:



Location Photo:

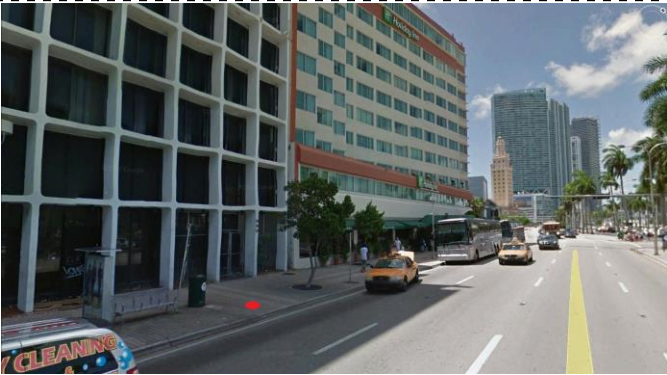

Reference Intersection: N Biscayne Blvd @ NE 3rd St

Detailed Location: Colocate with 151

Orientation: SB

Right-of-Way Summary	Utilities Summary
State of Florida	AT&T Water Main Sanitary Street Light F.O.

Sign Type: PARK.1A

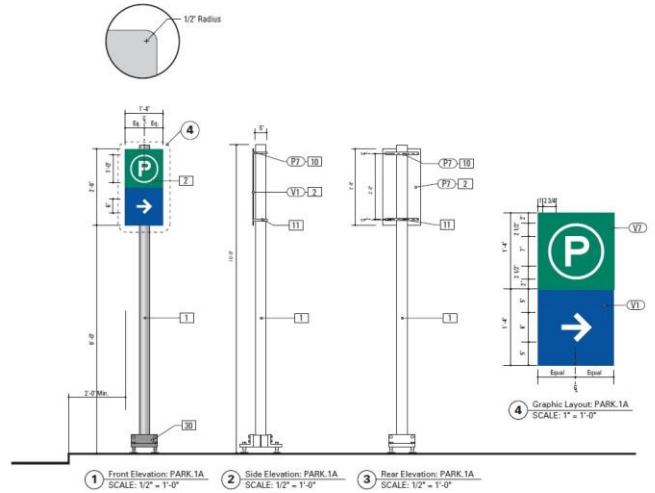

Sign Message:

Face A	P →
Face B	None

Ground Condition: Mounted

Foundation Type: 2' X 3' 10" Square

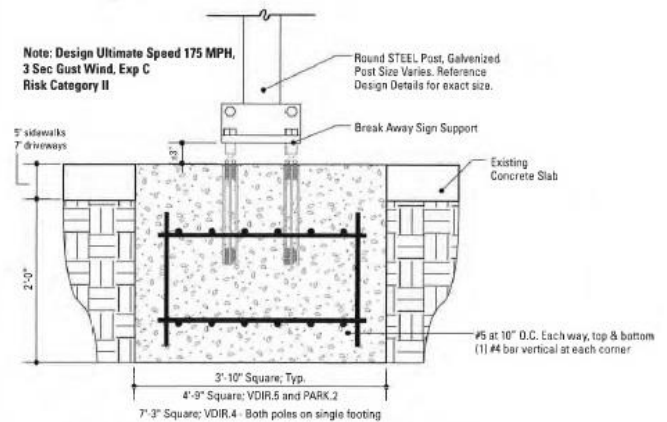

SPECIFIC PURPOSE SURVEY PROPOSED POLE 348

SURVEYOR'S REPORT :

- THE SPECIFIC PURPOSE OF THIS SURVEY IS TO SHOW THE LOCATION OF THE PROPOSED POLE IN RELATION TO THE MONUMENT LINES AND RIGHT-OF-WAY LINES.
- THIS IS NOT A BOUNDARY SURVEY
- THE LOCATION OF THE PROPOSED POLE SHOWN HEREON WAS PROVIDED BY THE CLIENT.
- THERE ARE EXISTING IMPROVEMENTS LYING WITHIN THE LIMITS OF THE SKETCH, WHICH ARE NOT SHOWN ON THIS SURVEY.
- REVIEW OF TITLE SEARCH WAS NOT PART OF THE SCOPE OF SERVICES.
- RIGHT-OF-WAY LINES AND MAPPED (ZONED) STREET LINES ARE AS PER CITY OF MIAMI ATLAS SHEET AND MIAMI-DADE COUNTY PLATS OF RECORD.
- POLES 348 LIES WITHIN THE JURISDICTION OF STATE OF FLORIDA.
- INFORMATION REGARDING STREET JURISDICTION WAS TAKEN FROM MAP ENTITLED : DOWNTOWN MIAMI STREETS BY JURISDICTION PREPARED BY CITY OF MIAMI DATED SEPTEMBER 1, 2015 AND FURNISHED BY THE CLIENT.

SURVEYOR'S CERTIFICATION :

I HEREBY CERTIFY THAT THIS SPECIFIC PURPOSE SURVEY WAS PREPARED UNDER MY DIRECT SUPERVISION AND THAT IT IS TRUE AND CORRECT TO THE BEST OF MY KNOWLEDGE AND BELIEF AND I FURTHER CERTIFY THAT SAID SURVEY IS IN COMPLIANCE WITH THE STANDARDS OF PRACTICE AS SET FORTH BY THE FLORIDA BOARD OF LAND SURVEYORS AND MAPPERS IN CHAPTER 5J-17 FLORIDA ADMINISTRATIVE CODE PURSUANT TO SECTION 472.027 OF THE FLORIDA STATUTES.

 MANUEL G. VERA JR.
 PROFESSIONAL SURVEYOR AND MAPPER No. 5291
 STATE OF FLORIDA
 NOTICE: NOT VALID WITHOUT THE SIGNATURE AND ORIGINAL RAISED SEAL OF THE FLORIDA LICENSED SURVEYOR AND MAPPER.
 EACH SHEET AS INCORPORATED HEREIN SHALL NOT BE CONSIDERED FULL, VALID AND COMPLETE UNLESS ATTACHED TO THE OTHERS.

FOR SKETCH SEE SHEET 2

MANUEL G.VERA AND ASSOCIATES, INC.
 ENGINEERS-SURVEYORS & MAPPERS
 13960 S.W. 47th ST. MIAMI, FLORIDA 33175 L.B. No.2439
 PHONE: (305) 221-6210 e-mail: mverajr@mgvera.com

PROJECT NUMBER: 16-574		
TYPE OF PROJECT: SPECIFIC PURPOSE SURVEY		
PROJECT NAME: POLE LOCATION		
DATE: 06-30-2016	SCALE	SHEET
DRAWN BY: JCF	N.A.	1 OF 2

NOT A BOUNDARY SURVEY

SPECIFIC PURPOSE SURVEY PROPOSED POLE 348



GRAPHIC SCALE IN FEET

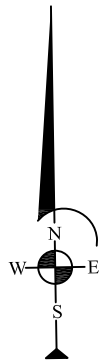

LEGEND:

- EXISTING RIGHT OF WAY LINE
- MAPPED (ZONED) STREET LINE
- ⊕ CENTER LINE
- M MONUMENT LINE

ABBREVIATIONS:

- SR - STATE ROAD
- US - UNITED STATE HIGHWAY

NOT A BOUNDARY SURVEY

MANUEL G.VERA AND ASSOCIATES, INC.
ENGINEERS-SURVEYORS & MAPPERS
 13960 S.W. 47th ST. MIAMI, FLORIDA 33175 L.B. No.2439
 PHONE: (305) 221-6210 e-mail: mverajr@mgvera.com

PROJECT NUMBER: 16-574		
TYPE OF PROJECT: SPECIFIC PURPOSE SURVEY		
PROJECT NAME: POLE LOCATION		
DATE: 06-30-2016	SCALE: 1"=30'	SHEET: 2 OF 2
DRAWN BY: JCF		



LOCATION DESCRIPTION:

Biscayne Blvd N/O NE 3rd St

FOR EXACT SIGN POST LOCATION
PLEASE REFER TO ATTACHED
SPECIFIC PURPOSE SURVEY SKETCH

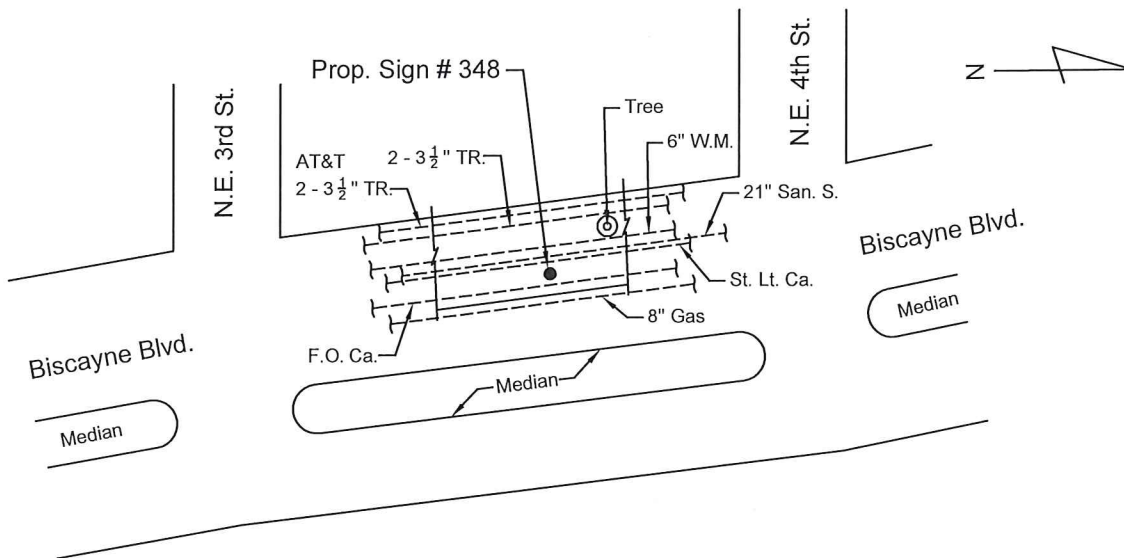

PLAN
NTS

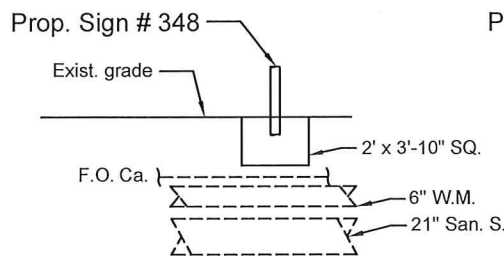

PROFILE
NTS

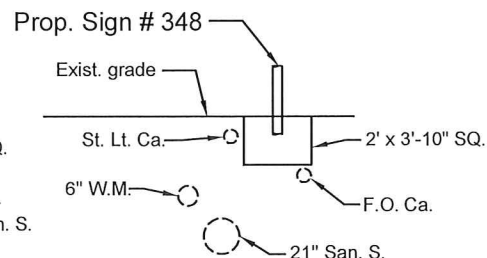

SECTION
(LOOKING NORTH)
NTS

COMMENTS: Best Footer for Prop. Sign # 348 is: 2' x 3'-10" SQ.

MIAMI DDA - WAYFINDING AND SIGNAGE SYSTEM PROGRAM

DISCLAIMER:

This sketch has been prepared for utility coordination purposes only. This sketch is Not for Construction.

Utility coordination done by:
JRA Inc.
engineers-planners
10661 N Kendall Dr., Ste. 206B
Miami, FL 33176-1550
Phone 305-270-7800
CA 7613

F. D. O. T.

SIGN No. 348

Type PARK.1A

DATE: 04-05-2017

Sign No.
352



Downtown
Miami Parking
Program

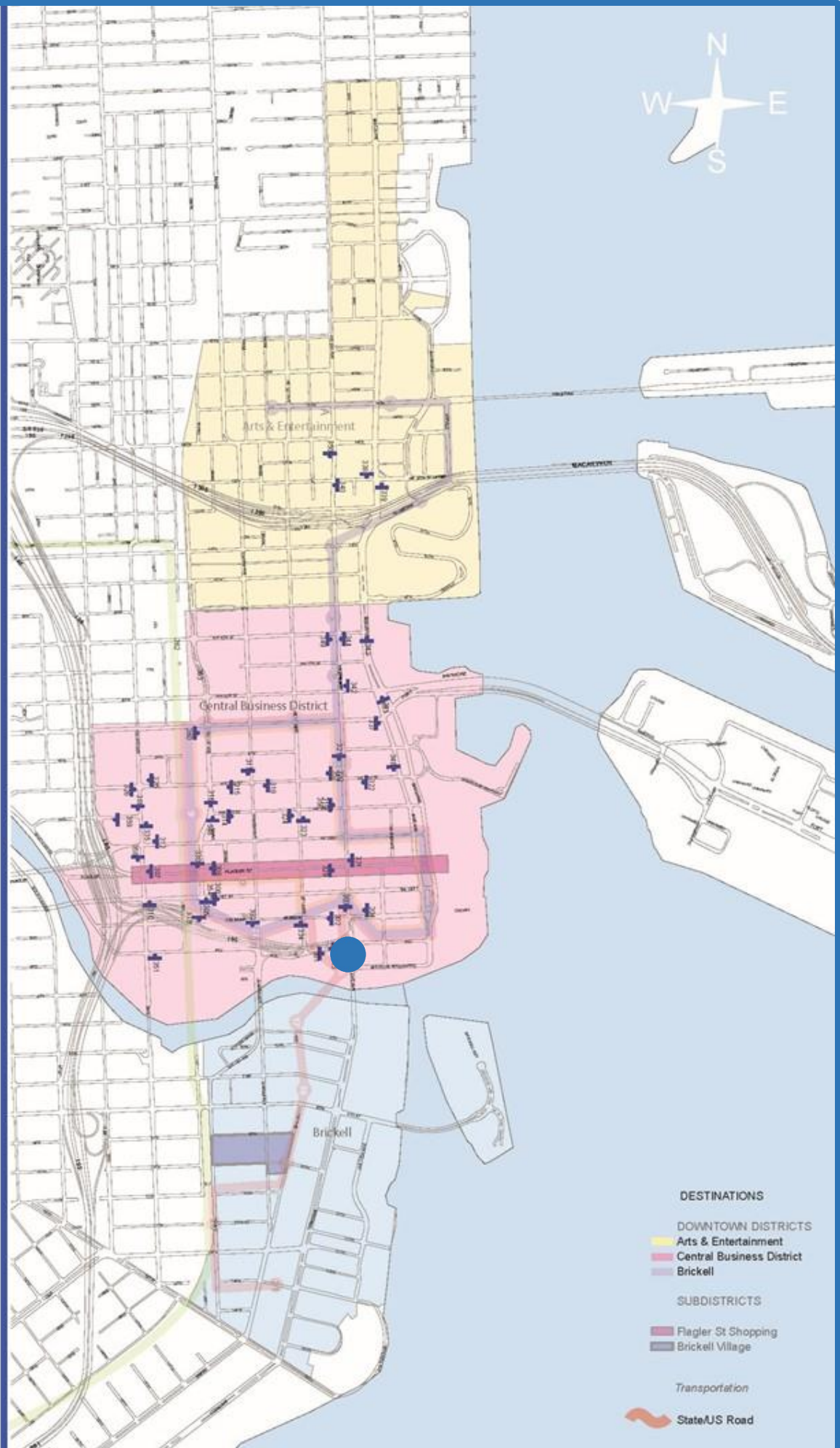

Wayfinding & Signage System Program

Downtown Miami, Florida

SIGN NO. 352

Location Aerial View:



Location Photo:



Reference Intersection: SE 2nd Ave south of SE 3rd St

Detailed Location: Replace existing sign - see photo

Orientation: SB

Right-of-Way Summary	Utilities Summary
State of Florida	FPL Duct Bank Gas Line

Sign Type: PARK.1A

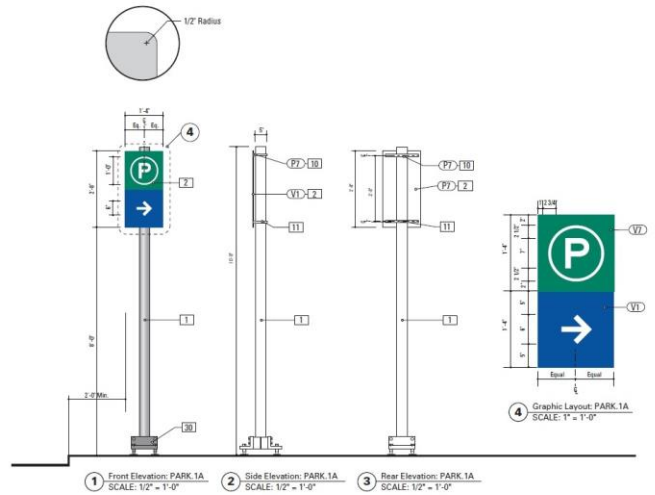

Sign Message:

Face A	P →
Face B	None

Ground Condition: Concrete

Foundation Type: 2' X 3' 10" Square

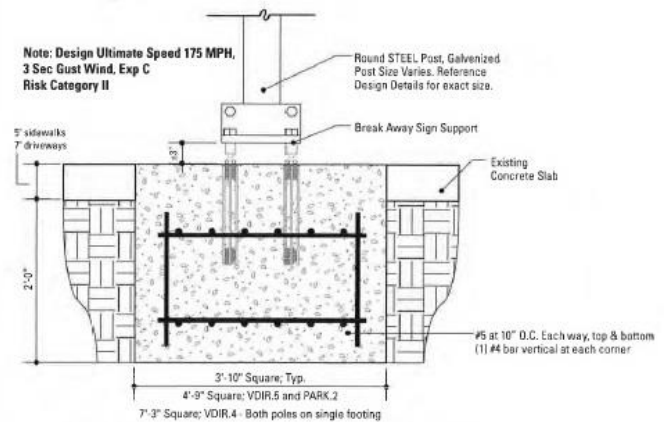

SPECIFIC PURPOSE SURVEY PROPOSED POLE 352

SURVEYOR'S REPORT :

- THE SPECIFIC PURPOSE OF THIS SURVEY IS TO SHOW THE LOCATION OF THE PROPOSED POLE IN RELATION TO THE MONUMENT LINES AND RIGHT-OF-WAY LINES.
- THIS IS NOT A BOUNDARY SURVEY
- THE LOCATION OF THE PROPOSED POLE SHOWN HEREON WAS PROVIDED BY THE CLIENT.
- THERE ARE EXISTING IMPROVEMENTS LYING WITHIN THE LIMITS OF THE SKETCH, WHICH ARE NOT SHOWN ON THIS SURVEY.
- REVIEW OF TITLE SEARCH WAS NOT PART OF THE SCOPE OF SERVICES.
- RIGHT-OF-WAY LINES AND MAPPED (ZONED) STREET LINES ARE AS PER CITY OF MIAMI ATLAS SHEET AND MIAMI-DADE COUNTY PLATS OF RECORD.
- POLE 352 LIES WITHIN THE JURISDICTION OF STATE OF FLORIDA.
- INFORMATION REGARDING STREET JURISDICTION WAS TAKEN FROM MAP ENTITLED : DOWNTOWN MIAMI STREETS BY JURISDICTION PREPARED BY CITY OF MIAMI DATED SEPTEMBER 1, 2015 AND FURNISHED BY THE CLIENT.

SURVEYOR'S CERTIFICATION :

I HEREBY CERTIFY THAT THIS SPECIFIC PURPOSE SURVEY WAS PREPARED UNDER MY DIRECT SUPERVISION AND THAT IT IS TRUE AND CORRECT TO THE BEST OF MY KNOWLEDGE AND BELIEF AND I FURTHER CERTIFY THAT SAID SURVEY IS IN COMPLIANCE WITH THE STANDARDS OF PRACTICE AS SET FORTH BY THE FLORIDA BOARD OF LAND SURVEYORS AND MAPPERS IN CHAPTER 5J-17 FLORIDA ADMINISTRATIVE CODE PURSUANT TO SECTION 472.027 OF THE FLORIDA STATUTES.

MANUEL G. VERA JR.
 PROFESSIONAL SURVEYOR AND MAPPER No. 5291
 STATE OF FLORIDA

NOTICE: NOT VALID WITHOUT THE SIGNATURE AND ORIGINAL RAISED SEAL OF THE FLORIDA LICENSED SURVEYOR AND MAPPER.
 EACH SHEET AS INCORPORATED HEREIN SHALL NOT BE CONSIDERED FULL, VALID AND COMPLETE UNLESS ATTACHED TO THE OTHERS.

FOR SKETCH SEE SHEET 2

MANUEL G.VERA AND ASSOCIATES, INC.
 ENGINEERS-SURVEYORS & MAPPERS
 13960 S.W. 47th ST. MIAMI, FLORIDA 33175 L.B. No.2439
 PHONE: (305) 221-6210 e-mail: mverajr@mgvera.com

PROJECT NUMBER: 16-574		
TYPE OF PROJECT: SPECIFIC PURPOSE SURVEY		
PROJECT NAME: POLE LOCATION		
DATE: 03-29-17	SCALE	SHEET
DRAWN BY: JCF	N.A.	1 OF 2

NOT A BOUNDARY SURVEY

SPECIFIC PURPOSE SURVEY PROPOSED POLE 352

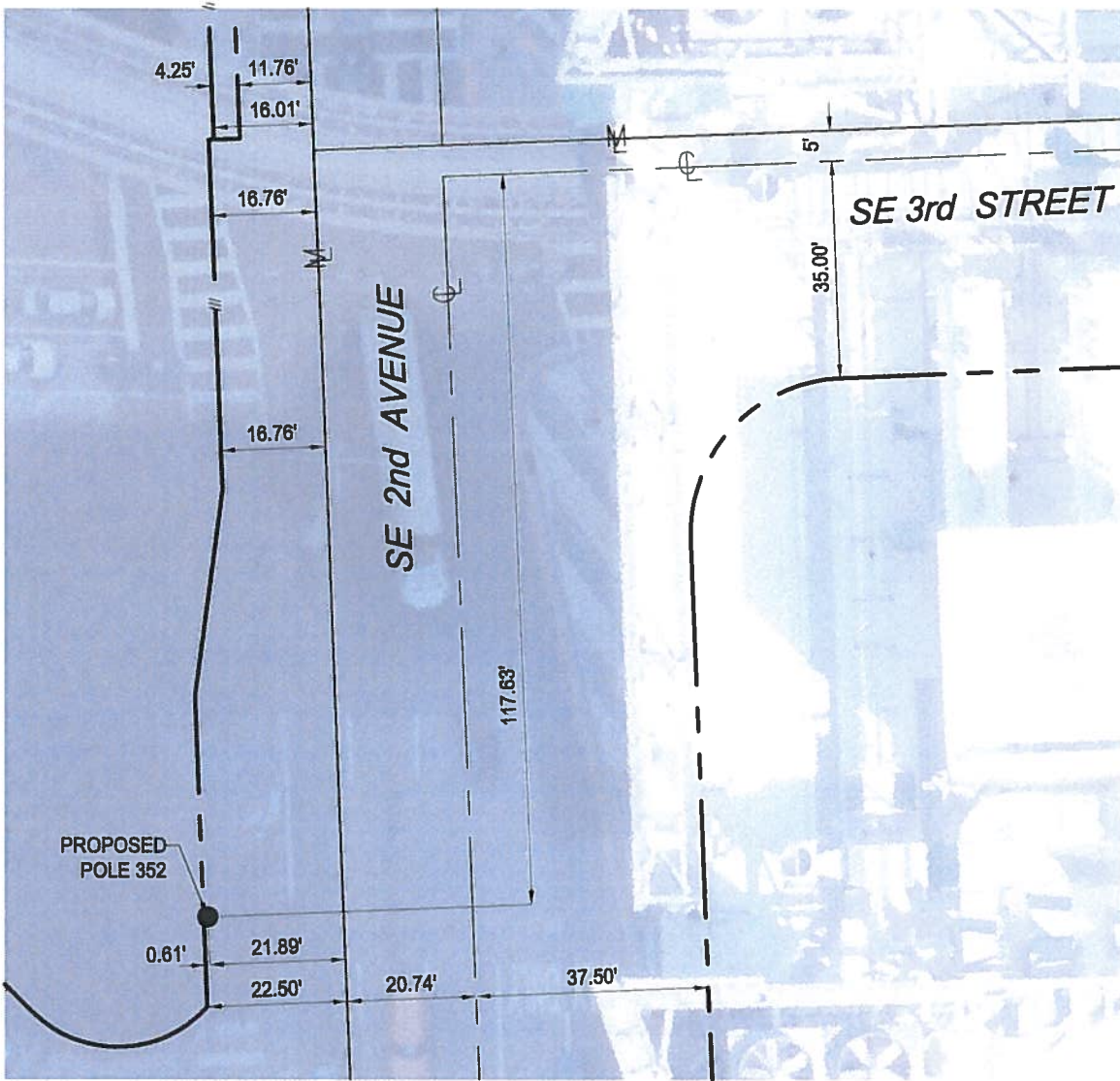
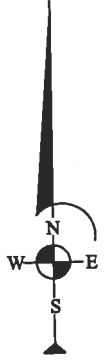

LEGEND:

- EXISTING RIGHT OF WAY LINE
- EXISTING LIMITED ACCESS RIGHT OF WAY LINE
- - - MAPPED (ZONED) STREET LINE
- ⊕ CENTER LINE
- M MONUMENT LINE

PROJECT NUMBER: 16-574		
TYPE OF PROJECT: SPECIFIC PURPOSE SURVEY		
PROJECT NAME: POLE LOCATION		
DATE: 03-29-17	SCALE: 1"=30'	SHEET: 2 OF 2
DRAWN BY: JCF		

MANUEL G.VERA AND ASSOCIATES, INC.
ENGINEERS-SURVEYORS & MAPPERS
 13960 S.W. 47th ST. MIAMI, FLORIDA 33175 L.B. No.2439
 PHONE: (305) 221-6210 e-mail: mverajr@mgvera.com

NOT A BOUNDARY SURVEY

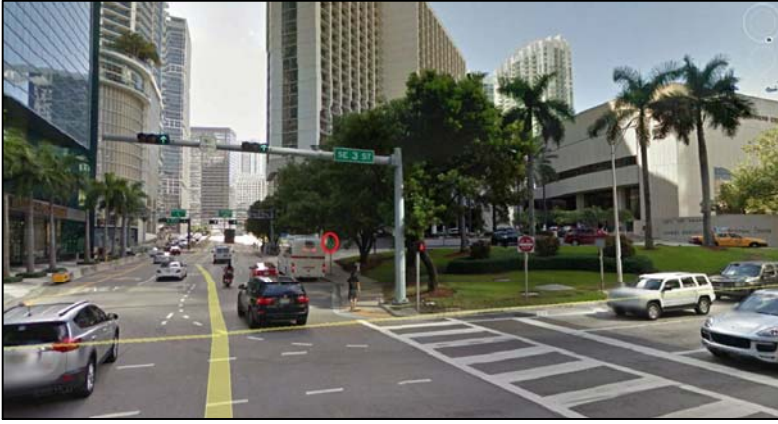

LOCATION DESCRIPTION:

SE 2nd Ave S/O SE 3rd St

FOR EXACT SIGN POST LOCATION
PLEASE REFER TO ATTACHED
SPECIFIC PURPOSE SURVEY SKETCH

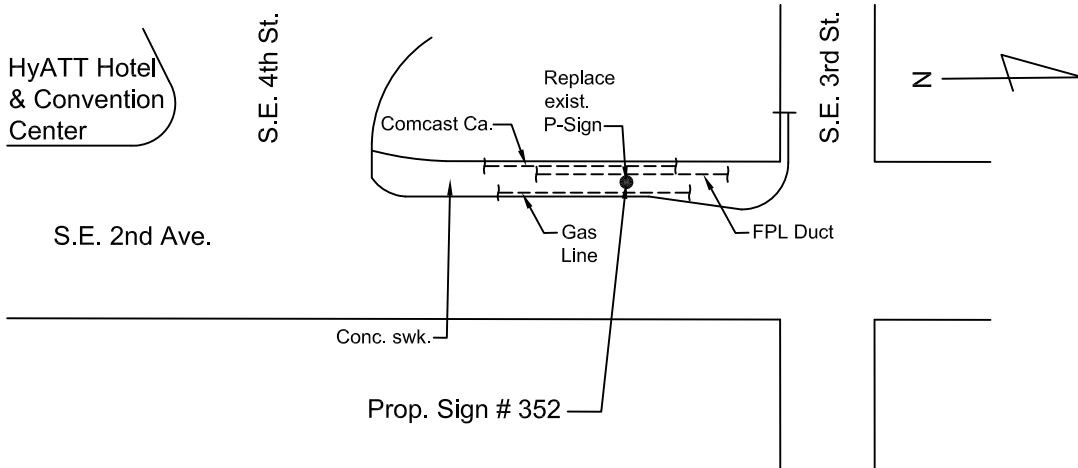

PLAN
NTS

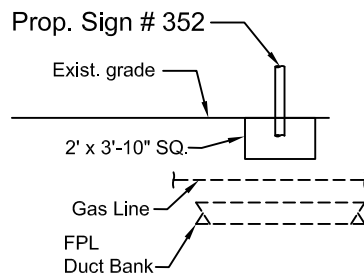

PROFILE
NTS

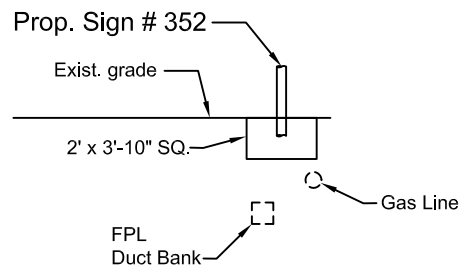

SECTION
(LOOKING NORTH)
NTS

COMMENTS: Best Footer for Prop. Sign # 352 is: 2' x 3'-10" SQ.

MIAMI DDA - WAYFINDING AND SIGNAGE SYSTEM PROGRAM

DISCLAIMER:
This sketch has been prepared
for utility coordination purposes only.
This sketch is Not for Construction.

Utility coordination done by:
JRA Inc.
engineers-planners
10661 N Kendall Dr., Ste. 206B
Miami, FL 33176-1550
Phone 305-270-7800
CA 7613

F. D. O. T.

SIGN No. 352

Type PARK.1A