

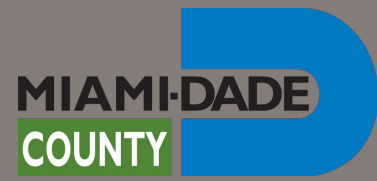

Wayfinding & Signage System Program

Downtown Miami, FL



- DESTINATIONS
- DOWNTOWN DISTRICTS
 - Arts & Entertainment
 - Central Business District
 - Brickell
- SUBDISTRICTS
 - Flagler St Shopping
 - Brickell Village
- Transportation
 - State/US Road

Downtown Miami District ID Program

Sign No.
605A



**Downtown
Miami District
ID Program**



Wayfinding & Signage System Program

Downtown Miami, Florida

SIGN NO. 605

Location Aerial View:



Location Photo:

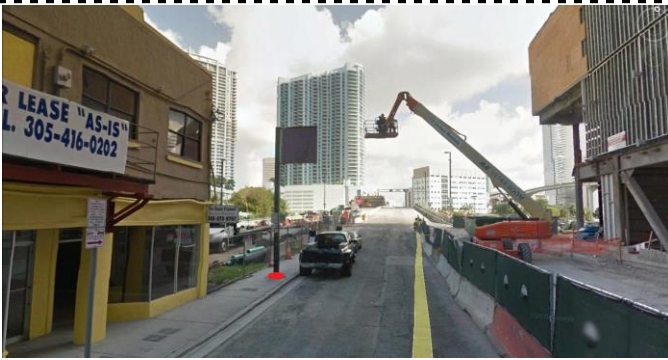

Reference Intersection: S Miami Ave @ S 5th St

Detailed Location: Replace existing district sign

Orientation: NB

Right-of-Way Summary	Utilities Summary
Miami-Dade County	Electric Cable Water Service Water Main

Sign Type: DistID.3

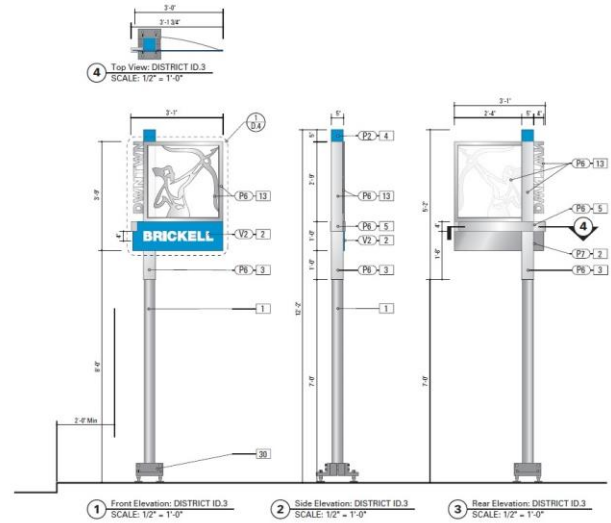

Sign Message:

Face A	Central Business District
Face B	None

Ground Condition: Concrete

Foundation Type: 5' 6" X 3' Diameter

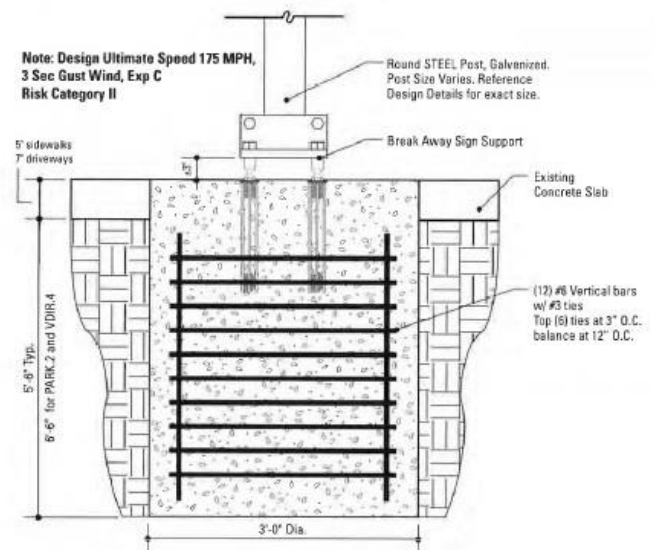

SPECIFIC PURPOSE SURVEY PROPOSED POLE 605

SURVEYOR'S REPORT :

- THE SPECIFIC PURPOSE OF THIS SURVEY IS TO SHOW THE LOCATION OF THE PROPOSED POLE IN RELATION TO THE MONUMENT LINES AND RIGHT-OF-WAY LINES.
- THIS IS NOT A BOUNDARY SURVEY
- THE LOCATION OF THE PROPOSED POLE SHOWN HEREON WAS PROVIDED BY THE CLIENT.
- THERE ARE EXISTING IMPROVEMENTS LYING WITHIN THE LIMITS OF THE SKETCH, WHICH ARE NOT SHOWN ON THIS SURVEY.
- REVIEW OF TITLE SEARCH WAS NOT PART OF THE SCOPE OF SERVICES.
- RIGHT-OF-WAY LINES AND MAPPED (ZONED) STREET LINES ARE AS PER CITY OF MIAMI ATLAS SHEET AND MIAMI-DADE COUNTY PLATS OF RECORD.
- POLE 605 LIES WITHIN THE JURISDICTION OF MIAMI DADE COUNTY.
- INFORMATION REGARDING STREET JURISDICTION WAS TAKEN FROM MAP ENTITLED : DOWNTOWN MIAMI STREETS BY JURISDICTION PREPARED BY CITY OF MIAMI DATED SEPTEMBER 1, 2015 AND FURNISHED BY THE CLIENT.

SURVEYOR'S CERTIFICATION :

I HEREBY CERTIFY THAT THIS SPECIFIC PURPOSE SURVEY WAS PREPARED UNDER MY DIRECT SUPERVISION AND THAT IT IS TRUE AND CORRECT TO THE BEST OF MY KNOWLEDGE AND BELIEF AND I FURTHER CERTIFY THAT SAID SURVEY IS IN COMPLIANCE WITH THE STANDARDS OF PRACTICE AS SET FORTH BY THE FLORIDA BOARD OF LAND SURVEYORS AND MAPPERS IN CHAPTER 5J-17 FLORIDA ADMINISTRATIVE CODE PURSUANT TO SECTION 472.027 OF THE FLORIDA STATUTES.

 MANUEL G. VERA JR.
 PROFESSIONAL SURVEYOR AND MAPPER No. 5291
 STATE OF FLORIDA
 NOTICE: NOT VALID WITHOUT THE SIGNATURE AND ORIGINAL RAISED SEAL OF THE FLORIDA LICENSED SURVEYOR AND MAPPER.
 EACH SHEET AS INCORPORATED HEREIN SHALL NOT BE CONSIDERED FULL, VALID AND COMPLETE UNLESS ATTACHED TO THE OTHERS.

FOR SKETCH SEE SHEET 2

MANUEL G.VERA AND ASSOCIATES, INC.
 ENGINEERS-SURVEYORS & MAPPERS
 13960 S.W. 47th ST. MIAMI, FLORIDA 33175 L.B. No.2439
 PHONE: (305) 221-6210 e-mail: mverajr@mgvera.com

PROJECT NUMBER: 16-574		
TYPE OF PROJECT: SPECIFIC PURPOSE SURVEY		
PROJECT NAME: POLE LOCATION		
DATE: 07-27-2016	SCALE	SHEET
DRAWN BY: JCF	N.A.	1 OF 2

NOT A BOUNDARY SURVEY

SPECIFIC PURPOSE SURVEY PROPOSED POLE 605

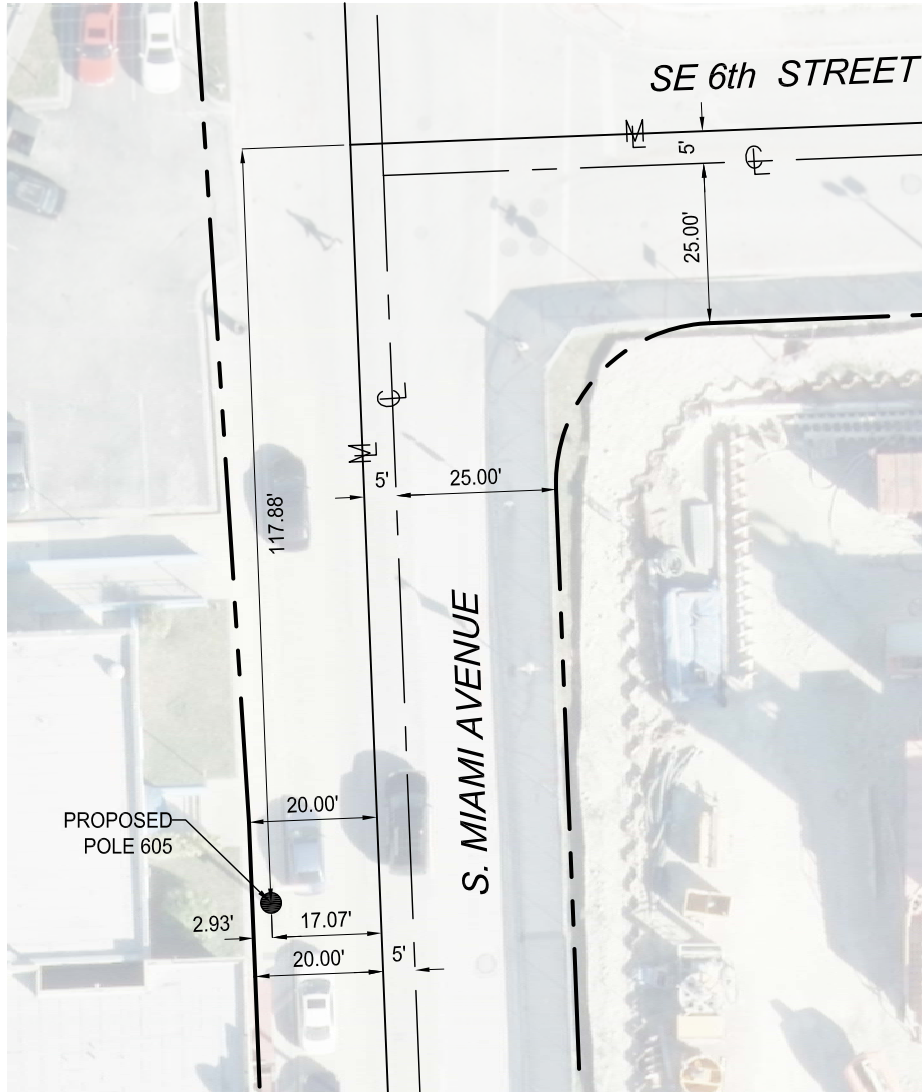
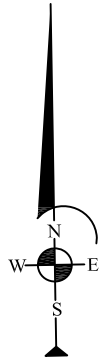

LEGEND:

- EXISTING RIGHT OF WAY LINE
- EXISTING LIMITED ACCESS RIGHT OF WAY LINE
- MAPPED (ZONED) STREET LINE
- CENTER LINE
- MONUMENT LINE

MANUEL G.VERA AND ASSOCIATES, INC.
 ENGINEERS-SURVEYORS & MAPPERS
 13960 S.W. 47th ST. MIAMI, FLORIDA 33175 L.B. No.2439
 PHONE: (305) 221-6210 e-mail: mverajr@mgvera.com

NOT A BOUNDARY SURVEY

PROJECT NUMBER: 16-574		
TYPE OF PROJECT: SPECIFIC PURPOSE SURVEY		
PROJECT NAME: POLE LOCATION		
DATE: 07-27-2016	SCALE: 1"=30'	SHEET: 2 OF 2
DRAWN BY: JCF		



LOCATION DESCRIPTION:

S Miami Ave S/O SE 6th St.

FOR EXACT SIGN POST LOCATION
PLEASE REFER TO ATTACHED
SPECIFIC PURPOSE SURVEY SKETCH

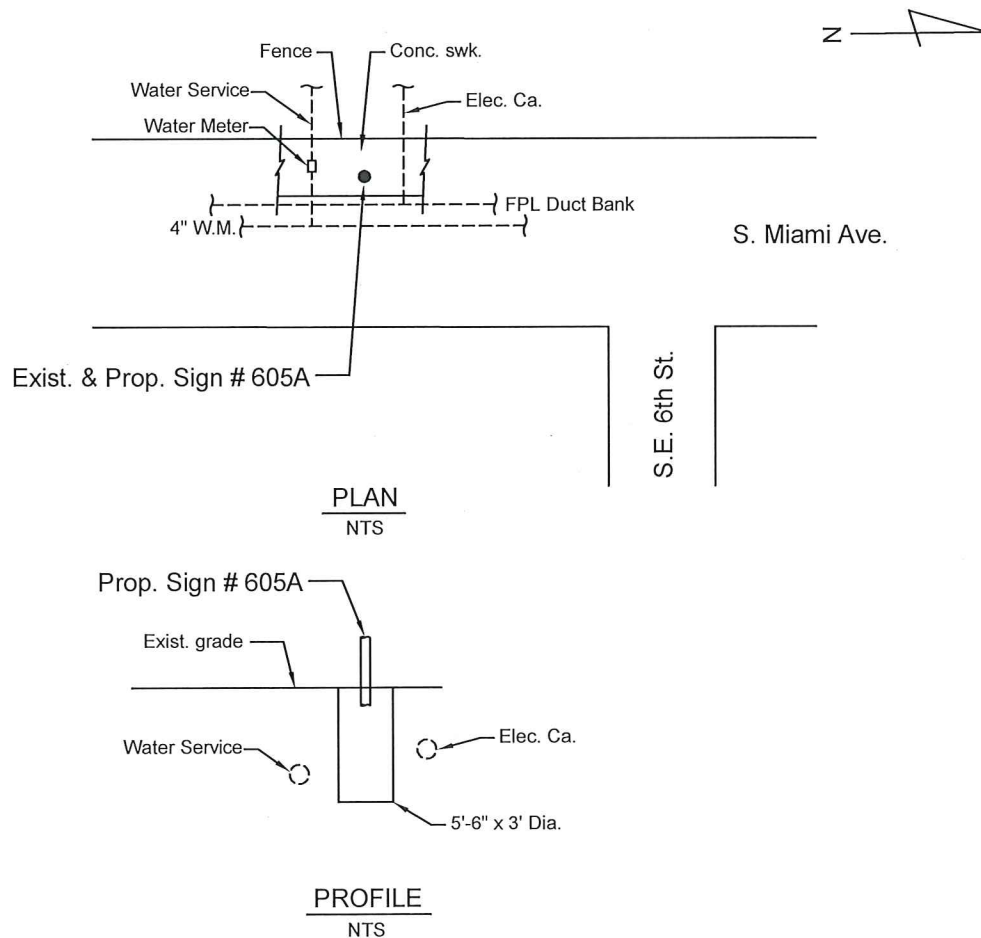

COMMENTS: Best Footer For Prop. Sign # 605A is: 5'-6" x 3' Dia.

MIAMI DDA - WAYFINDING AND SIGNAGE SYSTEM PROGRAM

DISCLAIMER:

This sketch has been prepared for utility coordination purposes only. This sketch is Not for Construction.

Utility coordination done by:
JRA Inc.
engineers-planners
10661 N Kendall Dr., Ste. 206B
Miami, FL 33176-1550
Phone 305-270-7800
CA 7613

MIAMI-DADE COUNTY

SIGN No. 605A

Type Dist - ID.3

DATE: 04-10-2017

Sign No.
605B



**Downtown
Miami District
ID Program**



Wayfinding & Signage System Program

Downtown Miami, Florida

SIGN NO. 605B

Location Aerial View:



Location Photo:



Reference Intersection: S Miami Ave @ S 4th St

Detailed Location: 4' in advance of planter in photo

Orientation: NB

Right-of-Way Summary	Utilities Summary
Miami-Dade County	Gas Main Water Service FPL Duct Banks AT&T Buried Cable

Sign Type: DistID.3

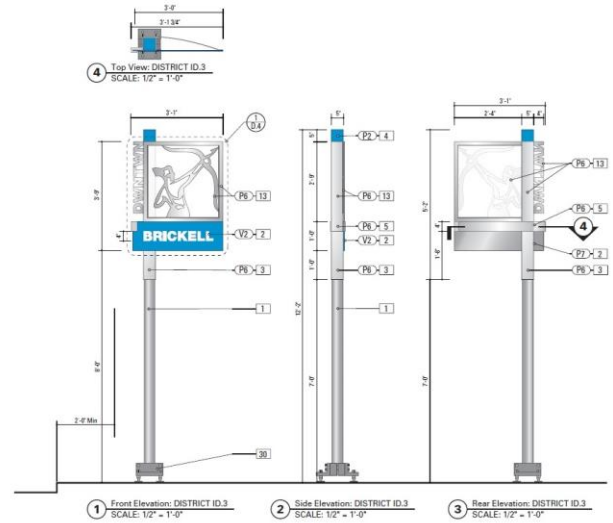

Sign Message:

Face A	Central Business District
Face B	None

Ground Condition: Grass

Foundation Type: 2' X 3' 10" Square

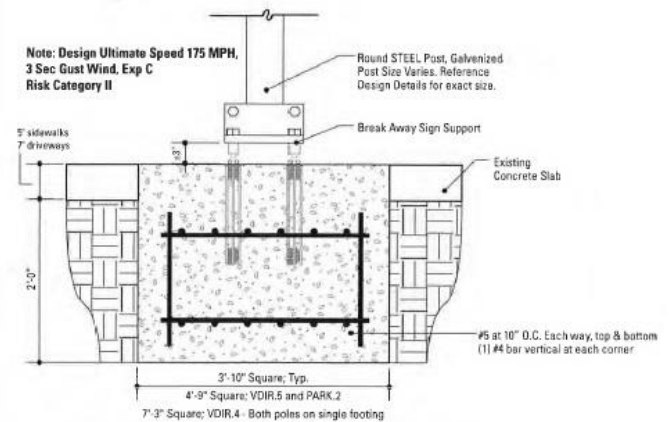

SPECIFIC PURPOSE SURVEY PROPOSED POLE 605B

SURVEYOR'S REPORT :

- THE SPECIFIC PURPOSE OF THIS SURVEY IS TO SHOW THE LOCATION OF THE PROPOSED POLE IN RELATION TO THE MONUMENT LINES AND RIGHT-OF-WAY LINES.

- THIS IS NOT A BOUNDARY SURVEY

- THE LOCATION OF THE PROPOSED POLE SHOWN HEREON WAS PROVIDED BY THE CLIENT.

- THERE ARE EXISTING IMPROVEMENTS LYING WITHIN THE LIMITS OF THE SKETCH, WHICH ARE NOT SHOWN ON THIS SURVEY.

- REVIEW OF TITLE SEARCH WAS NOT PART OF THE SCOPE OF SERVICES.

- RIGHT-OF-WAY LINES AND MAPPED (ZONED) STREET LINES ARE AS PER CITY OF MIAMI ATLAS SHEET AND MIAMI-DADE COUNTY PLATS OF RECORD.

- POLE 605B LIES WITHIN THE JURISDICTION OF MIAMI DADE COUNTY.

- INFORMATION REGARDING STREET JURISDICTION WAS TAKEN FROM MAP ENTITLED : DOWNTOWN MIAMI STREETS BY JURISDICTION PREPARED BY CITY OF MIAMI DATED SEPTEMBER 1, 2015 AND FURNISHED BY THE CLIENT.

SURVEYOR'S CERTIFICATION :

I HEREBY CERTIFY THAT THIS SPECIFIC PURPOSE SURVEY WAS PREPARED UNDER MY DIRECT SUPERVISION AND THAT IT IS TRUE AND CORRECT TO THE BEST OF MY KNOWLEDGE AND BELIEF AND I FURTHER CERTIFY THAT SAID SURVEY IS IN COMPLIANCE WITH THE STANDARDS OF PRACTICE AS SET FORTH BY THE FLORIDA BOARD OF LAND SURVEYORS AND MAPPERS IN CHAPTER 5J-17 FLORIDA ADMINISTRATIVE CODE PURSUANT TO SECTION 472.027 OF THE FLORIDA STATUTES.

MANUEL G. VERA JR.
PROFESSIONAL SURVEYOR AND MAPPER No. 5291
STATE OF FLORIDA
NOTICE: NOT VALID WITHOUT THE SIGNATURE AND ORIGINAL RAISED SEAL OF THE FLORIDA LICENSED SURVEYOR AND MAPPER.
EACH SHEET AS INCORPORATED HEREIN SHALL NOT BE CONSIDERED FULL, VALID AND COMPLETE UNLESS ATTACHED TO THE OTHERS.

FOR SKETCH SEE SHEET 2

MANUEL G.VERA AND ASSOCIATES, INC.
ENGINEERS-SURVEYORS & MAPPERS
13960 S.W. 47th ST. MIAMI, FLORIDA 33175 L.B. No.2439
PHONE: (305) 221-6210 e-mail: mvera jr@mgvera.com

PROJECT NUMBER: 16-574		
TYPE OF PROJECT: SPECIFIC PURPOSE SURVEY		
PROJECT NAME: POLE LOCATION		
DATE: 08-3-2016	SCALE	SHEET
DRAWN BY: JCF	N.A.	1 OF 2

NOT A BOUNDARY SURVEY

SPECIFIC PURPOSE SURVEY PROPOSED POLE 605B

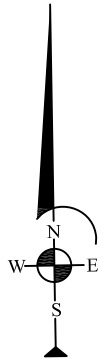
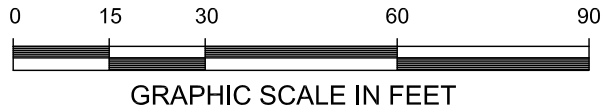

LEGEND:

- EXISTING RIGHT OF WAY LINE
- - - MAPPED (ZONED) STREET LINE
- CL CENTER LINE
- M MONUMENT LINE

Z:\DESIGN 2016\16574_OF_City of Miami_Pole Locations\ACAD SKETCH\16 574 POLE 605B.dwg

NOT A BOUNDARY SURVEY

MANUEL G.VERA AND ASSOCIATES, INC.
 ENGINEERS-SURVEYORS & MAPPERS
 13960 S.W. 47th ST. MIAMI, FLORIDA 33175 L.B. No.2439
 PHONE: (305) 221-6210 e-mail: mverajr@mgvera.com

PROJECT NUMBER: 16-574		
TYPE OF PROJECT: SPECIFIC PURPOSE SURVEY		
PROJECT NAME: POLE LOCATION		
DATE: 08-3-2016	SCALE	SHEET
DRAWN BY: JCF	1"=30'	2 OF 2



LOCATION DESCRIPTION:

S Miami Ave S/O SE 3rd St.

FOR EXACT SIGN POST LOCATION
PLEASE REFER TO ATTACHED
SPECIFIC PURPOSE SURVEY SKETCH

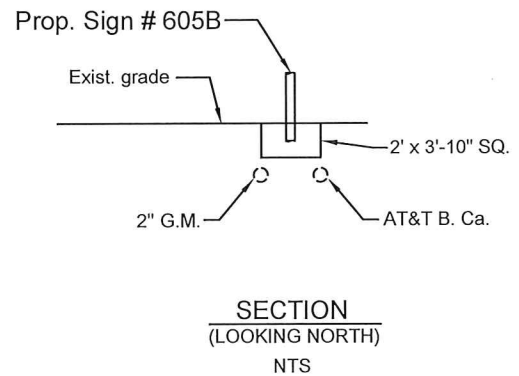
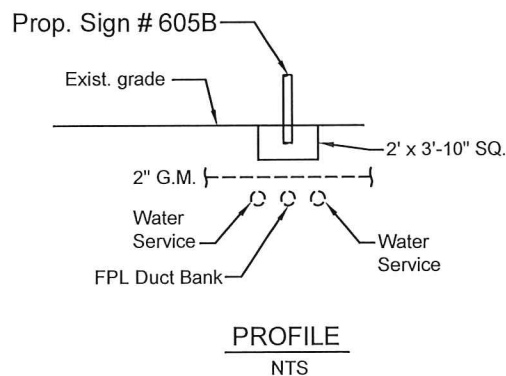
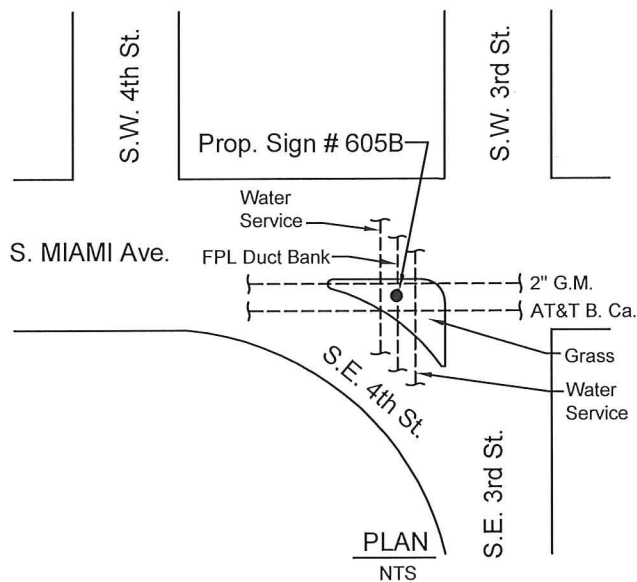

COMMENTS: Best Footer for Prop. Sign # 605B is: 2' x 3'-10" SQ.

MIAMI DDA - WAYFINDING AND SIGNAGE SYSTEM PROGRAM

DISCLAIMER:

This sketch has been prepared
for utility coordination purposes only.
This sketch is Not for Construction.

Utility coordination done by:
JRA Inc.
engineers-planners
10661 N Kendall Dr., Ste. 206B
Miami, FL 33176-1550
Phone 305-270-7800
CA 7613

MIAMI-DADE COUNTY

SIGN No. 605B

Type Dist - ID.3

DATE: 04-10-2017

Sign No.
609



**Downtown
Miami District
ID Program**



Wayfinding & Signage System Program

Downtown Miami, Florida

SIGN NO. 609

Location Aerial View:



Location Photo:



Reference Intersection: NE 2nd Ave @ NE 1st St

Detailed Location: 40' north of signal pole

Orientation: NB

Right-of-Way Summary	Utilities Summary
Miami-Dade County	FPL Fibernet FO Cable

Sign Type: DistID.3

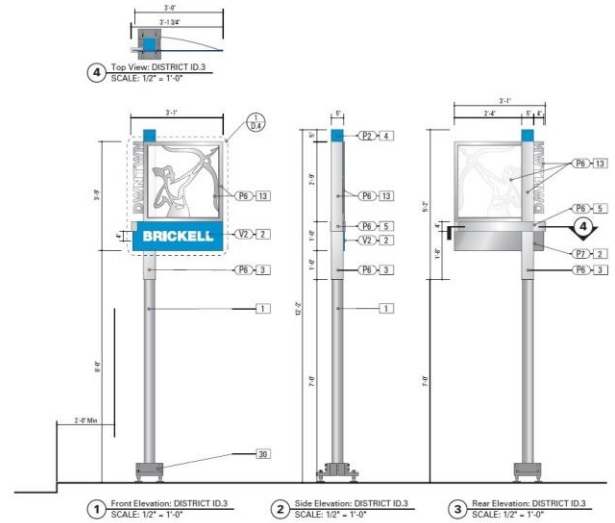

Sign Message:

Face A	Arts & Entertainment
Face B	None

Ground Condition: Concrete

Foundation Type: 5' 6" X 3' Diameter

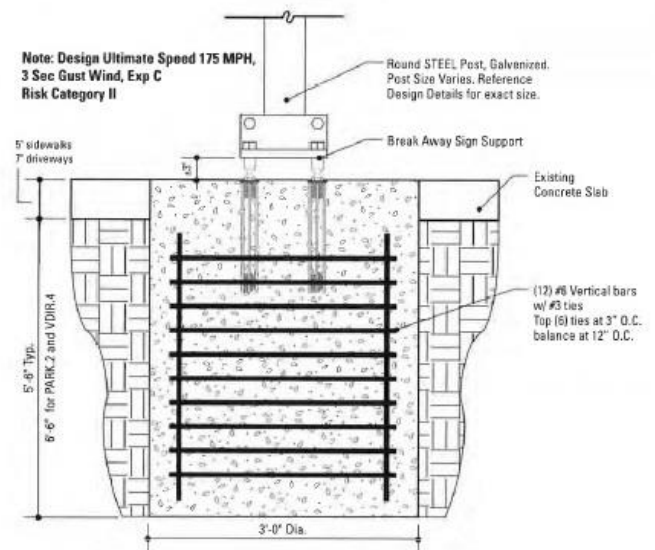

SPECIFIC PURPOSE SURVEY PROPOSED POLE 609

SURVEYOR'S REPORT :

- THE SPECIFIC PURPOSE OF THIS SURVEY IS TO SHOW THE LOCATION OF THE PROPOSED POLE IN RELATION TO THE MONUMENT LINES AND RIGHT-OF-WAY LINES.
- THIS IS NOT A BOUNDARY SURVEY
- THE LOCATION OF THE PROPOSED POLE SHOWN HEREON WAS PROVIDED BY THE CLIENT.
- THERE ARE EXISTING IMPROVEMENTS LYING WITHIN THE LIMITS OF THE SKETCH, WHICH ARE NOT SHOWN ON THIS SURVEY.
- REVIEW OF TITLE SEARCH WAS NOT PART OF THE SCOPE OF SERVICES.
- RIGHT-OF-WAY LINES AND MAPPED (ZONED) STREET LINES ARE AS PER CITY OF MIAMI ATLAS SHEET AND MIAMI-DADE COUNTY PLATS OF RECORD.
- POLE 609 LIES WITHIN THE JURISDICTION OF MIAMI DADE COUNTY.
- INFORMATION REGARDING STREET JURISDICTION WAS TAKEN FROM MAP ENTITLED : DOWNTOWN MIAMI STREETS BY JURISDICTION PREPARED BY CITY OF MIAMI DATED SEPTEMBER 1, 2015 AND FURNISHED BY THE CLIENT.

SURVEYOR'S CERTIFICATION :

I HEREBY CERTIFY THAT THIS SPECIFIC PURPOSE SURVEY WAS PREPARED UNDER MY DIRECT SUPERVISION AND THAT IT IS TRUE AND CORRECT TO THE BEST OF MY KNOWLEDGE AND BELIEF AND I FURTHER CERTIFY THAT SAID SURVEY IS IN COMPLIANCE WITH THE STANDARDS OF PRACTICE AS SET FORTH BY THE FLORIDA BOARD OF LAND SURVEYORS AND MAPPERS IN CHAPTER 5J-17 FLORIDA ADMINISTRATIVE CODE PURSUANT TO SECTION 472.027 OF THE FLORIDA STATUTES.

 MANUEL G. VERA JR.
 PROFESSIONAL SURVEYOR AND MAPPER No. 5291
 STATE OF FLORIDA
 NOTICE: NOT VALID WITHOUT THE SIGNATURE AND ORIGINAL RAISED SEAL OF THE FLORIDA LICENSED SURVEYOR AND MAPPER.
 EACH SHEET AS INCORPORATED HEREIN SHALL NOT BE CONSIDERED FULL, VALID AND COMPLETE UNLESS ATTACHED TO THE OTHERS.

FOR SKETCH SEE SHEET 2

MANUEL G.VERA AND ASSOCIATES, INC.
 ENGINEERS-SURVEYORS & MAPPERS
 13960 S.W. 47th ST. MIAMI, FLORIDA 33175 L.B. No.2439
 PHONE: (305) 221-6210 e-mail: mvera jr@mgvera.com

PROJECT NUMBER: 16-574		
TYPE OF PROJECT: SPECIFIC PURPOSE SURVEY		
PROJECT NAME: POLE LOCATION		
DATE: 07-11-2016	SCALE	SHEET
DRAWN BY: JCF	N.A.	1 OF 2

NOT A BOUNDARY SURVEY

SPECIFIC PURPOSE SURVEY PROPOSED POLE 609

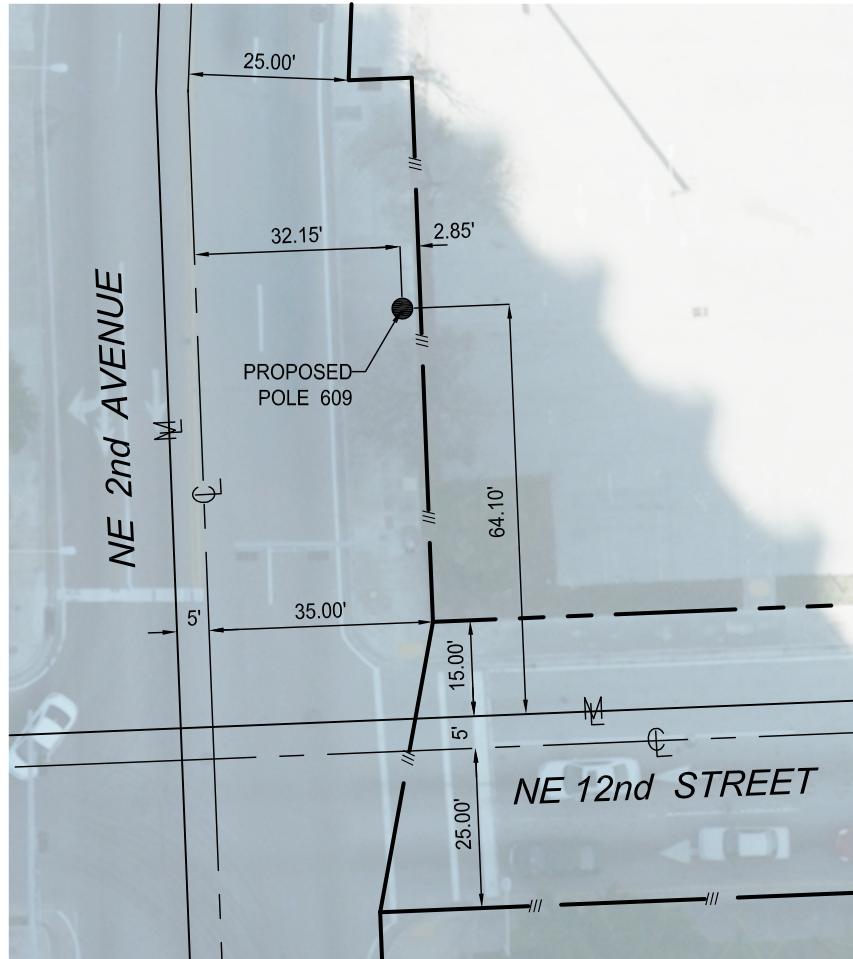
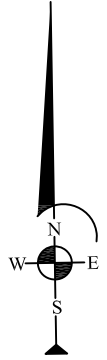

LEGEND:

- EXISTING RIGHT OF WAY LINE
- - - MAPPED (ZONED) STREET LINE
- ⊕ CENTER LINE
- M MONUMENT LINE

MANUEL G.VERA AND ASSOCIATES, INC.
 ENGINEERS-SURVEYORS & MAPPERS
 13960 S.W. 47th ST. MIAMI, FLORIDA 33175 L.B. No.2439
 PHONE: (305) 221-6210 e-mail: mverajr@mgvera.com

PROJECT NUMBER: 16-574		
TYPE OF PROJECT: SPECIFIC PURPOSE SURVEY		
PROJECT NAME: POLE LOCATION		
DATE: 07-11-2016	SCALE	SHEET
DRAWN BY: JCF	1"=30'	2 OF 2

NOT A BOUNDARY SURVEY



LOCATION DESCRIPTION:

NE 2nd Ave N/O NE 12th St

FOR EXACT SIGN POST LOCATION
PLEASE REFER TO ATTACHED
SPECIFIC PURPOSE SURVEY SKETCH

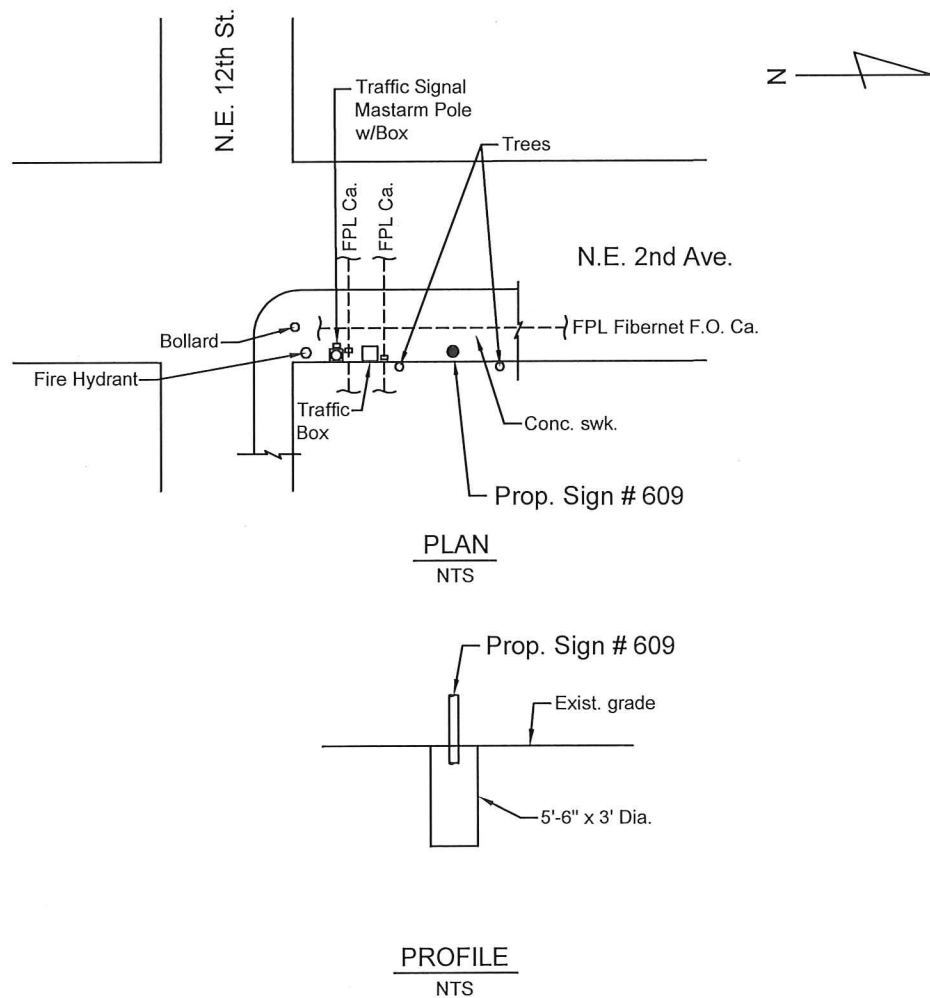

COMMENTS: Best Footer for Prop. Sign # 609 is: 5'-6" x 3' Dia.

MIAMI DDA - WAYFINDING AND SIGNAGE SYSTEM PROGRAM

DISCLAIMER:

This sketch has been prepared for utility coordination purposes only. This sketch is Not for Construction.

Utility coordination done by:
JRA Inc.
engineers-planners
10661 N Kendall Dr., Ste. 206B
Miami, FL 33176-1550
Phone 305-270-7800
CA 7613

MIAMI-DADE COUNTY

SIGN No. 609

Sign Type Dist - ID.3

DATE: 04-10-2017

Sign No.
610



**Downtown
Miami District
ID Program**



Wayfinding & Signage System Program

Downtown Miami, Florida

SIGN NO. 610

Location Aerial View:



Location Photo:

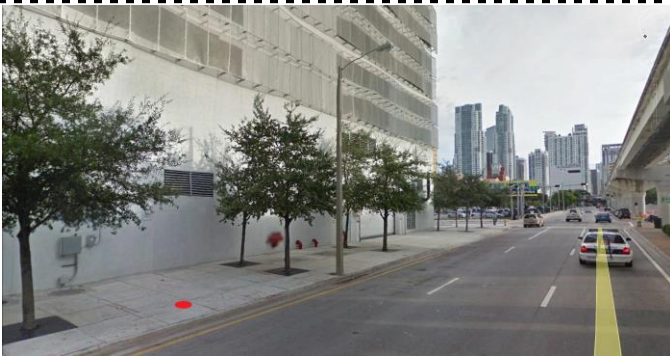

Sign Type: DistID.3

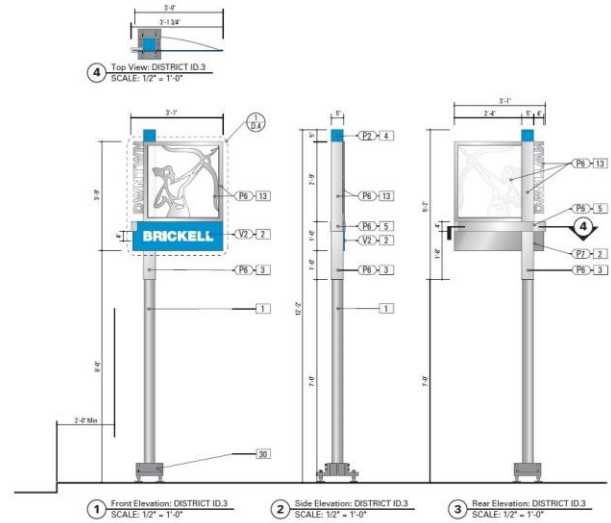

Sign Message:

Face A	Central Business District
Face B	None

Ground Condition: Concrete

Foundation Type: 2' X 3' 10" Square

Reference Intersection: NE 2nd Ave south of NE 9th St

Detailed Location: 25' north of lamppost in photo

Orientation: SB

Right-of-Way Summary	Utilities Summary
Miami-Dade County	Electrical AT&T Street Light Fibernet F.O. FPL Duct Bank

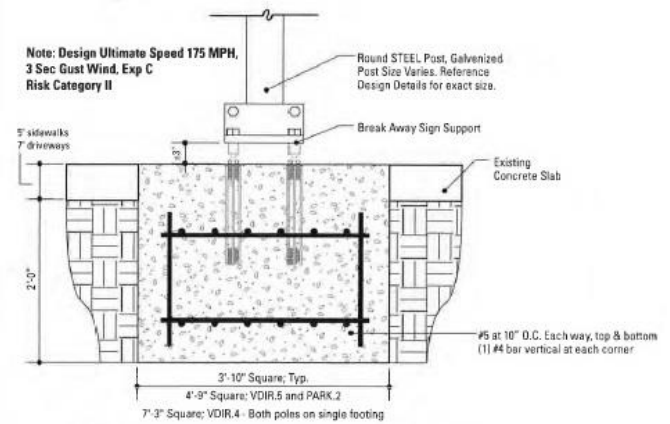

SPECIFIC PURPOSE SURVEY PROPOSED POLES 610

SURVEYOR'S REPORT :

- THE SPECIFIC PURPOSE OF THIS SURVEY IS TO SHOW THE LOCATION OF THE PROPOSED POLE IN RELATION TO THE MONUMENT LINES AND RIGHT-OF-WAY LINES.
- THIS IS NOT A BOUNDARY SURVEY
- THE LOCATION OF THE PROPOSED POLE SHOWN HEREON WAS PROVIDED BY THE CLIENT.
- THERE ARE EXISTING IMPROVEMENTS LYING WITHIN THE LIMITS OF THE SKETCH, WHICH ARE NOT SHOWN ON THIS SURVEY.
- REVIEW OF TITLE SEARCH WAS NOT PART OF THE SCOPE OF SERVICES.
- RIGHT-OF-WAY LINES AND MAPPED (ZONED) STREET LINES ARE AS PER CITY OF MIAMI ATLAS SHEET AND MIAMI-DADE COUNTY PLATS OF RECORD.
- POLE 610 LIES WITHIN THE JURISDICTION OF MIAMI DADE COUNTY.
- INFORMATION REGARDING STREET JURISDICTION WAS TAKEN FROM MAP ENTITLED : DOWNTOWN MIAMI STREETS BY JURISDICTION PREPARED BY CITY OF MIAMI DATED SEPTEMBER 1, 2015 AND FURNISHED BY THE CLIENT.

SURVEYOR'S CERTIFICATION :

I HEREBY CERTIFY THAT THIS SPECIFIC PURPOSE SURVEY WAS PREPARED UNDER MY DIRECT SUPERVISION AND THAT IT IS TRUE AND CORRECT TO THE BEST OF MY KNOWLEDGE AND BELIEF AND I FURTHER CERTIFY THAT SAID SURVEY IS IN COMPLIANCE WITH THE STANDARDS OF PRACTICE AS SET FORTH BY THE FLORIDA BOARD OF LAND SURVEYORS AND MAPPERS IN CHAPTER 5J-17 FLORIDA ADMINISTRATIVE CODE PURSUANT TO SECTION 472.027 OF THE FLORIDA STATUTES.

 MANUEL G. VERA JR.
 PROFESSIONAL SURVEYOR AND MAPPER No. 5291
 STATE OF FLORIDA
 NOTICE: NOT VALID WITHOUT THE SIGNATURE AND ORIGINAL RAISED SEAL OF THE FLORIDA LICENSED SURVEYOR AND MAPPER.
 EACH SHEET AS INCORPORATED HEREIN SHALL NOT BE CONSIDERED FULL, VALID AND COMPLETE UNLESS ATTACHED TO THE OTHERS.

FOR SKETCH SEE SHEET 2

MANUEL G.VERA AND ASSOCIATES, INC.
 ENGINEERS-SURVEYORS & MAPPERS
 13960 S.W. 47th ST. MIAMI, FLORIDA 33175 L.B. No.2439
 PHONE: (305) 221-6210 e-mail: mverajr@mgvera.com

PROJECT NUMBER: 16-574		
TYPE OF PROJECT: SPECIFIC PURPOSE SURVEY		
PROJECT NAME: POLE LOCATION		
DATE: 07-05-2016	SCALE	SHEET
DRAWN BY: JCF	N.A.	1 OF 2

NOT A BOUNDARY SURVEY

SPECIFIC PURPOSE SURVEY PROPOSED POLE 610

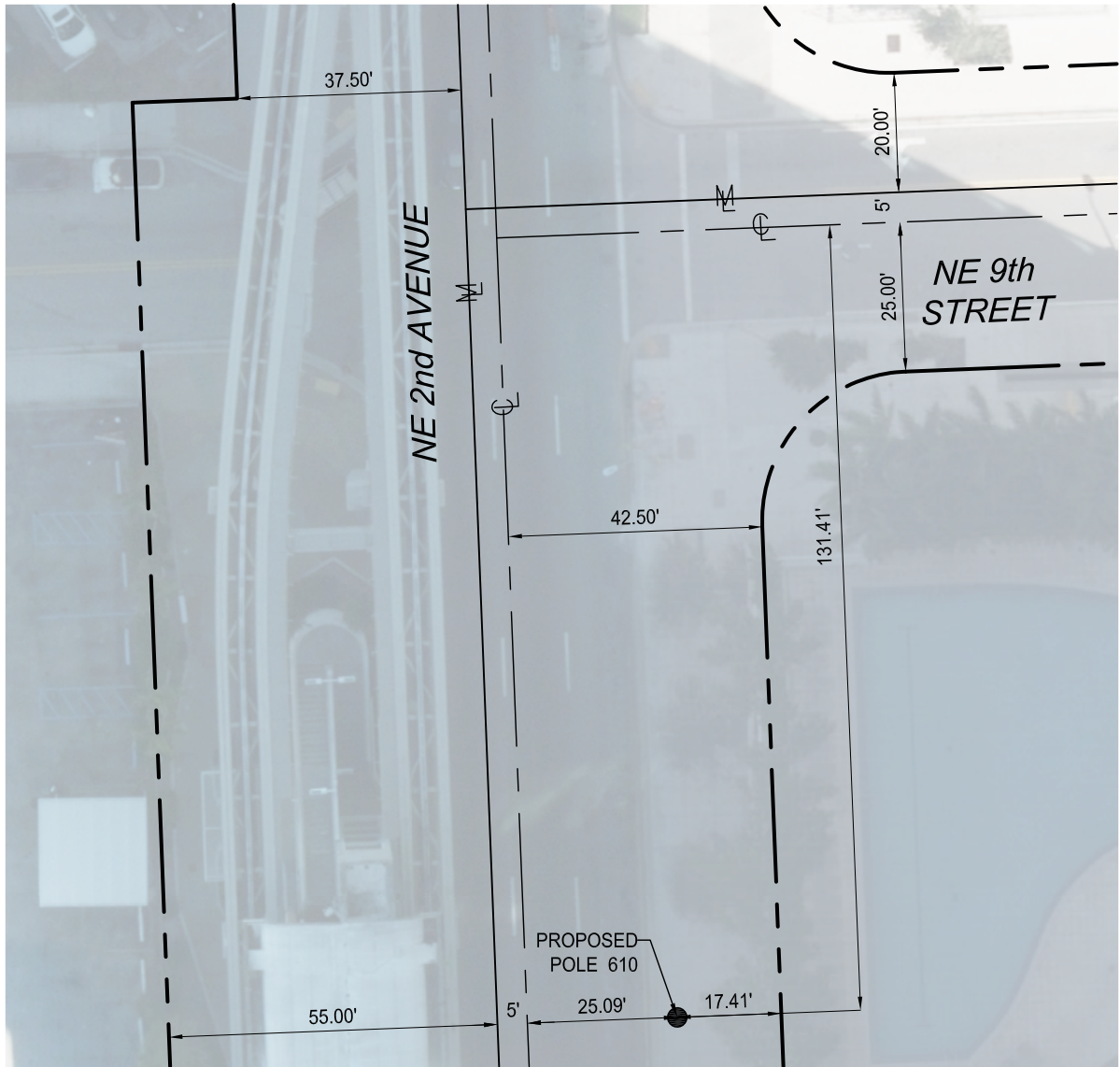
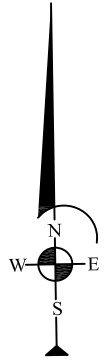

LEGEND:

- EXISTING RIGHT OF WAY LINE
- - - MAPPED (ZONED) STREET LINE
- ⊕ CENTER LINE
- M MONUMENT LINE

ABBREVIATIONS:

- SR - STATE ROAD
- US - UNITED STATE HIGHWAY

NOT A BOUNDARY SURVEY

MANUEL G.VERA AND ASSOCIATES, INC.
 ENGINEERS-SURVEYORS & MAPPERS
 13960 S.W. 47th ST. MIAMI, FLORIDA 33175 L.B. No.2439
 PHONE: (305) 221-6210 e-mail: mverajr@mgvera.com

PROJECT NUMBER: 16-574		
TYPE OF PROJECT: SPECIFIC PURPOSE SURVEY		
PROJECT NAME: POLE LOCATION		
DATE: 07-05-2016	SCALE	SHEET
DRAWN BY: JCF	1"=30'	2 OF 2



LOCATION DESCRIPTION:

NE 2nd Ave N/O NE 8th St

FOR EXACT SIGN POST LOCATION
PLEASE REFER TO ATTACHED
SPECIFIC PURPOSE SURVEY SKETCH

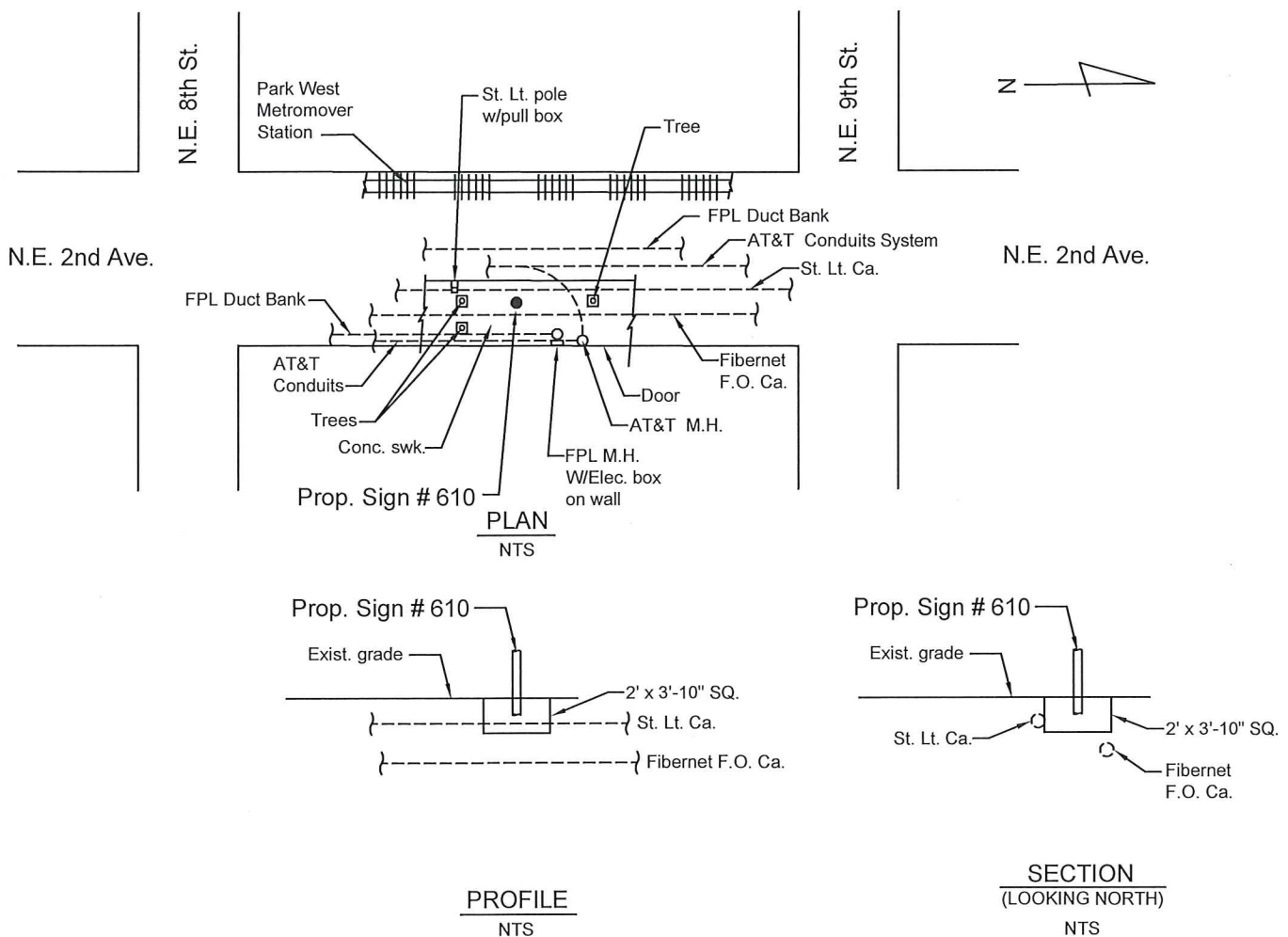

COMMENTS: Best Footer for Prop. Sign # 610 is: 2' x 3'-10" SQ.

MIAMI DDA - WAYFINDING AND SIGNAGE SYSTEM PROGRAM

DISCLAIMER:

This sketch has been prepared for utility coordination purposes only. This sketch is Not for Construction.

Utility coordination done by:
 JRA Inc.
 engineers-planners
 10661 N Kendall Dr., Ste. 206B
 Miami, FL 33176-1550
 Phone 305-270-7800
 CA 7613

MIAMI-DADE COUNTY

SIGN No. 610

Sign Type Dist - ID.3

DATE: 04-10-2017

Sign No.
611A



Downtown
Miami District
ID Program



Wayfinding & Signage System Program

Downtown Miami, Florida

SIGN NO. 611A

Location Aerial View:



Location Photo:

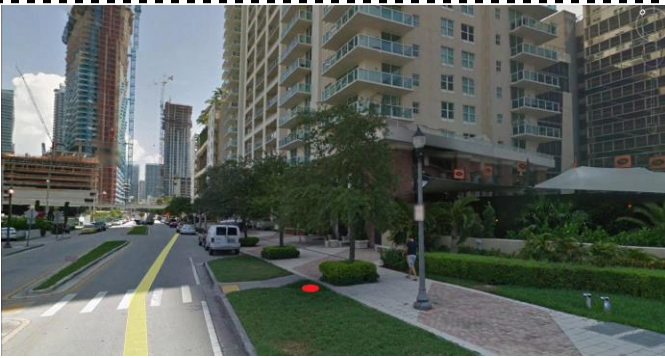

Reference Intersection: S Miami Ave @ SE 15th St

Detailed Location: North of 15th St. 8' south of crosswalk, 6' off curb

Orientation: NB

Right-of-Way Summary	Utilities Summary
Miami-Dade County	Street Light

Sign Type: DistID.3

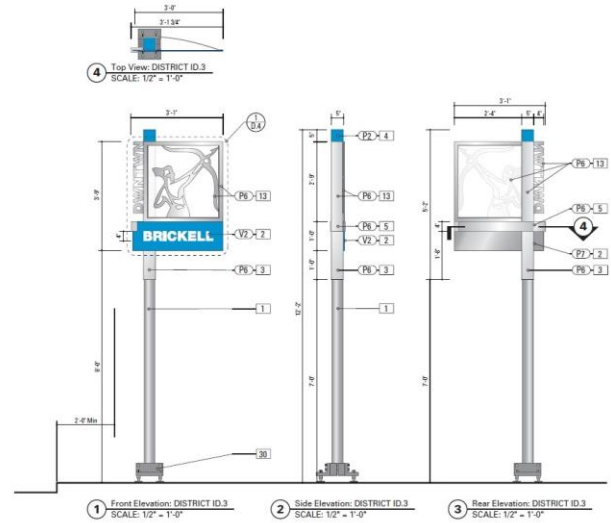

Sign Message:

Face A	Brickell District
Face B	None

Ground Condition: Grass

Foundation Type: 5' 6" X 3' Diameter

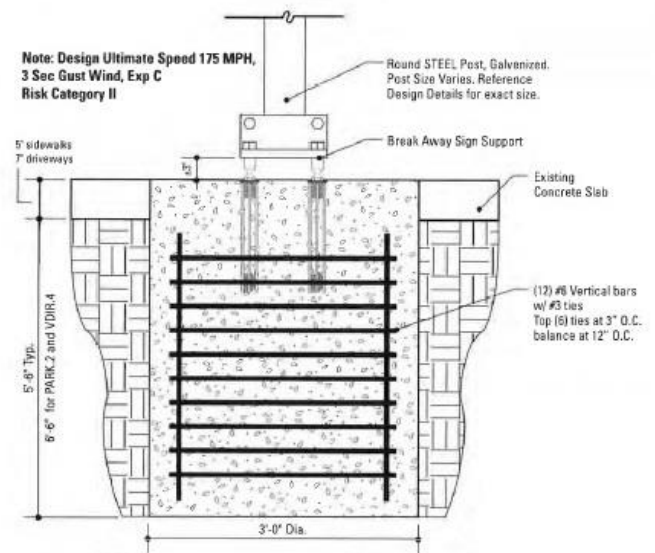

SPECIFIC PURPOSE SURVEY PROPOSED POLE 611A

SURVEYOR'S REPORT :

- THE SPECIFIC PURPOSE OF THIS SURVEY IS TO SHOW THE LOCATION OF THE PROPOSED POLE IN RELATION TO THE MONUMENT LINES AND RIGHT-OF-WAY LINES.
- THIS IS NOT A BOUNDARY SURVEY
- THE LOCATION OF THE PROPOSED POLE SHOWN HEREON WAS PROVIDED BY THE CLIENT.
- THERE ARE EXISTING IMPROVEMENTS LYING WITHIN THE LIMITS OF THE SKETCH, WHICH ARE NOT SHOWN ON THIS SURVEY.
- REVIEW OF TITLE SEARCH WAS NOT PART OF THE SCOPE OF SERVICES.
- RIGHT-OF-WAY LINES AND MAPPED (ZONED) STREET LINES ARE AS PER CITY OF MIAMI ATLAS SHEET AND MIAMI-DADE COUNTY PLATS OF RECORD.
- POLE 611A LIES WITHIN THE JURISDICTION OF MIAMI DADE COUNTY.
- INFORMATION REGARDING STREET JURISDICTION WAS TAKEN FROM MAP ENTITLED : DOWNTOWN MIAMI STREETS BY JURISDICTION PREPARED BY CITY OF MIAMI DATED SEPTEMBER 1, 2015 AND FURNISHED BY THE CLIENT.

SURVEYOR'S CERTIFICATION :

I HEREBY CERTIFY THAT THIS SPECIFIC PURPOSE SURVEY WAS PREPARED UNDER MY DIRECT SUPERVISION AND THAT IT IS TRUE AND CORRECT TO THE BEST OF MY KNOWLEDGE AND BELIEF AND I FURTHER CERTIFY THAT SAID SURVEY IS IN COMPLIANCE WITH THE STANDARDS OF PRACTICE AS SET FORTH BY THE FLORIDA BOARD OF LAND SURVEYORS AND MAPPERS IN CHAPTER 5J-17 FLORIDA ADMINISTRATIVE CODE PURSUANT TO SECTION 472.027 OF THE FLORIDA STATUTES.

 MANUEL G. VERA JR.
 PROFESSIONAL SURVEYOR AND MAPPER No. 5291
 STATE OF FLORIDA
 NOTICE: NOT VALID WITHOUT THE SIGNATURE AND ORIGINAL RAISED SEAL OF THE FLORIDA LICENSED SURVEYOR AND MAPPER.
 EACH SHEET AS INCORPORATED HEREIN SHALL NOT BE CONSIDERED FULL, VALID AND COMPLETE UNLESS ATTACHED TO THE OTHERS.

FOR SKETCH SEE SHEET 2

MANUEL G.VERA AND ASSOCIATES, INC.
 ENGINEERS-SURVEYORS & MAPPERS
 13960 S.W. 47th ST. MIAMI, FLORIDA 33175 L.B. No.2439
 PHONE: (305) 221-6210 e-mail: mverajr@mgvera.com

PROJECT NUMBER: 16-574		
TYPE OF PROJECT: SPECIFIC PURPOSE SURVEY		
PROJECT NAME: POLE LOCATION		
DATE: 06-28-2016	SCALE	SHEET
DRAWN BY: JCF	N.A.	1 OF 2

NOT A BOUNDARY SURVEY

SPECIFIC PURPOSE SURVEY PROPOSED POLE 611A

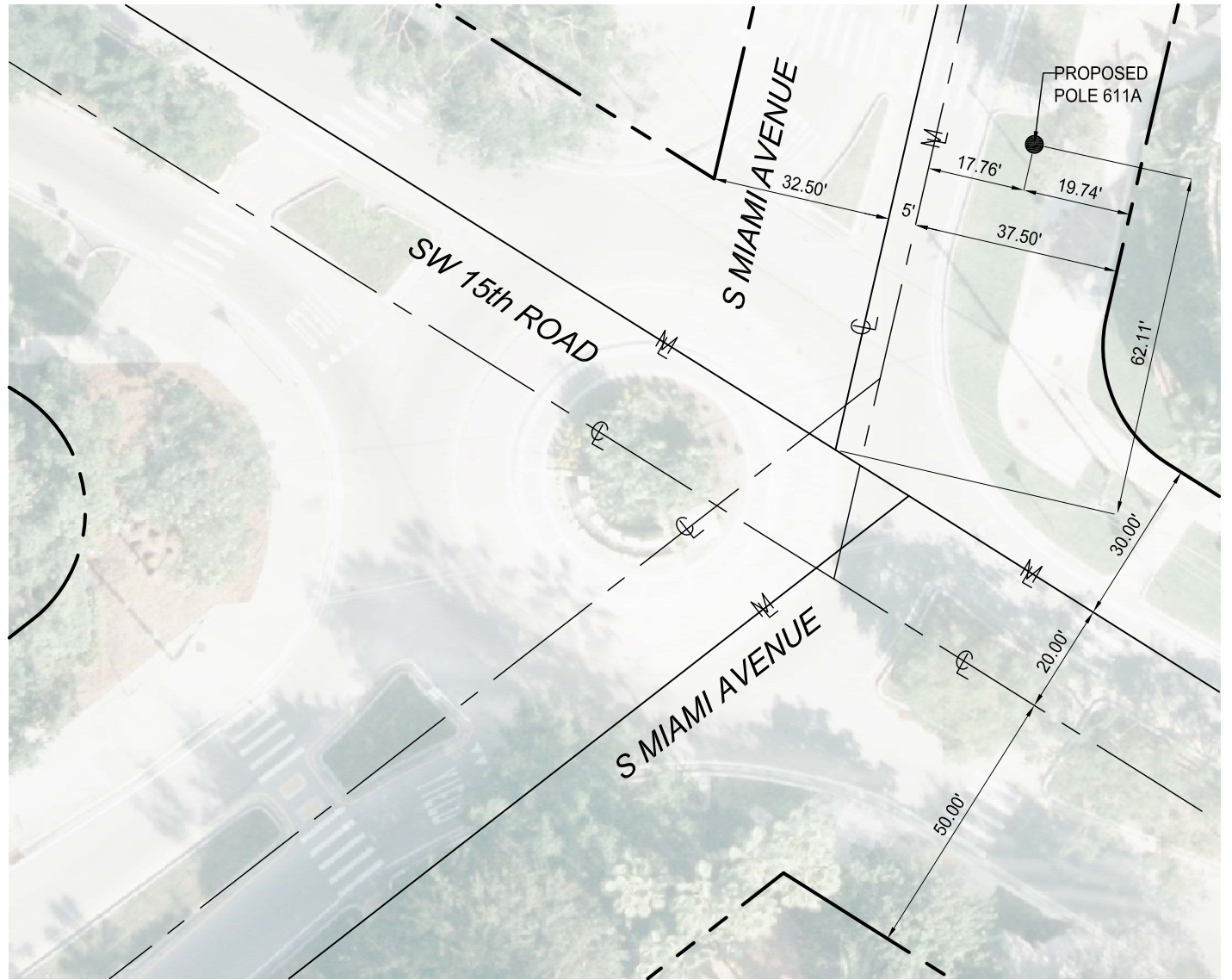
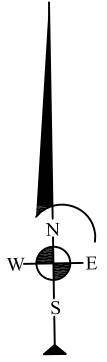

LEGEND:

- EXISTING RIGHT OF WAY LINE
- EXISTING LIMITED ACCESS RIGHT OF WAY LINE
- - - MAPPED (ZONED) STREET LINE
- ⊕ CENTER LINE
- M MONUMENT LINE

NOT A BOUNDARY SURVEY

MANUEL G.VERA AND ASSOCIATES, INC.
 ENGINEERS-SURVEYORS & MAPPERS
 13960 S.W. 47th ST. MIAMI, FLORIDA 33175 L.B. No.2439
 PHONE: (305) 221-6210 e-mail: mverajr@mgvera.com

PROJECT NUMBER: 16-574		
TYPE OF PROJECT: SPECIFIC PURPOSE SURVEY		
PROJECT NAME: POLE LOCATION		
DATE: 06-28-2016	SCALE	SHEET
DRAWN BY: JCF	1"=30'	2 OF 2



LOCATION DESCRIPTION:

S Miami Ave N/O SE 15th Rd

FOR EXACT SIGN POST LOCATION
PLEASE REFER TO ATTACHED
SPECIFIC PURPOSE SURVEY SKETCH

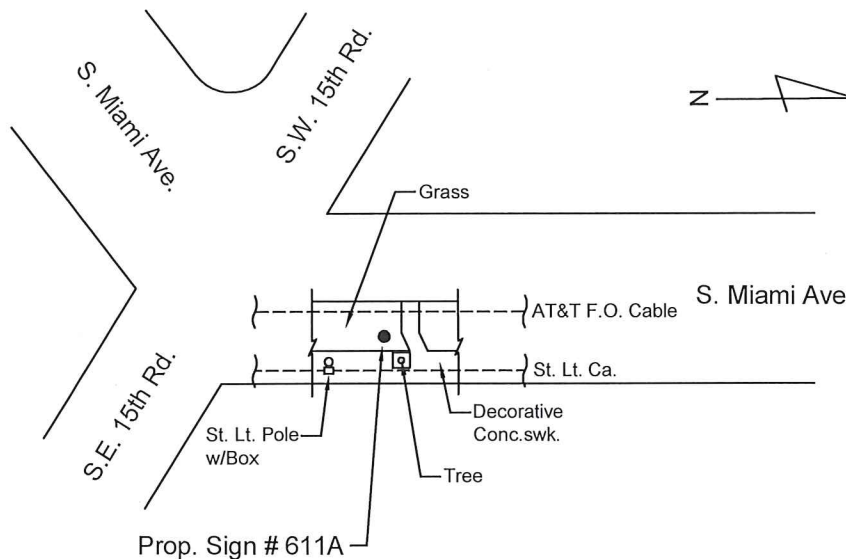

PLAN
NTS

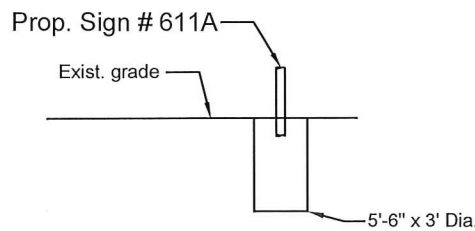

PROFILE
NTS

COMMENTS: Best Footer for Prop. Sign # 611A is: 5'-6" x 3' Dia.

MIAMI DDA - WAYFINDING AND SIGNAGE SYSTEM PROGRAM

DISCLAIMER:

This sketch has been prepared for utility coordination purposes only. This sketch is Not for Construction.

Utility coordination done by:
JRA Inc.
engineers-planners
10661 N Kendall Dr., Ste. 206B
Miami, FL 33176-1550
Phone 305-270-7800
CA 7613

MIAMI-DADE COUNTY

SIGN No. 611A

Type Dist - ID.3

DATE: 04-10-2017

Sign No.
611C



**Downtown
Miami District
ID Program**



Wayfinding & Signage System Program

Downtown Miami, Florida

SIGN NO. 611C

Location Aerial View:

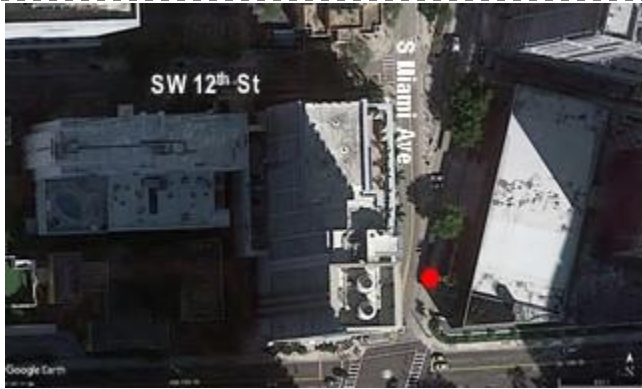

Location Photo:



Reference Intersection: S Miami Ave @ SE 13th St

Detailed Location: Replace road work ahead sign

Orientation: NB

Right-of-Way Summary	Utilities Summary
Miami-Dade County	FPL Duct Bank MCI F.O. AT&T AT&T F.O. Verizon F.O. Comcast

Sign Type: DistID.3

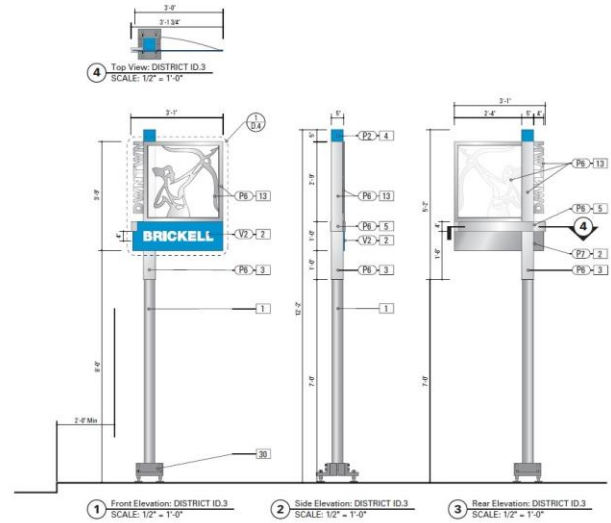

Sign Message:

Face A	Brickell District
Face B	None

Ground Condition: Concrete

Foundation Type: 2' X 3' 10" Square

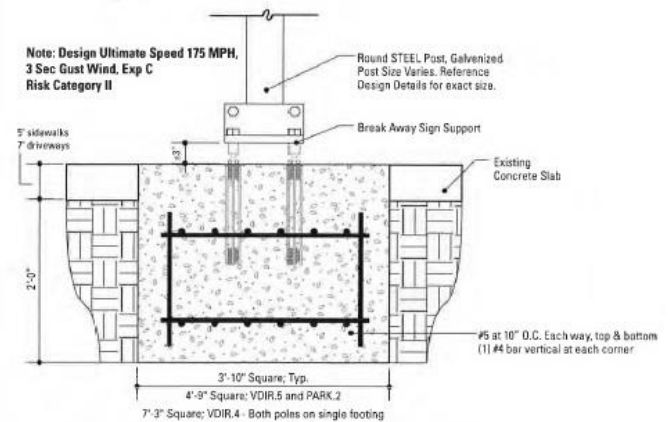

SPECIFIC PURPOSE SURVEY PROPOSED POLE 611C

SURVEYOR'S REPORT :

- THE SPECIFIC PURPOSE OF THIS SURVEY IS TO SHOW THE LOCATION OF THE PROPOSED POLE IN RELATION TO THE MONUMENT LINES AND RIGHT-OF-WAY LINES.
- THIS IS NOT A BOUNDARY SURVEY
- THE LOCATION OF THE PROPOSED POLE SHOWN HEREON WAS PROVIDED BY THE CLIENT.
- THERE ARE EXISTING IMPROVEMENTS LYING WITHIN THE LIMITS OF THE SKETCH, WHICH ARE NOT SHOWN ON THIS SURVEY.
- REVIEW OF TITLE SEARCH WAS NOT PART OF THE SCOPE OF SERVICES.
- RIGHT-OF-WAY LINES AND MAPPED (ZONED) STREET LINES ARE AS PER CITY OF MIAMI ATLAS SHEET AND MIAMI-DADE COUNTY PLATS OF RECORD.
- POLE 611C LIES WITHIN THE JURISDICTION OF MIAMI DADE COUNTY.
- INFORMATION REGARDING STREET JURISDICTION WAS TAKEN FROM MAP ENTITLED : DOWNTOWN MIAMI STREETS BY JURISDICTION PREPARED BY CITY OF MIAMI DATED SEPTEMBER 1, 2015 AND FURNISHED BY THE CLIENT.

SURVEYOR'S CERTIFICATION :

I HEREBY CERTIFY THAT THIS SPECIFIC PURPOSE SURVEY WAS PREPARED UNDER MY DIRECT SUPERVISION AND THAT IT IS TRUE AND CORRECT TO THE BEST OF MY KNOWLEDGE AND BELIEF AND I FURTHER CERTIFY THAT SAID SURVEY IS IN COMPLIANCE WITH THE STANDARDS OF PRACTICE AS SET FORTH BY THE FLORIDA BOARD OF LAND SURVEYORS AND MAPPERS IN CHAPTER 5J-17 FLORIDA ADMINISTRATIVE CODE PURSUANT TO SECTION 472.027 OF THE FLORIDA STATUTES.

 MANUEL G. VERA JR.
 PROFESSIONAL SURVEYOR AND MAPPER No. 5291
 STATE OF FLORIDA
 NOTICE: NOT VALID WITHOUT THE SIGNATURE AND ORIGINAL RAISED SEAL OF THE FLORIDA LICENSED SURVEYOR AND MAPPER.
 EACH SHEET AS INCORPORATED HEREIN SHALL NOT BE CONSIDERED FULL, VALID AND COMPLETE UNLESS ATTACHED TO THE OTHERS.

FOR SKETCH SEE SHEET 2

MANUEL G.VERA AND ASSOCIATES, INC.
 ENGINEERS-SURVEYORS & MAPPERS
 13960 S.W. 47th ST. MIAMI, FLORIDA 33175 L.B. No.2439
 PHONE: (305) 221-6210 e-mail: mverajr@mgvera.com

PROJECT NUMBER: 16-574		
TYPE OF PROJECT: SPECIFIC PURPOSE SURVEY		
PROJECT NAME: POLE LOCATION		
DATE: 06-28-2016	SCALE	SHEET
DRAWN BY: JCF	N.A.	1 OF 2

NOT A BOUNDARY SURVEY

SPECIFIC PURPOSE SURVEY PROPOSED POLE 611C

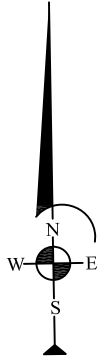

LEGEND:

- EXISTING RIGHT OF WAY LINE
- - - MAPPED (ZONED) STREET LINE
- ⊕ CENTER LINE
- M MONUMENT LINE

NOT A BOUNDARY SURVEY

MANUEL G.VERA AND ASSOCIATES, INC.
 ENGINEERS-SURVEYORS & MAPPERS
 13960 S.W. 47th ST. MIAMI, FLORIDA 33175 L.B. No.2439
 PHONE: (305) 221-6210 e-mail: mverajr@mgvera.com

PROJECT NUMBER: 16-574		
TYPE OF PROJECT: SPECIFIC PURPOSE SURVEY		
PROJECT NAME: POLE LOCATION		
DATE: 06-28-2016	SCALE	SHEET
DRAWN BY: JCF	1"=30'	2 OF 2



LOCATION DESCRIPTION:

S Miami Ave N/O SE 13th St.

FOR EXACT SIGN POST LOCATION
PLEASE REFER TO ATTACHED
SPECIFIC PURPOSE SURVEY SKETCH

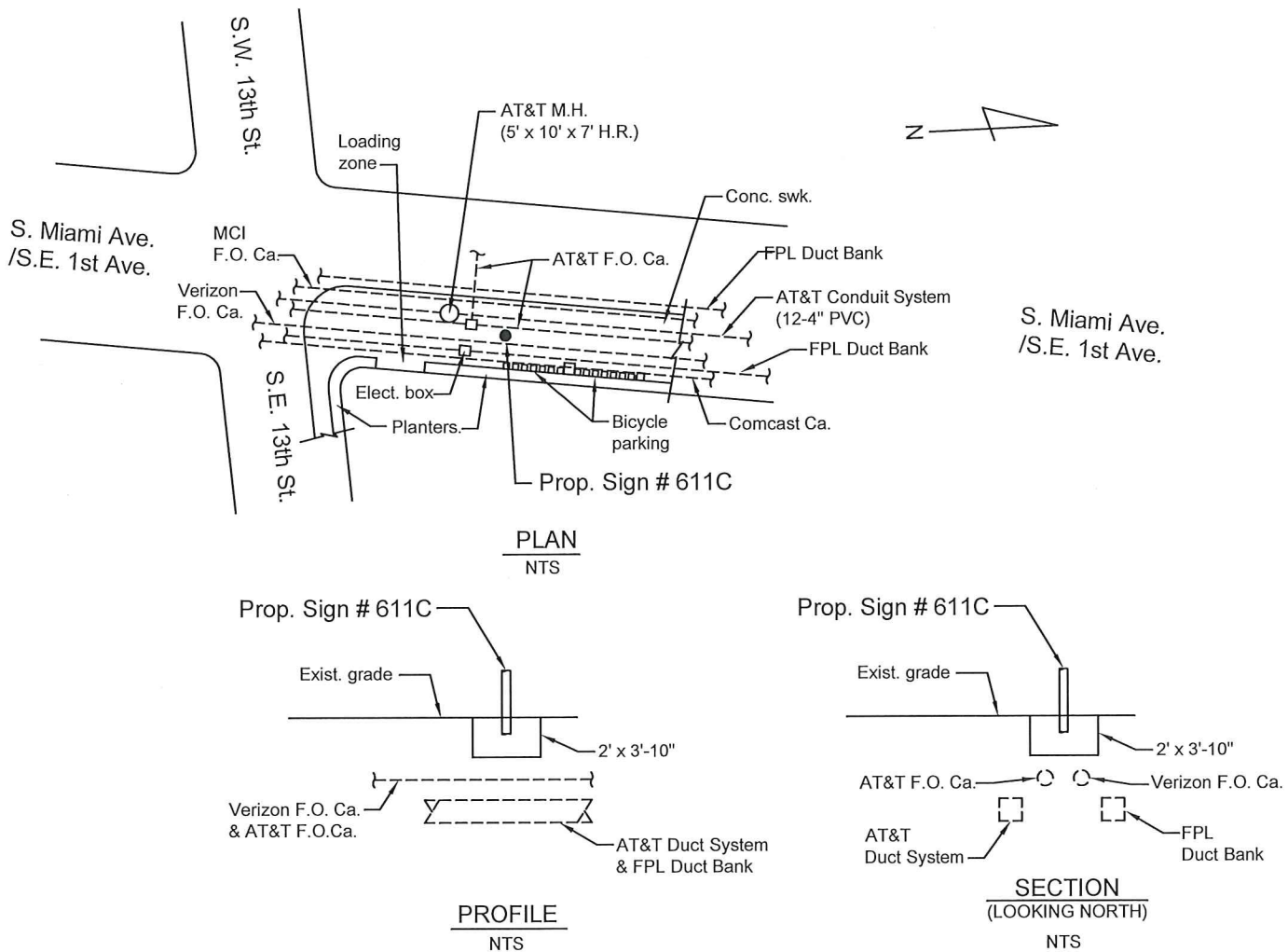

COMMENTS: Best Footer for Prop. Sign # 611C is: 2' x 3'-10"

MIAMI DDA - WAYFINDING AND SIGNAGE SYSTEM PROGRAM

DISCLAIMER:

This sketch has been prepared for utility coordination purposes only. This sketch is Not for Construction.

Utility coordination done by:
JRA Inc.
engineers-planners
10661 N Kendall Dr., Ste. 206B
Miami, FL 33176-1550
Phone 305-270-7800
CA 7613

MIAMI-DADE COUNTY

SIGN No. 611C

Type Dist - ID.3

DATE: 04-10-2017

Sign No.
614



Downtown
Miami District
ID Program



Wayfinding & Signage System Program

Downtown Miami, Florida

SIGN NO. 614

Location Aerial View:



Location Photo:



Reference Intersection: NE 1st Ave north of NE 9th St

Detailed Location: Along fence line where sidewalk jogs east

Orientation: NB

Right-of-Way Summary	Utilities Summary
Miami-Dade County	None

Sign Type: DistID.3

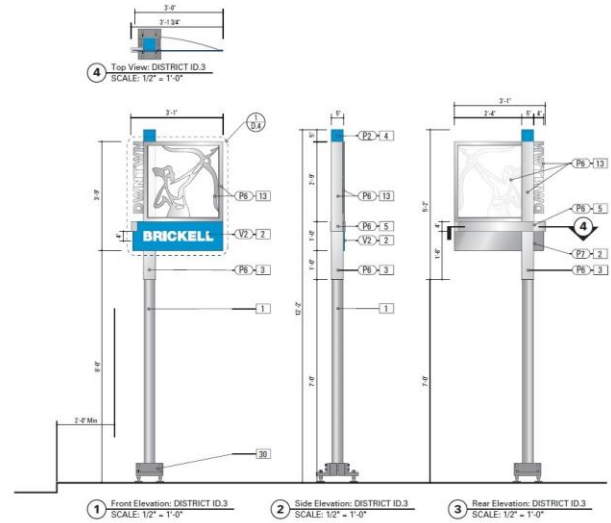

Sign Message:

Face A	Arts & Entertainment
Face B	None

Ground Condition: Concrete

Foundation Type: 5' 6" X 3' Diameter

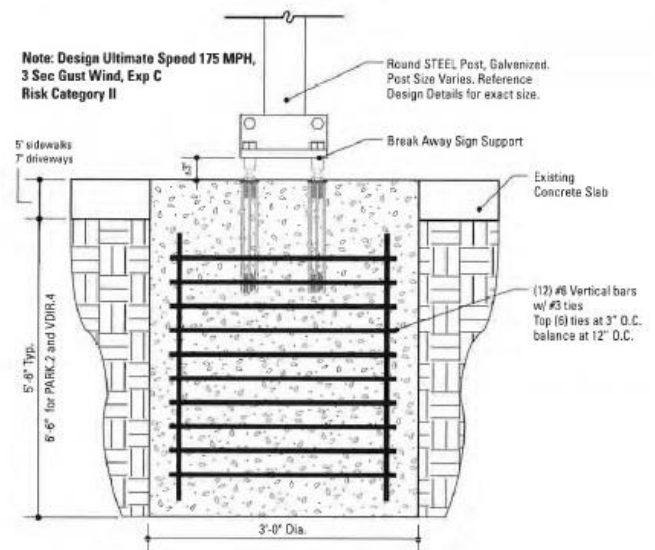

SPECIFIC PURPOSE SURVEY PROPOSED POLE 614

SURVEYOR'S REPORT :

- THE SPECIFIC PURPOSE OF THIS SURVEY IS TO SHOW THE LOCATION OF THE PROPOSED POLE IN RELATION TO THE MONUMENT LINES AND RIGHT-OF-WAY LINES.

- THIS IS NOT A BOUNDARY SURVEY

- THE LOCATION OF THE PROPOSED POLE SHOWN HEREON WAS PROVIDED BY THE CLIENT.

- THERE ARE EXISTING IMPROVEMENTS LYING WITHIN THE LIMITS OF THE SKETCH, WHICH ARE NOT SHOWN ON THIS SURVEY.

- REVIEW OF TITLE SEARCH WAS NOT PART OF THE SCOPE OF SERVICES.

- RIGHT-OF-WAY LINES AND MAPPED (ZONED) STREET LINES ARE AS PER CITY OF MIAMI ATLAS SHEET AND MIAMI-DADE COUNTY PLATS OF RECORD.

- POLE 614 LIES WITHIN THE JURISDICTION OF MIAMI DADE COUNTY.

- INFORMATION REGARDING STREET JURISDICTION WAS TAKEN FROM MAP ENTITLED : DOWNTOWN MIAMI STREETS BY JURISDICTION PREPARED BY CITY OF MIAMI DATED SEPTEMBER 1, 2015 AND FURNISHED BY THE CLIENT.

SURVEYOR'S CERTIFICATION :

I HEREBY CERTIFY THAT THIS SPECIFIC PURPOSE SURVEY WAS PREPARED UNDER MY DIRECT SUPERVISION AND THAT IT IS TRUE AND CORRECT TO THE BEST OF MY KNOWLEDGE AND BELIEF AND I FURTHER CERTIFY THAT SAID SURVEY IS IN COMPLIANCE WITH THE STANDARDS OF PRACTICE AS SET FORTH BY THE FLORIDA BOARD OF LAND SURVEYORS AND MAPPERS IN CHAPTER 5J-17 FLORIDA ADMINISTRATIVE CODE PURSUANT TO SECTION 472.027 OF THE FLORIDA STATUTES.

MANUEL G. VERA JR.
PROFESSIONAL SURVEYOR AND MAPPER No. 5291
STATE OF FLORIDA
NOTICE: NOT VALID WITHOUT THE SIGNATURE AND ORIGINAL RAISED SEAL OF THE FLORIDA LICENSED SURVEYOR AND MAPPER.
EACH SHEET AS INCORPORATED HEREIN SHALL NOT BE CONSIDERED FULL, VALID AND COMPLETE UNLESS ATTACHED TO THE OTHERS.

FOR SKETCH SEE SHEET 2

MANUEL G.VERA AND ASSOCIATES, INC.
ENGINEERS-SURVEYORS & MAPPERS
13960 S.W. 47th ST. MIAMI, FLORIDA 33175 L.B. No.2439
PHONE: (305) 221-6210 e-mail: mverajr@mgvera.com

PROJECT NUMBER: 16-574		
TYPE OF PROJECT: SPECIFIC PURPOSE SURVEY		
PROJECT NAME: POLE LOCATION		
DATE: 06-25-2016	SCALE	SHEET
DRAWN BY: JAA	N.A.	1 OF 2

NOT A BOUNDARY SURVEY

SPECIFIC PURPOSE SURVEY PROPOSED POLE 614

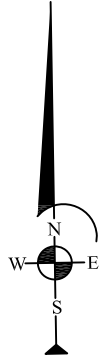

LEGEND:

- EXISTING RIGHT OF WAY LINE
- - - MAPPED (ZONED) STREET LINE
- ⊙ CENTER LINE
- Ⓜ MONUMENT LINE

Z:\DESIGN 2016\16574_of_City of Miami_Pole Locations\ACAD SKETCH\16 574 POLE 614.dwg

NOT A BOUNDARY SURVEY

MANUEL G.VERA AND ASSOCIATES, INC.
 ENGINEERS-SURVEYORS & MAPPERS
 13960 S.W. 47th ST. MIAMI, FLORIDA 33175 L.B. No.2439
 PHONE: (305) 221-6210 e-mail: mverajr@mgvera.com

PROJECT NUMBER: 16-574		
TYPE OF PROJECT: SPECIFIC PURPOSE SURVEY		
PROJECT NAME: POLE LOCATION		
DATE: 06-25-2016	SCALE: 1"=30'	SHEET: 2 OF 2
DRAWN BY: JAA		



LOCATION DESCRIPTION:

NE 1st Ave N/O NE 9th St

FOR EXACT SIGN POST LOCATION
PLEASE REFER TO ATTACHED
SPECIFIC PURPOSE SURVEY SKETCH

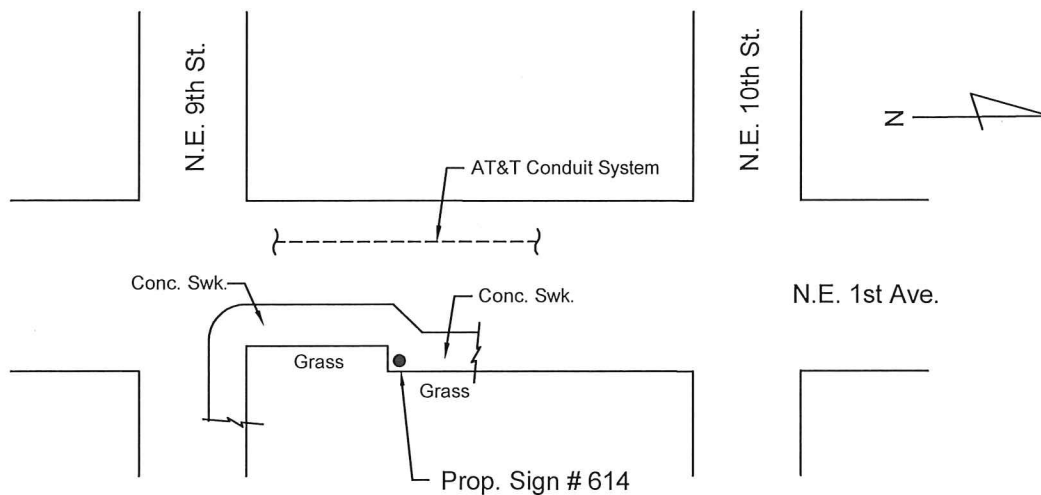

PLAN
NTS

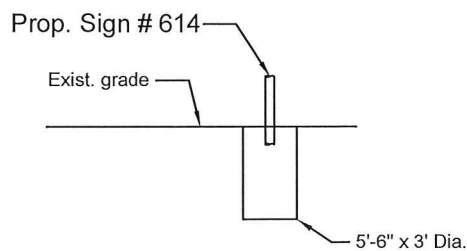

PROFILE
NTS

COMMENTS: Best Footer for Prop. Sign # 614 is: 5'-6" x 3' Dia.

MIAMI DDA - WAYFINDING AND SIGNAGE SYSTEM PROGRAM

DISCLAIMER:

This sketch has been prepared for utility coordination purposes only. This sketch is Not for Construction.

Utility coordination done by:
JRA Inc.
engineers-planners
10661 N Kendall Dr., Ste. 206B
Miami, FL 33176-1550
Phone 305-270-7800
CA 7613

MIAMI-DADE COUNTY

SIGN No. 614

Type Dist - ID.3

DATE: 04-10-2017

Sign No.
615



Downtown
Miami District
ID Program



Wayfinding & Signage System Program

Downtown Miami, Florida

SIGN NO. 615

Location Aerial View:



Location Photo:

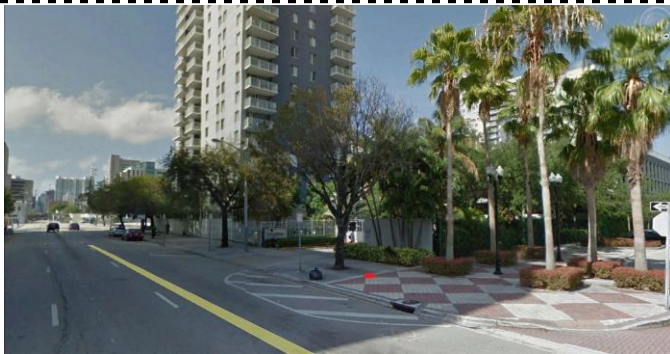

Reference Intersection: NW Miami Ave @ N 9th St

Detailed Location: 12' north of tree, parallel with tree

Orientation: SB

Right-of-Way Summary	Utilities Summary
Miami-Dade County	Street Light Cable

Sign Type: DistID.3

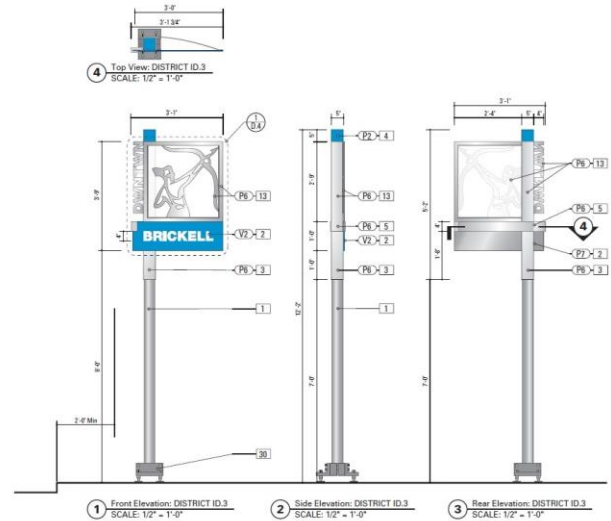

Sign Message:

Face A	Central Business District
Face B	None

Ground Condition: Concrete

Foundation Type: 5' 6" X 3' Diameter

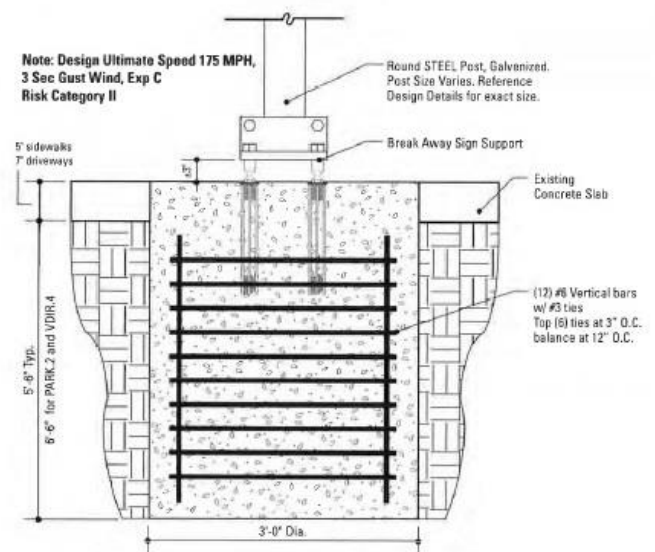

SPECIFIC PURPOSE SURVEY PROPOSED POLE 615

SURVEYOR'S REPORT :

- THE SPECIFIC PURPOSE OF THIS SURVEY IS TO SHOW THE LOCATION OF THE PROPOSED POLE IN RELATION TO THE MONUMENT LINES AND RIGHT-OF-WAY LINES.
- THIS IS NOT A BOUNDARY SURVEY
- THE LOCATION OF THE PROPOSED POLE SHOWN HEREON WAS PROVIDED BY THE CLIENT.
- THERE ARE EXISTING IMPROVEMENTS LYING WITHIN THE LIMITS OF THE SKETCH, WHICH ARE NOT SHOWN ON THIS SURVEY.
- REVIEW OF TITLE SEARCH WAS NOT PART OF THE SCOPE OF SERVICES.
- RIGHT-OF-WAY LINES AND MAPPED (ZONED) STREET LINES ARE AS PER CITY OF MIAMI ATLAS SHEET AND MIAMI-DADE COUNTY PLATS OF RECORD.
- POLE 615 LIES WITHIN THE JURISDICTION OF MIAMI DADE COUNTY.
- INFORMATION REGARDING STREET JURISDICTION WAS TAKEN FROM MAP ENTITLED : DOWNTOWN MIAMI STREETS BY JURISDICTION PREPARED BY CITY OF MIAMI DATED SEPTEMBER 1, 2015 AND FURNISHED BY THE CLIENT.

SURVEYOR'S CERTIFICATION :

I HEREBY CERTIFY THAT THIS SPECIFIC PURPOSE SURVEY WAS PREPARED UNDER MY DIRECT SUPERVISION AND THAT IT IS TRUE AND CORRECT TO THE BEST OF MY KNOWLEDGE AND BELIEF AND I FURTHER CERTIFY THAT SAID SURVEY IS IN COMPLIANCE WITH THE STANDARDS OF PRACTICE AS SET FORTH BY THE FLORIDA BOARD OF LAND SURVEYORS AND MAPPERS IN CHAPTER 5J-17 FLORIDA ADMINISTRATIVE CODE PURSUANT TO SECTION 472.027 OF THE FLORIDA STATUTES.

 MANUEL G. VERA JR.
 PROFESSIONAL SURVEYOR AND MAPPER No. 5291
 STATE OF FLORIDA
 NOTICE: NOT VALID WITHOUT THE SIGNATURE AND ORIGINAL RAISED SEAL OF THE FLORIDA LICENSED SURVEYOR AND MAPPER.
 EACH SHEET AS INCORPORATED HEREIN SHALL NOT BE CONSIDERED FULL, VALID AND COMPLETE UNLESS ATTACHED TO THE OTHERS.

FOR SKETCH SEE SHEET 2

MANUEL G.VERA AND ASSOCIATES, INC.
 ENGINEERS-SURVEYORS & MAPPERS
 13960 S.W. 47th ST. MIAMI, FLORIDA 33175 L.B. No.2439
 PHONE: (305) 221-6210 e-mail: mvera jr@mgvera.com

PROJECT NUMBER: 16-574		
TYPE OF PROJECT: SPECIFIC PURPOSE SURVEY		
PROJECT NAME: POLE LOCATION		
DATE: 07-14-2016	SCALE	SHEET
DRAWN BY: JCF	N.A.	1 OF 2

NOT A BOUNDARY SURVEY

**SPECIFIC PURPOSE SURVEY
PROPOSED POLE 615**

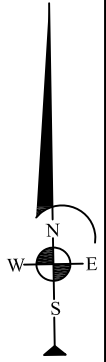

LEGEND:

- EXISTING RIGHT OF WAY LINE
- MAPPED (ZONED) STREET LINE
- CENTER LINE
- MONUMENT LINE

MANUEL G.VERA AND ASSOCIATES, INC.
 ENGINEERS-SURVEYORS & MAPPERS
 13960 S.W. 47th ST. MIAMI, FLORIDA 33175 L.B. No.2439
 PHONE: (305) 221-6210 e-mail: mverajr@mgvera.com

PROJECT NUMBER: 16-574		
TYPE OF PROJECT: SPECIFIC PURPOSE SURVEY		
PROJECT NAME: POLE LOCATION		
DATE: 07-14-2016	SCALE	SHEET
DRAWN BY: JCF	1"=30'	2 OF 2

NOT A BOUNDARY SURVEY



LOCATION DESCRIPTION:

N Miami Ave S/O N 9th St

FOR EXACT SIGN POST LOCATION
PLEASE REFER TO ATTACHED
SPECIFIC PURPOSE SURVEY SKETCH

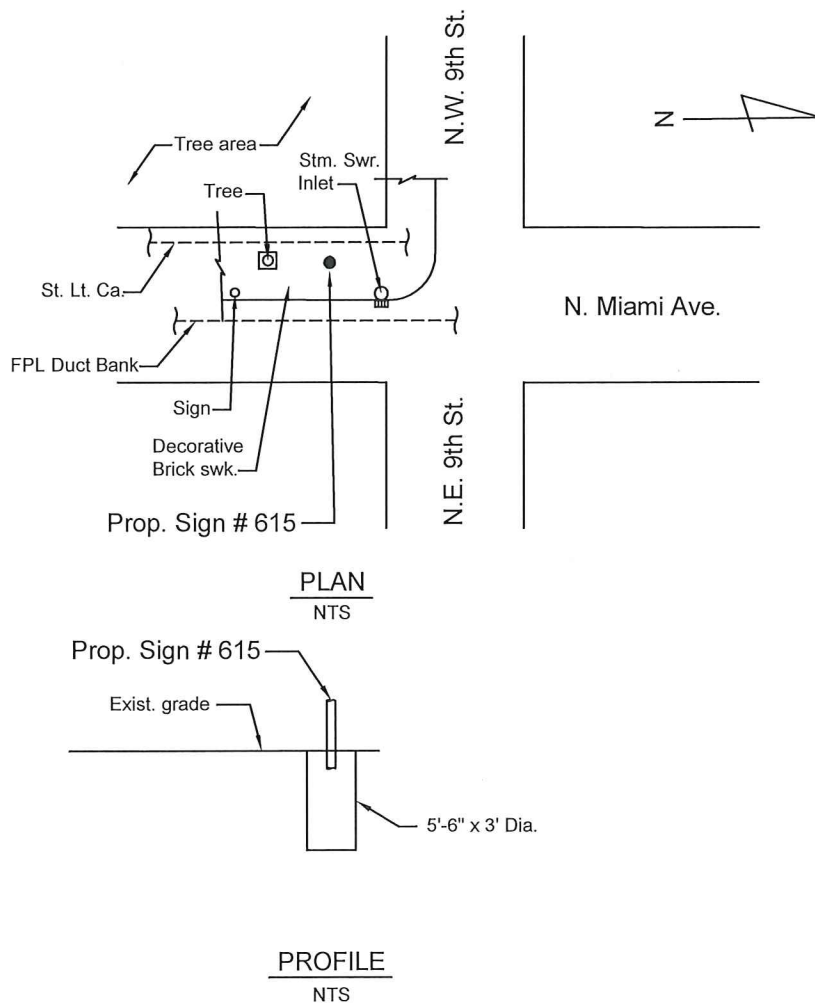

COMMENTS: Best Footer for Prop. Sign # 615 is: 5'-6" x 3' Dia.

MIAMI DDA - WAYFINDING AND SIGNAGE SYSTEM PROGRAM

DISCLAIMER:

This sketch has been prepared for utility coordination purposes only. This sketch is Not for Construction.

Utility coordination done by:
JRA Inc.
engineers-planners
10661 N Kendall Dr., Ste. 206B
Miami, FL 33176-1550
Phone 305-270-7800
CA 7613

MIAMI-DADE COUNTY

SIGN No. 615

Type Dist - ID.3

DATE: 04-10-2017