

Commission:

Mayor

Tomas P. Regalado

Chairman / D1 Commissioner

Wifredo (Willy) Gort

D2 Commissioner

Marc Sarnoff

D3 Commissioner

Frank Carollo

D4 Commissioner

Francis Suarez

Vice Chairman / D5 Commissioner

Keon Hardemon

City Manager

Daniel J. Alfonso

# CITY OF MIAMI

## CAPITAL IMPROVEMENTS PROGRAM

JEOVANNY RODRIGUEZ, P.E., DIRECTOR

BRICKELL AVENUE PROJECT - SECTION ONE  
FROM SE 15 ROAD TO SE 8 STREET  
PROJECT No. B-30874



### INDEX OF SHEETS

SHEET NO.	DESCRIPTION
1	COVER SHEET
2	GENERAL NOTES
3	TYPICAL SECTION AND QUANTITIES
4-5	DETAILS
6-11	ROADWAY PLANS
12	TRAFFIC CONTROL GENERAL NOTES
13-15	STORM WATER POLLUTION PREVENTION PLAN

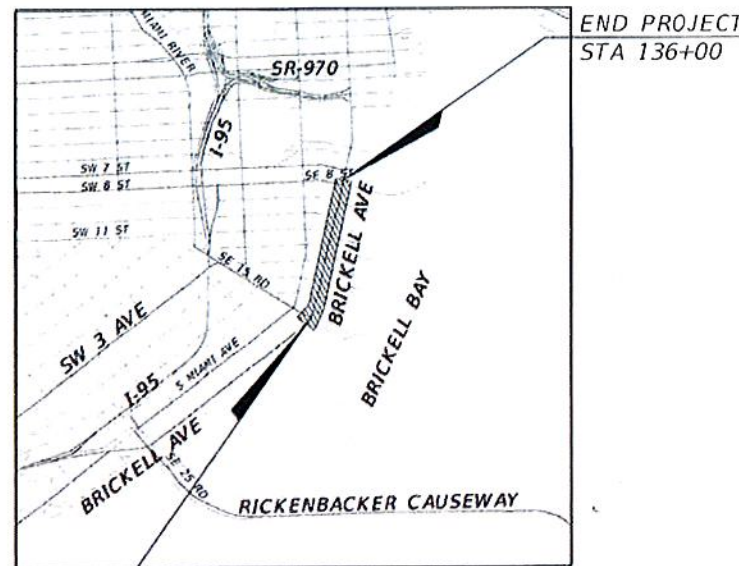

BEGIN PROJECT  
STA 105+00

END PROJECT  
STA 136+00

LOCATION MAP  
SCALE: 1" = 4,000'

ROADWAY SHOP DRAWINGS  
TO BE SUBMITTED TO:

CLAUDIA P. DIAZ, P.E.  
201 ALHAMBRA CIRCLE SUITE 900  
CORAL GABLES, FL 33134

PLANS PREPARED BY:

**T.Y. LIN INTERNATIONAL**  
201 ALHAMBRA CIRCLE SUITE 900  
CORAL GABLES, FLORIDA 33134  
PHONE: (305) 567-1888  
FAX: (305) 567-1771  
EB00002017

100% SUBMITTAL SECTION ONE  
OCTOBER 16, 2015

**APPROVED** AS NOTED

OCT 27 2015

TRAFFIC ENGINEERING DIVISION  
MIAMI-DADE PUBLIC WORKS & WASTE MGMT

NOTE: THE SCALE OF THESE PLANS MAY BE  
CHANGED DUE TO REPRODUCTION

ROADWAY PLANS  
ENGINEER OF RECORD

P.E. NO.:

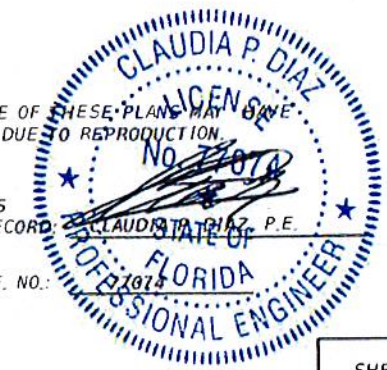

GOVERNING STANDARDS AND SPECIFICATIONS:

- FLORIDA DEPARTMENT OF TRANSPORTATION, DESIGN STANDARDS  
DATED 2015, AND STANDARD SPECIFICATIONS FOR ROAD AND  
BRIDGE CONSTRUCTION DATED 2015, AS AMENDED BY CONTRACT  
DOCUMENTS

- CITY OF MIAMI ENGINEERING STANDARDS FOR  
DESIGN AND CONSTRUCTION DATED DECEMBER 2010



CITY OF MIAMI PROJECT MANAGER: Ivelisse Rodriguez

CITY OF MIAMI CONSTRUCTION MANAGER: XXXXX, P.E.

SHEET  
NO.

1

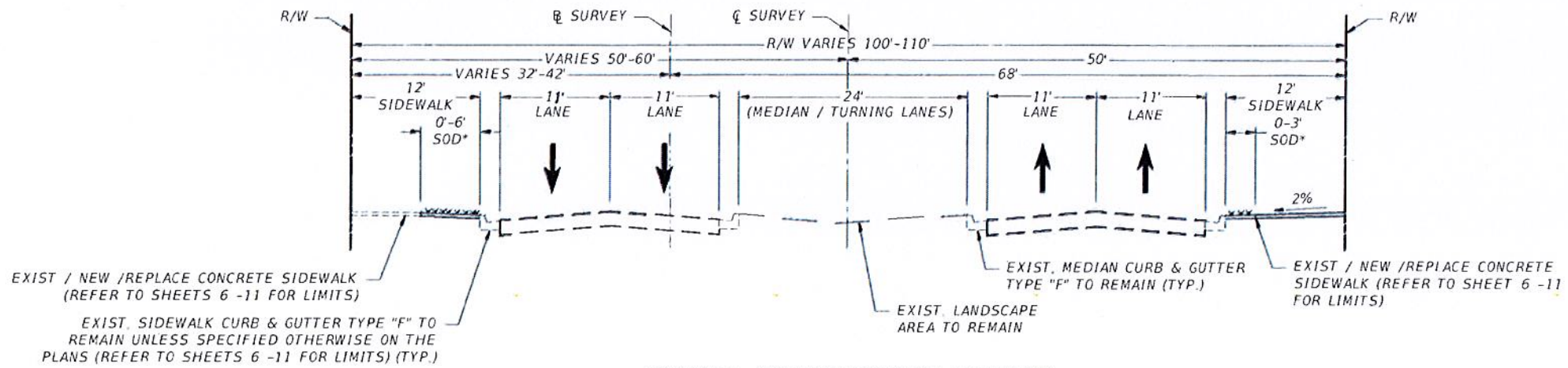

**BRICKELL AVENUE TYPICAL SECTION**  
FROM SE 15 ROAD TO SE 8 STREET  
N.T.S.

**NOTES**

\* STABILIZED SUBGRADE OF EXISTING SOD AREA AT LOCATIONS WHERE SIDEWALK WILL BE WIDEN.

**SIDE STREETS M&R:**

- MILL EXISTING ASPHALT PAVEMENT (1" AVG. DEPTH)
- RESURFACING WITH FRICTION COURSE FC-9.5 (TRAFFIC C) (1") (RUBBER)

**PAY ITEM NOTE:**

- 110-1-1 ALL DEMOLITION SHALL BE PAID UNDER CLEARING AND GRUBBING. CONTRACT SHALL INCLUDE IN THE BID PRICE FOR CLEARING AND GRUBBING OF THE FOLLOWING ITEMS: CONCRETE DRIVEWAY PADS, ASPHALTIC DRIVEWAY PADS, SIDEWALK FLAGS TO BE REPLACED AND CURB RAMPS.
- 520-1-10 INCLUDE REINFORCING STEEL COST.
- 350-3-7 CONCRETE REPLACEMENT (CROSSWALK) INCLUDE REMOVAL OF EXISTING CONCRETE/ASPHALT BASE TO ACCOMMODATE THE NEW 9" CONCRETE SLAB. CONTRACTOR SHALL MAINTAIN PATTERN CROSSWALK FOR A DURATION OF 5 YEARS AFTER.

**ROADWAY QUANTITIES**

PAY ITEM	PAY ITEM DESCRIPTION	UNIT	PLAN QUANTITY	FINAL QUANTITY
101-1	Mobilization	LS	1	
102-1	Maintenance of Traffic	LS	1	
110-1-1	Clearing and Grubbing	LS	1	
110-15-1	Arborist Work, Tree Trimming (root prune)	EA	1	
327-70-19	Milling Existing Asphalt Pavement (1" Average)	SY	540	
337-7-42	Friction Course Asphaltic Concrete, Traffic C, FC-9.5 (110lbs/sy-in.1" min.)	TN	30	
520-1-10	Concrete Curb Type "F"	LF	750	
522-1	Sidewalk Concrete, 4" Thick	SY	2,040	
522-2	Sidewalk Concrete, 6" Thick	SY	83	
527-2	Detectable Warnings	SF	114	
570-1-2	Performance Turf, Sod (sod restoration)	SY	73	
630-2-12	Conduit, F&I Directional Bore	LF	30	
635-2-11	Pull & Splice Box	EA	2	
660-2-106	Loop Assembly (Type F)	AS	5	
735-74-22	Pressure Clean concrete (sidewalk and lanes)	SY	97	
350-3-7	Plain Cement Concrete Pavement 9" (include Removal of Exist. Concrete Pavement)	SY	214	
	Root Barrier	EA	19	
	Type F-3 Catch Basin (including type removal of existing)	EA	1	

**SIGNING & PAVEMENT MARKING QUANTITIES**

PAY ITEM	PAY ITEM DESCRIPTION	UNIT	PLAN QUANTITY
706-3	Retro-Reflective Pavement Markers (Y/Y)	EA	431
706-3	Retro-Reflective Pavement Markers (W/R)	EA	4
711-111-23	Thermoplastic 12" Solid Traffic Stripe (White)	LF	534
711-111-25	Thermoplastic 24" Solid Traffic Stripe (White)	LF	122
711-112-24	Thermoplastic 18" Solid Traffic Stripe (Yellow)	LF	9.5
711-151-11	Thermoplastic 6" Solid Traffic Stripe (White)	NM	0.06
711-152-11	Thermoplastic 6" Solid Traffic Stripe (Yellow)	NM	0.04
711-11-200	Painted Pavement Markings - Island Nose (Yellow)	SF	417

<p>REVISIONS</p> <table border="1"> <thead> <tr> <th>DATE</th> <th>BY</th> <th>DESCRIPTION</th> </tr> </thead> <tbody> <tr> <td> </td> <td> </td> <td> </td> </tr> </tbody> </table>		DATE	BY	DESCRIPTION				<p>EOR</p> <p><b>CLAUDIA P. DUFFY</b> Professional Engineer No. 17074 No. 57074</p>	<p><b>CITY OF MIAMI</b> CAPITAL IMPROVEMENTS PROGRAM 444 SW 2ND AVENUE, 8TH FLOOR MIAMI, FLORIDA 33130 (305) 416-1213 FAX (305) 416-1253</p>	<p><b>CITY OF MIAMI</b> CAPITAL IMPROVEMENTS PROGRAM</p> <table border="1"> <tr> <td>PROJECT NAME</td> <td>PROJECT No.</td> </tr> <tr> <td>Brickell Avenue Project SECTION ONE SE 15 ROAD TO SE 8 STREET</td> <td>B-30874</td> </tr> </table>	PROJECT NAME	PROJECT No.	Brickell Avenue Project SECTION ONE SE 15 ROAD TO SE 8 STREET	B-30874	<p>TYPICAL SECTION AND QUANTITIES</p> <p>SHEET NO. 3</p>
DATE	BY	DESCRIPTION													
PROJECT NAME	PROJECT No.														
Brickell Avenue Project SECTION ONE SE 15 ROAD TO SE 8 STREET	B-30874														

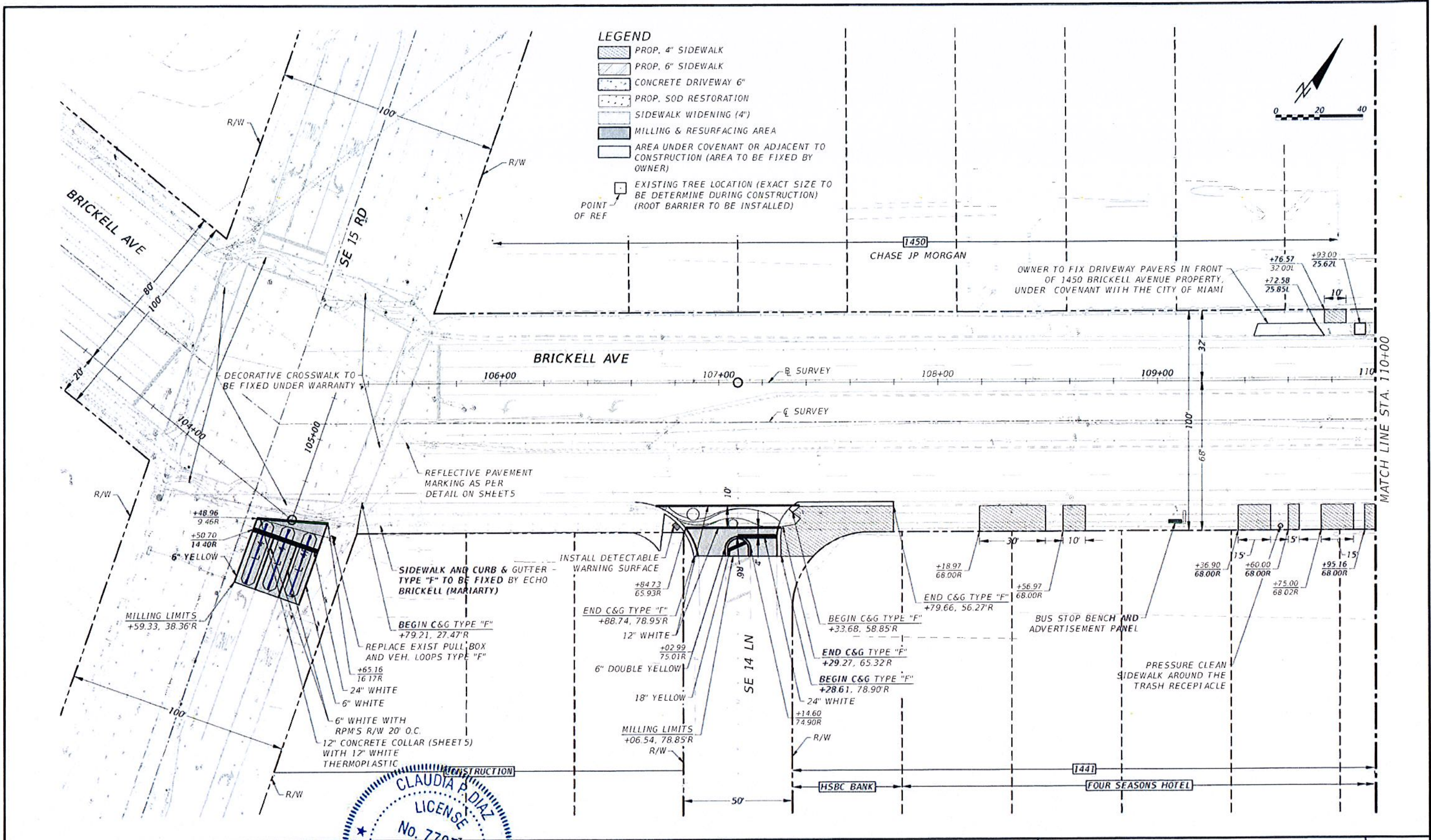

DATE	BY	REVISIONS DESCRIPTION

**CLAUDIA P. DIAZ**  
**LICENSE No. 77074**  
**PROFESSIONAL ENGINEER**  
**T.Y. LYNN**  
**PROFESSIONAL ENGINEER**

**CITY OF MIAMI**  
**CAPITAL IMPROVEMENTS PROGRAM**  
 444 S.W. 2ND AVENUE, 8TH FLOOR  
 MIAMI, FLORIDA 33130  
 (305) 416-1213 FAX (305) 416-1253

**CITY OF MIAMI**  
**CAPITAL IMPROVEMENTS PROGRAM**  
 PROJECT NAME: Brickell Avenue Project SECTION ONE SE 15 ROAD TO SE 8 STREET  
 PROJECT No.: B-30874

**ROADWAY PLANS**

SHEET NO. **6**

100% PLANS SECTION ONE - NOT FOR CONSTRUCTION

- LEGEND**
- PROP. 4" SIDEWALK
  - PROP. 6" SIDEWALK
  - CONCRETE DRIVEWAY 6"
  - PROP. SOD RESTORATION
  - SIDEWALK WIDENING (4")
  - MILLING & RESURFACING AREA
  - AREA UNDER COVENANT OR ADJACENT TO CONSTRUCTION (AREA TO BE FIXED BY OWNER)
  - EXISTING TREE LOCATION (EXACT SIZE TO BE DETERMINE DURING CONSTRUCTION) (ROOT BARRIER TO BE INSTALLED)
  - POINT OF REF

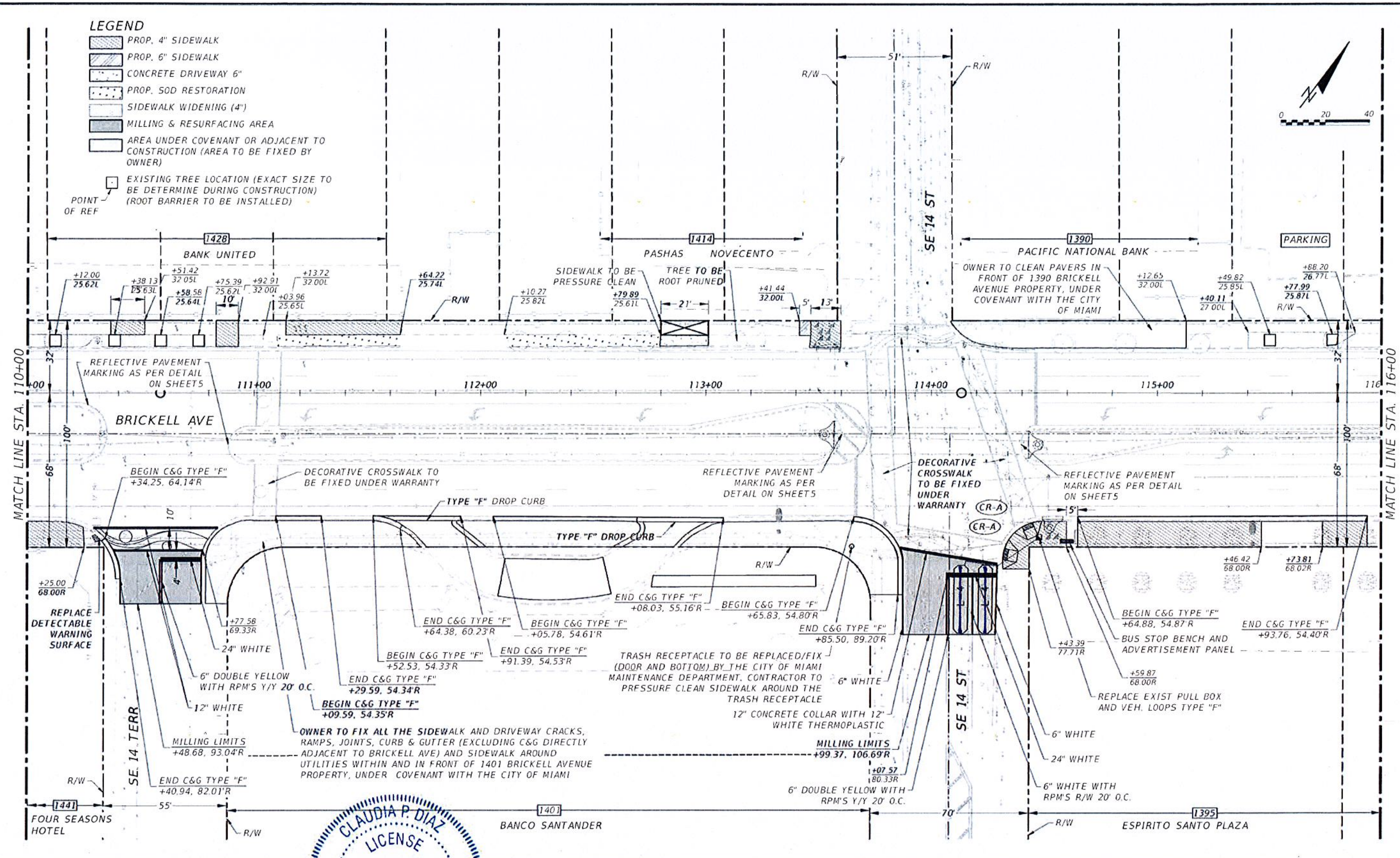
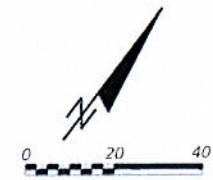

CLAUDIA P. DIAZ  
 LICENSE  
 No. 11074  
 State of Florida  
 PROFESSIONAL ENGINEER

**CITY OF MIAMI**  
 CAPITAL IMPROVEMENTS PROGRAM  
 444 S.W. 2ND AVENUE, 8TH FLOOR  
 MIAMI, FLORIDA 33130  
 (305) 416-1213 FAX (305) 416-1253

CITY OF MIAMI CAPITAL IMPROVEMENTS PROGRAM	
PROJECT NAME Brickell Avenue Project SECTION ONE SE 15 ROAD TO SE 8 STREET	PROJECT No. B-30874









ROADWAY PLANS

SHEET  
NO.  
7

REVISIONS		
DATE	BY	DESCRIPTION

100% PLANS SECTION ONE - NOT FOR CONSTRUCTION

**LEGEND**

-  PROP. 4" SIDEWALK
-  PROP. 6" SIDEWALK
-  CONCRETE DRIVEWAY 6"
-  PROP. SOD RESTORATION
-  SIDEWALK WIDENING (4")
-  MILLING & RESURFACING AREA
-  AREA UNDER COVENANT OR ADJACENT TO CONSTRUCTION (AREA TO BE FIXED BY OWNER)
-  EXISTING TREE LOCATION (EXACT SIZE TO BE DETERMINE DURING CONSTRUCTION) (ROOT BARRIER TO BE INSTALLED)
-  POINT OF REF

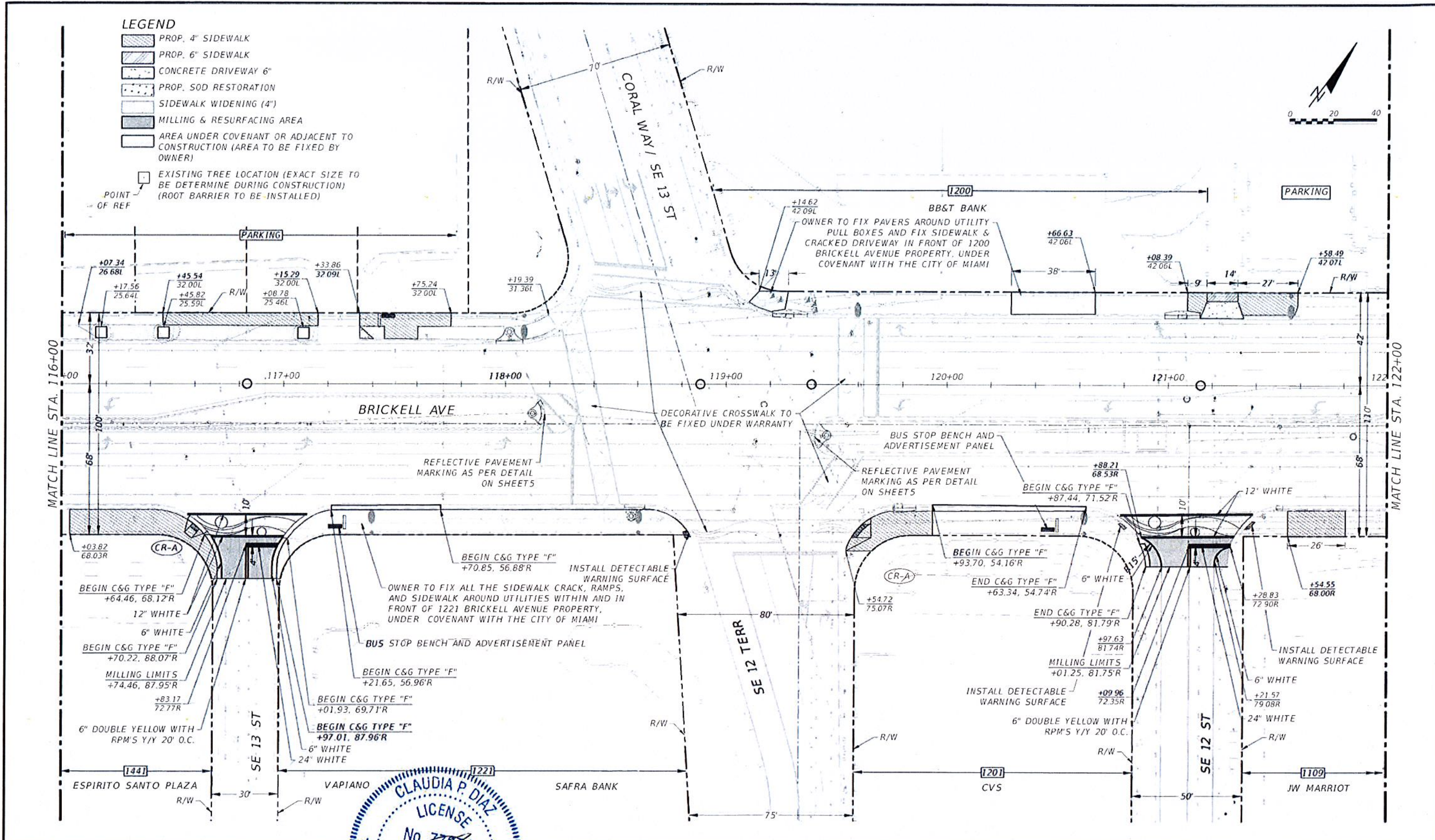
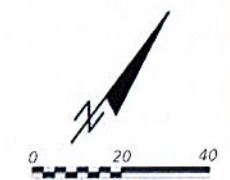

100% PLANS SECTION ONE - NOT FOR CONSTRUCTION

REVISIONS		EOR		CITY OF MIAMI CAPITAL IMPROVEMENTS PROGRAM		SHEET NO.
DATE	BY			DESCRIPTION	PROJECT NAME	
				Brickell Avenue Project SECTION ONE SE 15 ROAD TO SE 8 STREET	B-30874	8

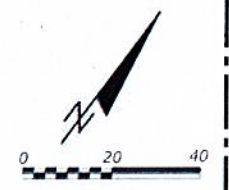
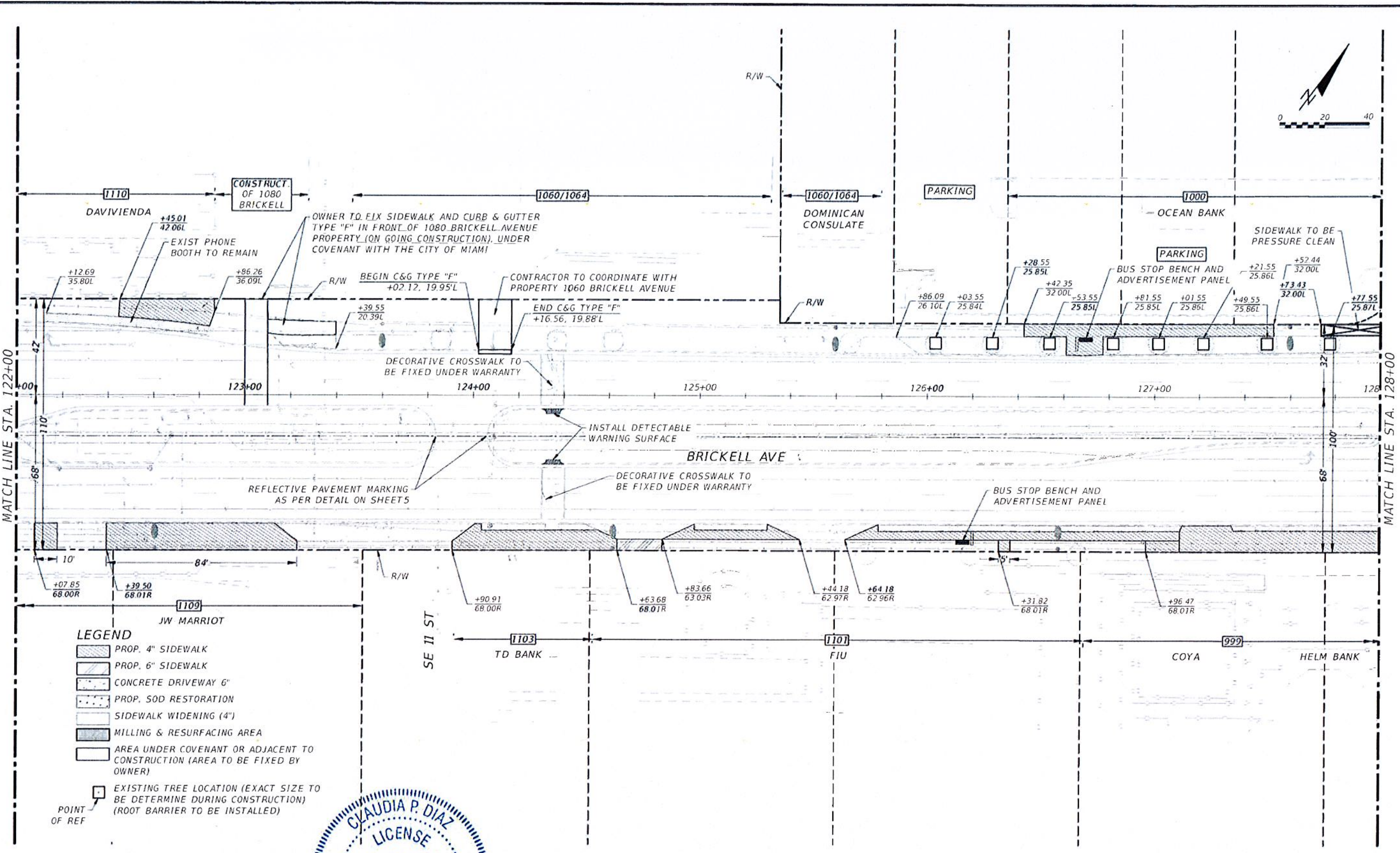

- LEGEND**
- PROP. 4" SIDEWALK
  - PROP. 6" SIDEWALK
  - CONCRETE DRIVEWAY 6"
  - PROP. SOD RESTORATION
  - SIDEWALK WIDENING (4")
  - MILLING & RESURFACING AREA
  - AREA UNDER COVENANT OR ADJACENT TO CONSTRUCTION (AREA TO BE FIXED BY OWNER)
  - EXISTING TREE LOCATION (EXACT SIZE TO BE DETERMINE DURING CONSTRUCTION) (ROOT BARRIER TO BE INSTALLED)
  - POINT OF REF



REVISIONS		FOR	
DATE	BY		DESCRIPTION

**CITY OF MIAMI**  
 CAPITAL IMPROVEMENTS PROGRAM  
 444 SW 2ND AVENUE, 8TH FLOOR  
 MIAMI, FLORIDA 33130  
 (305) 416-1213 FAX (305) 416-1253

CITY OF MIAMI CAPITAL IMPROVEMENTS PROGRAM	
PROJECT NAME	PROJECT No
Brickell Avenue Project SECTION ONE SE 15 ROAD TO SE 8 STREET	B-30874

ROADWAY PLANS	
SHEET NO.	
9	

100% PLANS SECTION ONE - NOT FOR CONSTRUCTION