



CITY OF MIAMI

CAPITAL IMPROVEMENTS PROGRAM

MARY BRICKELL VILLAGE

DRAINAGE AND ROADWAY IMPROVEMENTS - PHASE 1

SW/SE 9th STREET FROM W 1st AVENUE TO SOUTH MIAMI AVENUE
 SW/SE 10th STREET FROM W 1st AVENUE TO SE 1st AVENUE (BRICKELL PLAZA)
 SW/SE 11th STREET FROM W 1st AVENUE TO SOUTH MIAMI AVENUE
 SW/SE 12th STREET FROM W 1st AVENUE TO SOUTH MIAMI AVENUE

CITY OF MIAMI PROJECT NUMBER: B-30637

JULY, 2015

PROJECT LOCATION

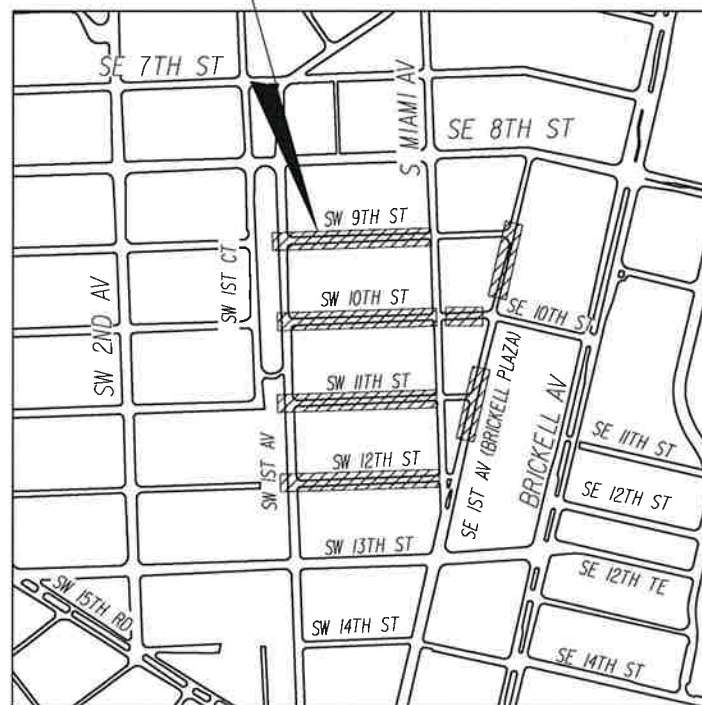

LOCATION MAP

COMMISSION

MAYOR: TOMAS P. REGALADO

COMMISSIONERS: WIFREDO GORT
 MARC SARNOFF
 FRANK CAROLLO
 FRANCIS SUAREZ
 KEON HARDEMON

CITY MANAGER: DANIEL J. ALFONSO

CIP DIRECTOR: MARK SPANIOLI

LENGTH OF PROJECT		
	LINEAR FEET	MILES
ROADWAY	3,051	0.58
BRIDGES	-	-
NET LENGTH OF PROJECT	3,051	0.58
EXCEPTIONS	-	-
GROSS LENGTH OF PROJECT	3,051	0.58

CITY OF MIAMI PROJECT MANAGER: JOSE LAGO, P.E.

INDEX OF ROADWAY PLANS

<u>SHEET No.</u>	<u>SHEET DESCRIPTION</u>
1	KEY SHEET
2	GENERAL NOTES, LEGEND & ABBREVIATIONS
2A	GENERAL NOTES, PAY ITEM NOTES & SUMMARY OF QUANTITIES
3	PROJECT LAYOUT
4	DRAINAGE MAP
5	TYPICAL SECTIONS S.W./S.E. 9th STREET
6	TYPICAL SECTIONS S.W./S.E. 10th STREET
7	TYPICAL SECTIONS S.W./S.E. 11th STREET & S.W. 12th STREET
8	TYPICAL SECTIONS S.E. 1st AVENUE (BRICKELL PLAZA)
9	SUMMARY OF DRAINAGE STRUCTURES AND VWH SUMMARY
10	EXISTING CONDITIONS S.W./S.E. 9th STREET
11	EXISTING CONDITIONS S.W./S.E. 10th STREET
12	EXISTING CONDITIONS S.W./S.E. 11th STREET
13	EXISTING CONDITIONS S.W. 12th STREET
14	ROADWAY PLAN S.W./S.E. 9th STREET
15	ROADWAY PLAN S.W./S.E. 10th STREET
16	ROADWAY PLAN S.W./S.E. 11th STREET
17	ROADWAY PLAN S.W. 12th STREET
18	RECONSTRUCTION PLAN S.W. 9th STREET
19	ROADWAY CONSTRUCTION STANDARDS DETAILS
20	DRAINAGE PROFILE S.W./S.E. 9th STREET
21	DRAINAGE PROFILE S.W. 10th STREET & S.W. 11th STREET
22	DRAINAGE PROFILE S.W. 12th STREET & S.E. 1st AVENUE
23	DRAINAGE STRUCTURES S.W. 9th STREET
24	DRAINAGE STRUCTURES S.E. 9th STREET
25-26	DRAINAGE SPECIAL DETAILS
27-29	DRAINAGE STANDARDS DETAILS
30	STORMWATER POLLUTION PREVENTION PLAN
31	PLANTING STANDARDS DETAILS
32	TRAFFIC CONTROL NOTES
33	SIGNING & PAVEMENT MARKING PLAN S.W./S.E. 9th STREET
34	SIGNING & PAVEMENT MARKING PLAN S.W./S.E. 10th STREET
35	SIGNING & PAVEMENT MARKING PLAN S.W. 11th STREET
36	SIGNING & PAVEMENT MARKING PLAN S.W. 12th STREET

APPROVED

JUL 10 2015

TRAFFIC ENGINEERING DIVISION
 MIAMI-DADE PUBLIC WORKS & WASTE MGMT

AS NOTED
ON SHEET 35

PLANS PREPARED BY:

T·Y·LIN INTERNATIONAL

EB00000407
 201 Alhambra Circle Suite 900
 Coral Gables, Florida. 33134
 Phone: 305/567-1888 Fax: 305/567-1771



For Frank

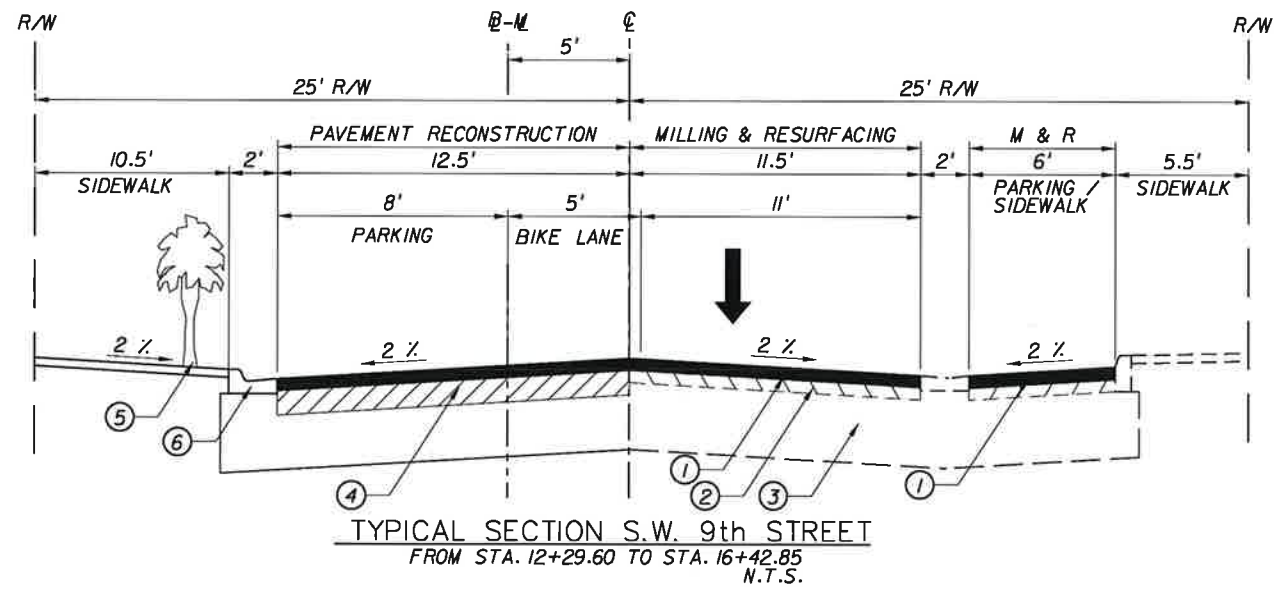
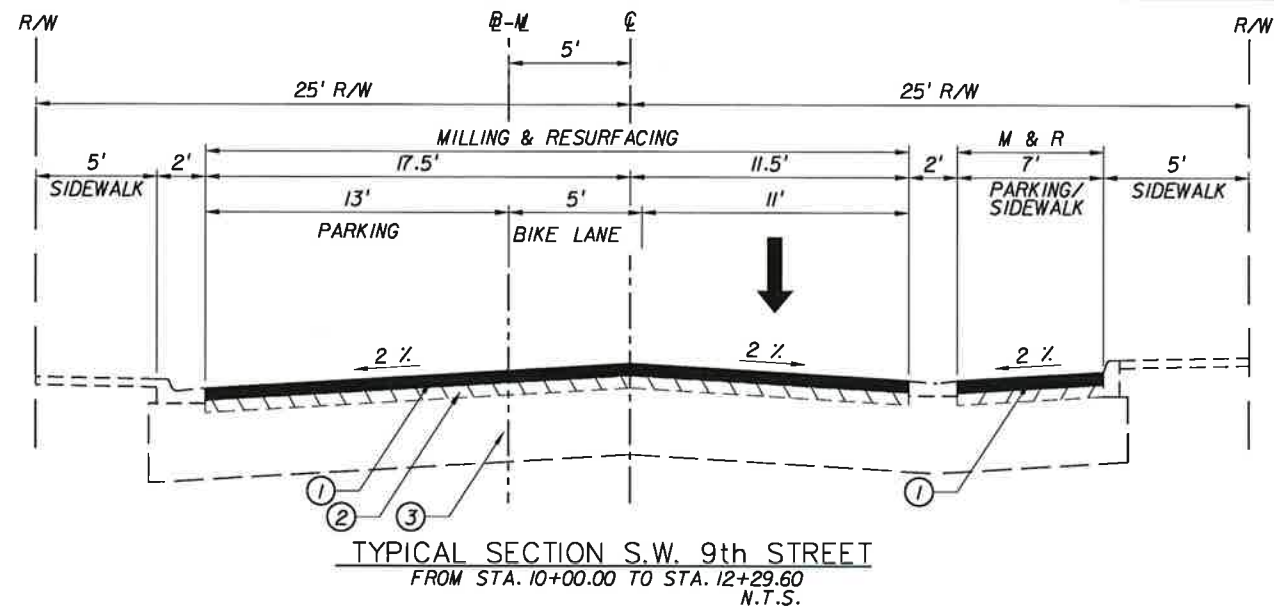

- ① PROPOSED MILLING & RESURFACING (MILL 1" AND RESURFACE WITH 1" OF SUPERPAVE ASPHALT PER DOT STANDARDS), REFER TO PLANS FOR LIMITS.
- ② EXISTING LIMEROCK BASE (8" MINIMUM THICKNESS)
- ③ EXISTING SUBGRADE.
- ④ RECONSTRUCT PAVEMENT SECTION PER CITY OF MIAMI PUBLIC WORKS STANDARD 35-85-37. REFER TO SHEET No. 17 AND No. 23.
- ⑤ REFER TO ROADWAY PLANS FOR PLANTER LOCATIONS.
- ⑥ PROPOSED CURB AND GUTTER TYPE "F", REFER TO ROADWAY PLANS FOR LOCATIONS.

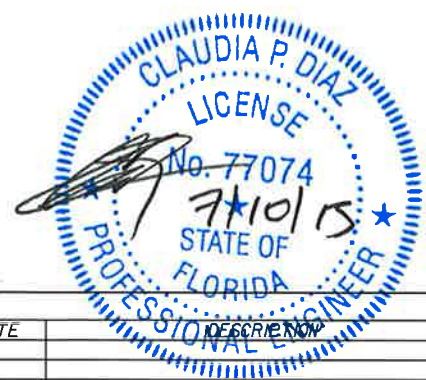

REVISIONS			
DATE	DESCRIPTION	DATE	DESCRIPTION

T·Y·LIN INTERNATIONAL
201 ALHAMBRA CIRCLE SUITE 900
Coral Gables, Florida. 33134
Phone: 305 / 567-1888 Fax: 305 / 567-1771



CITY OF MIAMI
MARY BRICKELL VILLAGE
DRAINAGE AND ROADWAY IMPROVEMENTS - PHASE I
SW/SE 9th STREET FROM W 1st AVENUE TO SOUTH MIAMI AVENUE
SW/SE 10th STREET FROM W 1st AVENUE TO SOUTH MIAMI AVENUE
SW/SE 11th STREET FROM W 1st AVENUE TO SOUTH MIAMI AVENUE
SW 12th STREET FROM W 1st AVENUE TO SOUTH MIAMI AVENUE
CITY OF MIAMI PROJECT NUMBER: B-30637

TYPICAL SECTION
S.W./S.E. 9th STREET

SHEET NO.
5

002: PLANS - NOT FOR CONSTRUCTION

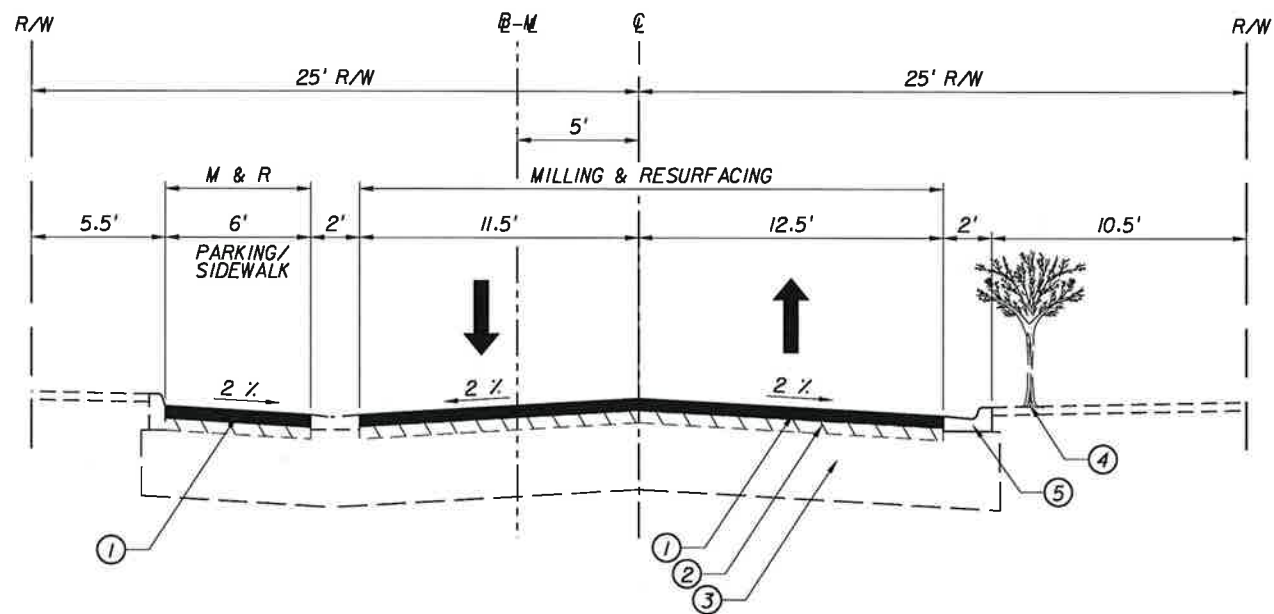

TYPICAL SECTION S.W. 10th STREET
FROM S.W. 1st AVENUE TO SOUTH MIAMI AVENUE
N.T.S.

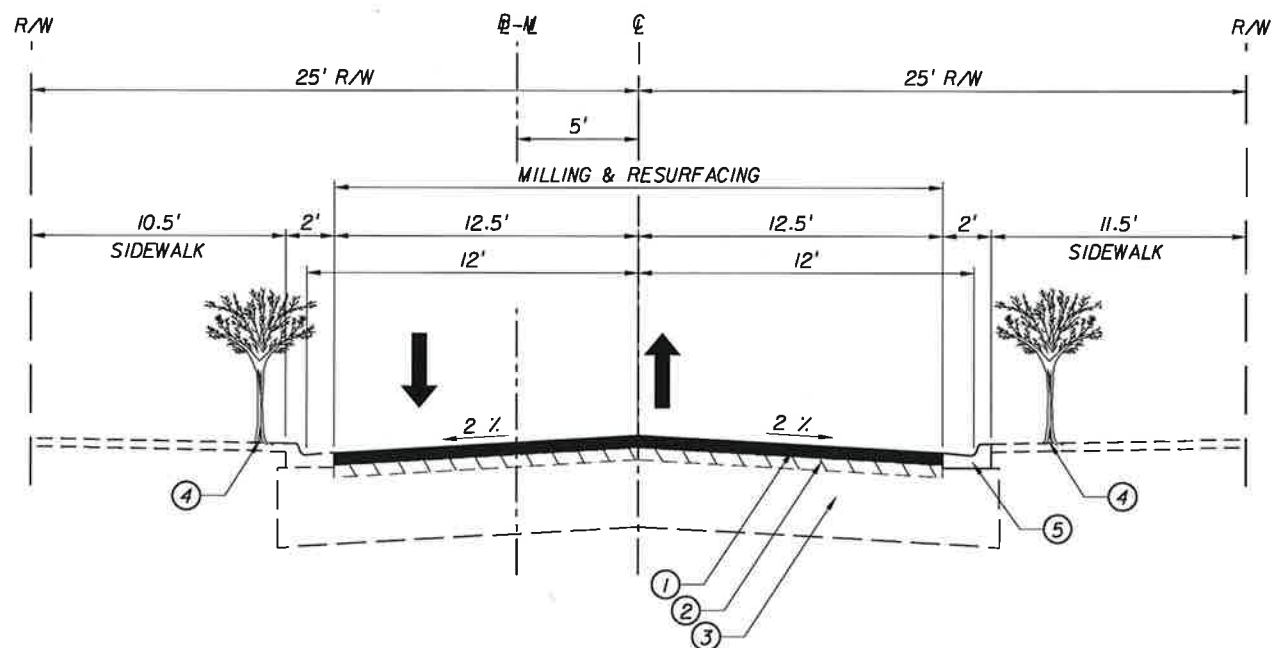

TYPICAL SECTION S.E. 10th STREET
FROM SOUTH MIAMI AVENUE TO
S.E. 1st AVENUE (BRICKELL PLAZA)
N.T.S.

- ① PROPOSED MILLING & RESURFACING (MILL 1" AND RESURFACING WITH 1" OF SUPERPAVE ASPHALT PER DOT STANDARDS), REFER TO PLANS FOR LIMITS.
- ② EXISTING LIMEROCK BASE (8" MINIMUM THICKNESS)
- ③ EXISTING SUBGRADE.
- ④ REFER TO ROADWAY PLANS FOR PLANTER LOCATIONS.
- ⑤ REPLACE CURB AND GUTTER TYPE "F", REFER TO ROADWAY PLANS FOR LOCATIONS.

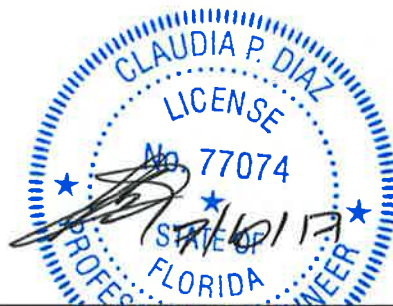

REVISIONS			
DATE	DESCRIPTION	DATE	DESCRIPTION

T·Y·LIN INTERNATIONAL
201 ALHAMBRA CIRCLE SUITE 900
Coral Gables, Florida. 33134
Phone: 305 / 567-1888 Fax: 305 / 567-1771



CITY OF MIAMI
MARY BRICKELL VILLAGE
DRAINAGE AND ROADWAY IMPROVEMENTS - PHASE I
SW/SE 9th STREET FROM W 1st AVENUE TO SOUTH MIAMI AVENUE
SW/SE 10th STREET FROM W 1st AVENUE TO SOUTH MIAMI AVENUE
SW/SE 11th STREET FROM W 1st AVENUE TO SOUTH MIAMI AVENUE
SW 12th STREET FROM W 1st AVENUE TO SOUTH MIAMI AVENUE
CITY OF MIAMI PROJECT NUMBER: B-30637

TYPICAL SECTION
S.W./S.E. 10th STREET

SHEET NO.

6

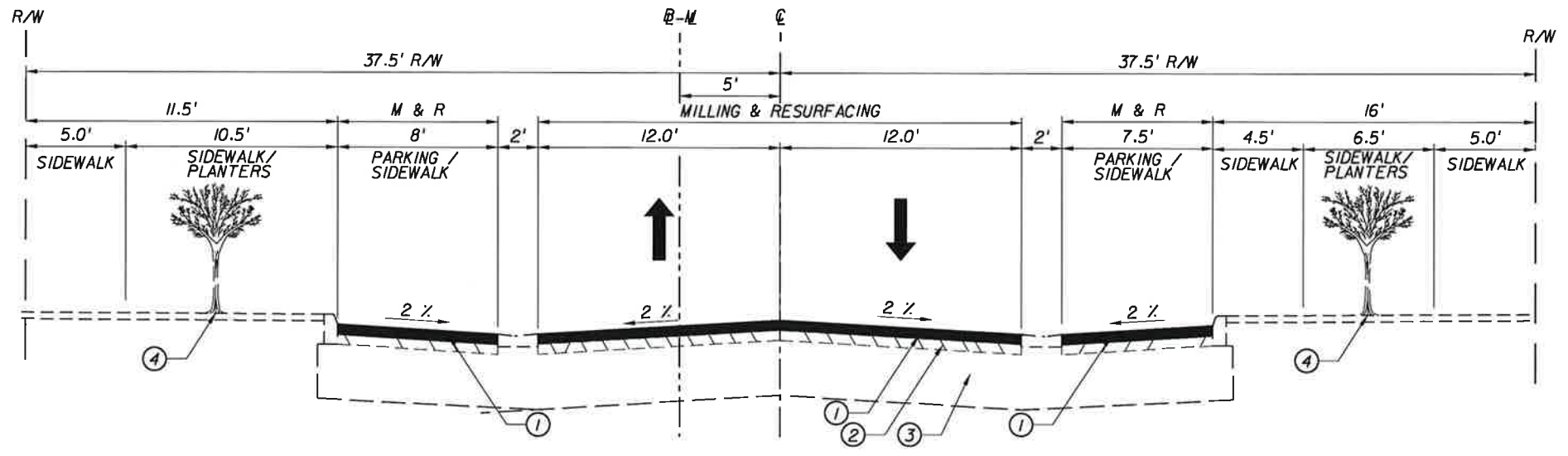

TYPICAL SECTION S.E. 1ST AVENUE
FROM 262.93' RIGHT TO 23' LEFT OF SW 9TH STREET
N.T.S.

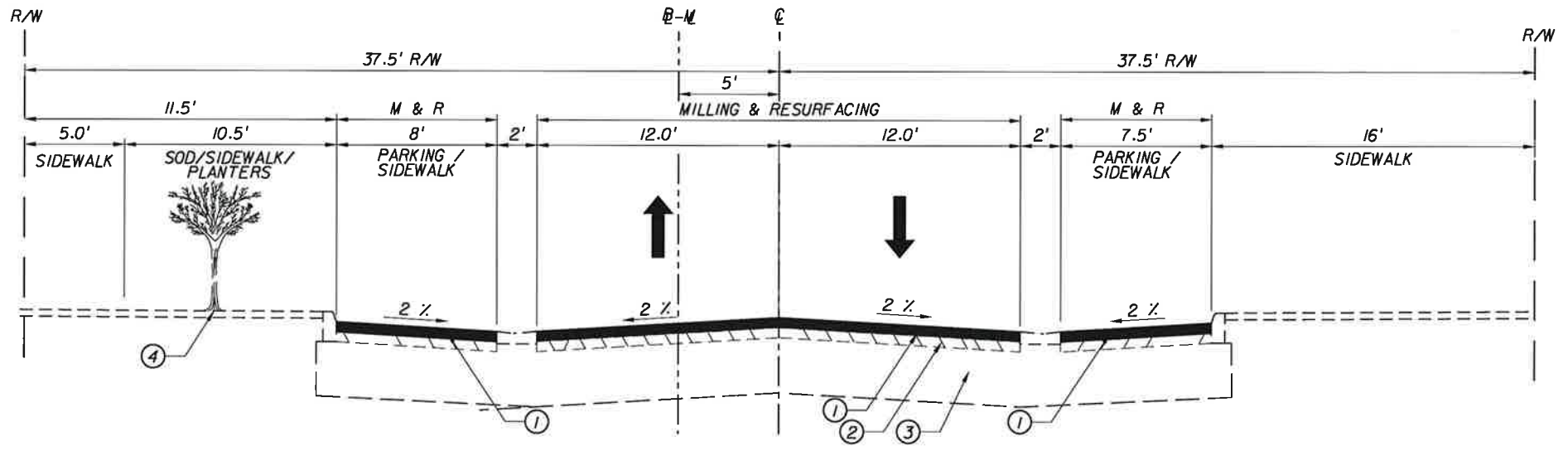

TYPICAL SECTION S.E. 1ST AVENUE
FROM 59.60' RIGHT TO 65.50' LEFT OF SW 11TH STREET
N.T.S.

- ① PROPOSED MILLING & RESURFACING (MILL 1" AND RESURFACING WITH 1" OF SUPERPAVE ASPHALT PER DOT STANDARDS), REFER TO PLANS FOR LIMITS.
- ② EXISTING LIMEROCK BASE (8" MINIMUM THICKNESS)
- ③ EXISTING SUBGRADE.
- ④ EXISTING PLANTER LOCATIONS

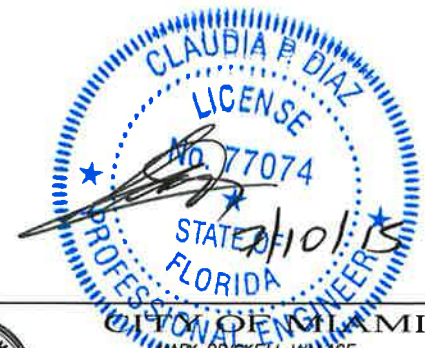

REVISIONS			
DATE	DESCRIPTION	DATE	DESCRIPTION

T·Y·LIN INTERNATIONAL
201 ALHAMBRA CIRCLE SUITE 900
Coral Gables, Florida. 33134
Phone: 305 / 567-1888 Fax: 305 / 567-1771



CITY OF MIAMI
MARY BRICKELL VILLAGE
DRAINAGE AND ROADWAY IMPROVEMENTS - PHASE I
SW/SE 9th STREET FROM W 1st AVENUE TO SOUTH MIAMI AVENUE
SW/SE 10th STREET FROM W 1st AVENUE TO SOUTH MIAMI AVENUE
SW/SE 11th STREET FROM W 1st AVENUE TO SOUTH MIAMI AVENUE
SW 12th STREET FROM W 1st AVENUE TO SOUTH MIAMI AVENUE
CITY OF MIAMI PROJECT NUMBER: B-30637

TYPICAL SECTION
S.E. 1st AVENUE
(BRICKELL PLAZA)

SHEET NO.
8

000: PLANS - NOT FOR CONSTRUCTION

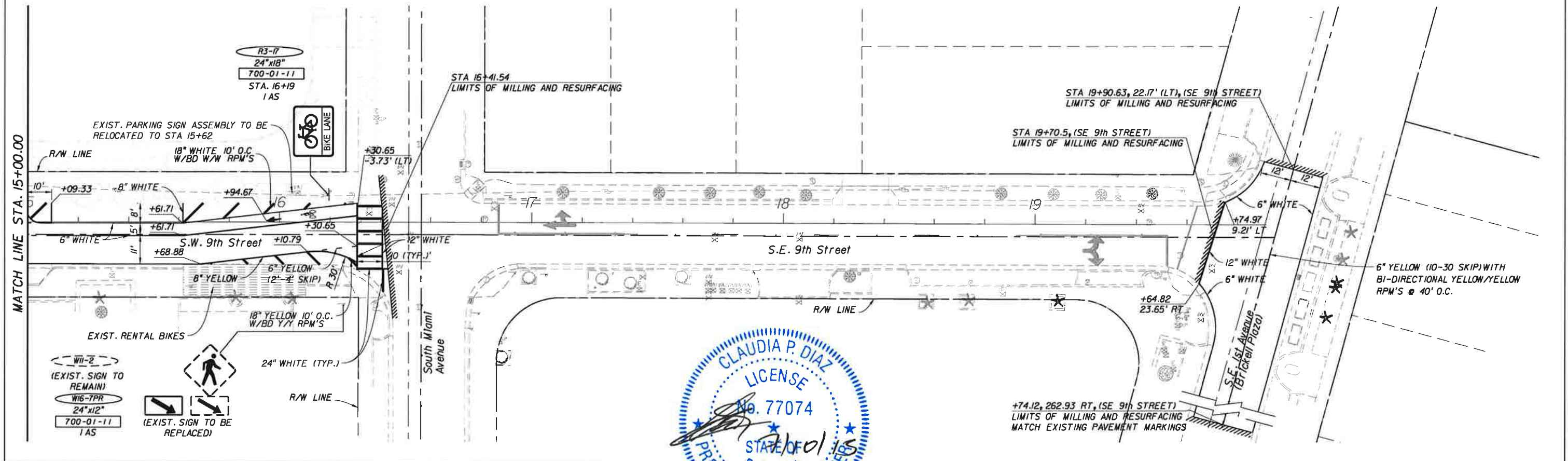
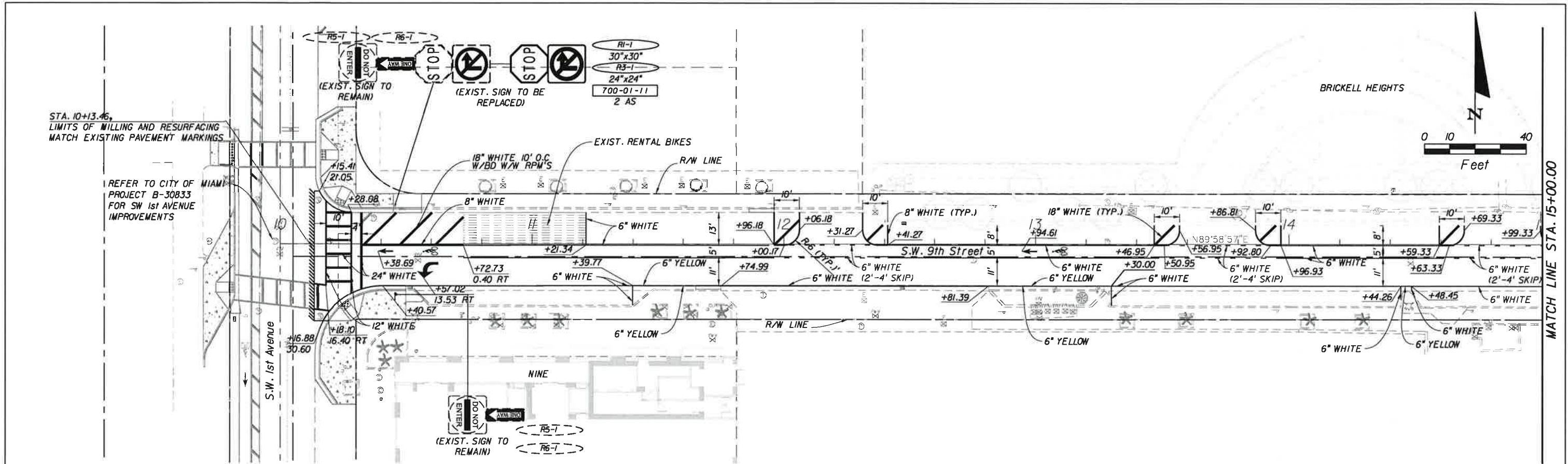

REVISIONS			
DATE	DESCRIPTION	DATE	DESCRIPTION

T·Y·LIN INTERNATIONAL
 201 ALHAMBRA CIRCLE SUITE 900
 Coral Gables, Florida 33134
 Phone: 305 / 567-1888 Fax: 305 / 567-1771

CITY OF MIAMI
 MARY BRICKELL VILLAGE
 DRAINAGE AND ROADWAY IMPROVEMENTS - PHASE I
 SW/SE 9th STREET FROM W 1st AVENUE TO SOUTH MIAMI AVENUE
 SW/SE 10th STREET FROM W 1st AVENUE TO SOUTH MIAMI AVENUE
 SW/SE 11th STREET FROM W 1st AVENUE TO SOUTH MIAMI AVENUE
 SW 12th STREET FROM W 1st AVENUE TO SOUTH MIAMI AVENUE
 CITY OF MIAMI PROJECT NUMBER: B-30637

SIGNING & PAVEMENT MARKING PLAN
S.W./S.E. 9th STREET

SHEET NO.
33

100% PLANS - NOT FOR CONSTRUCTION

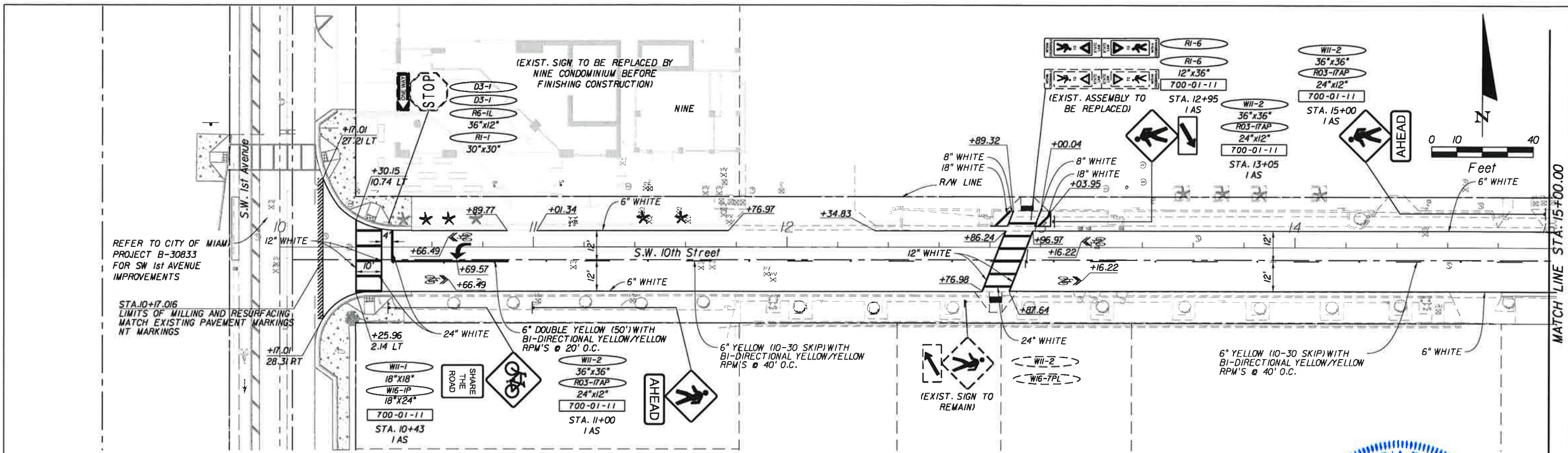

REFER TO CITY OF MIAMI PROJECT B-30833 FOR SW 1st AVENUE IMPROVEMENTS

STA. 10+17.016 LIMITS OF MILLING AND RESURFACING MATCH EXISTING PAVEMENT MARKINGS NT MARKINGS

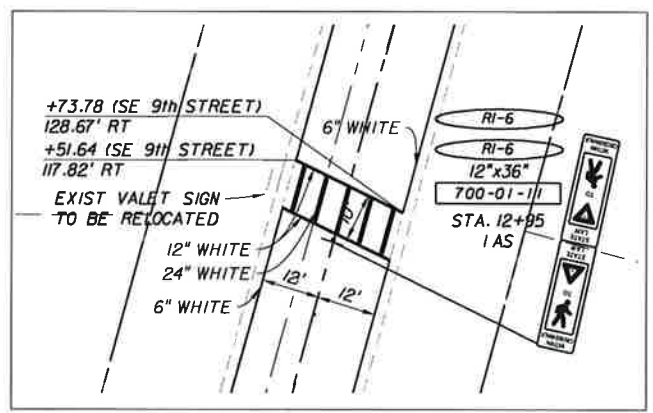
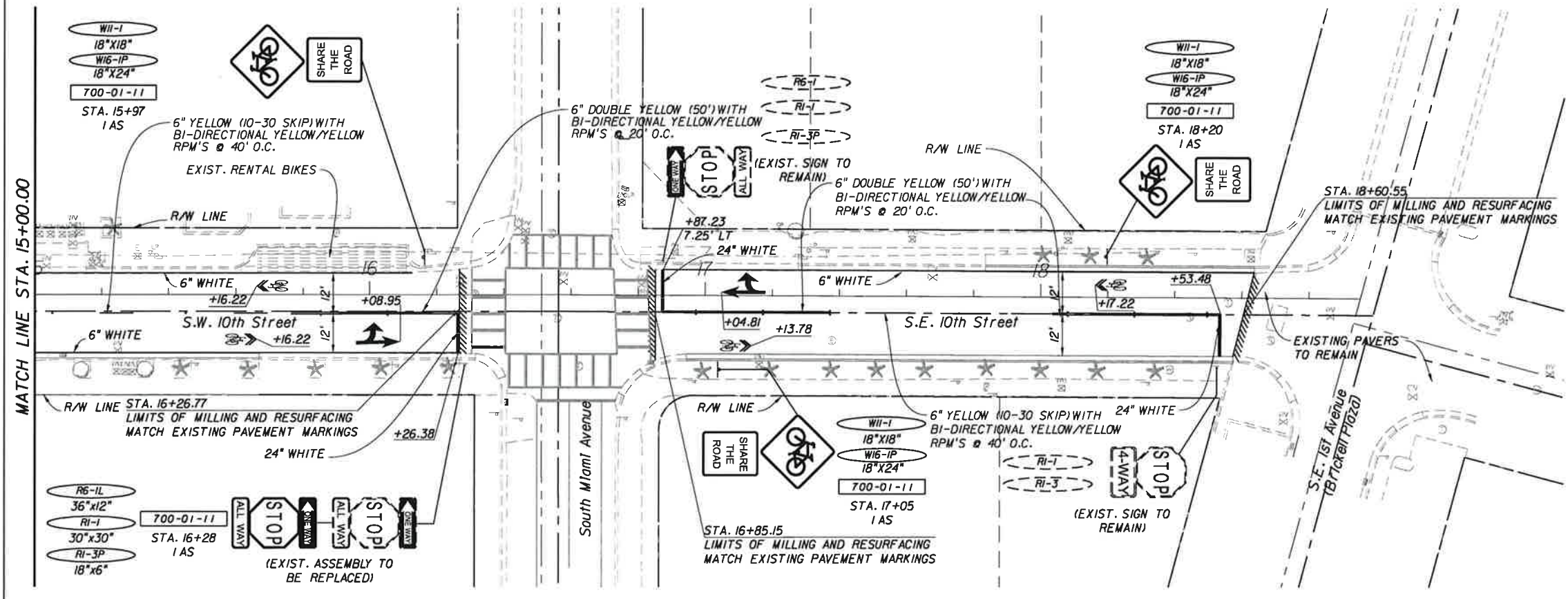
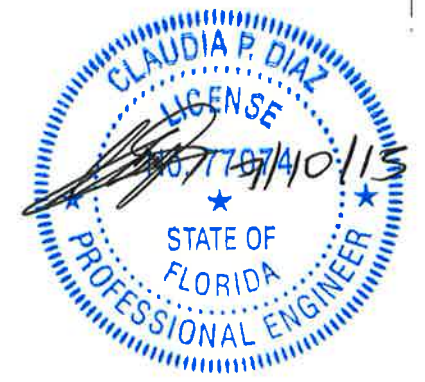

SF 1st AVENUE CROSSWALK BETWEEN SF 9th & 10th STREET

REVISIONS			
DATE	DESCRIPTION	DATE	DESCRIPTION

T·Y·LIN INTERNATIONAL
 201 ALHAMBRA CIRCLE SUITE 900
 Coral Gables, Florida. 33134
 Phone: 305 / 567-1888 Fax: 305 / 567-1771

CITY OF MIAMI
 MARY BRICKELL VILLAGE
 DRAINAGE AND ROADWAY IMPROVEMENTS - PHASE I
 SW/SE 9th STREET FROM W 1st AVENUE TO SOUTH MIAMI AVENUE
 SW/SE 10th STREET FROM W 1st AVENUE TO SOUTH MIAMI AVENUE
 SW/SE 11th STREET FROM W 1st AVENUE TO SOUTH MIAMI AVENUE
 SW 12th STREET FROM W 1st AVENUE TO SOUTH MIAMI AVENUE
 CITY OF MIAMI PROJECT NUMBER: B-30637

SIGNING & PAVEMENT MARKING PLAN
S.W./S.E. 10th STREET

SHEET NO. **34**

CANNOT HAVE AN 18' LANE. SINCE NO FIRE DEPARTMENT EXCEPTION LETTER HAS BEEN OBTAINED, PLACE A BICYCLE LANE HERE AS YOU CANNOT ALLOW PARKING ON THE RIGHT SIDE.

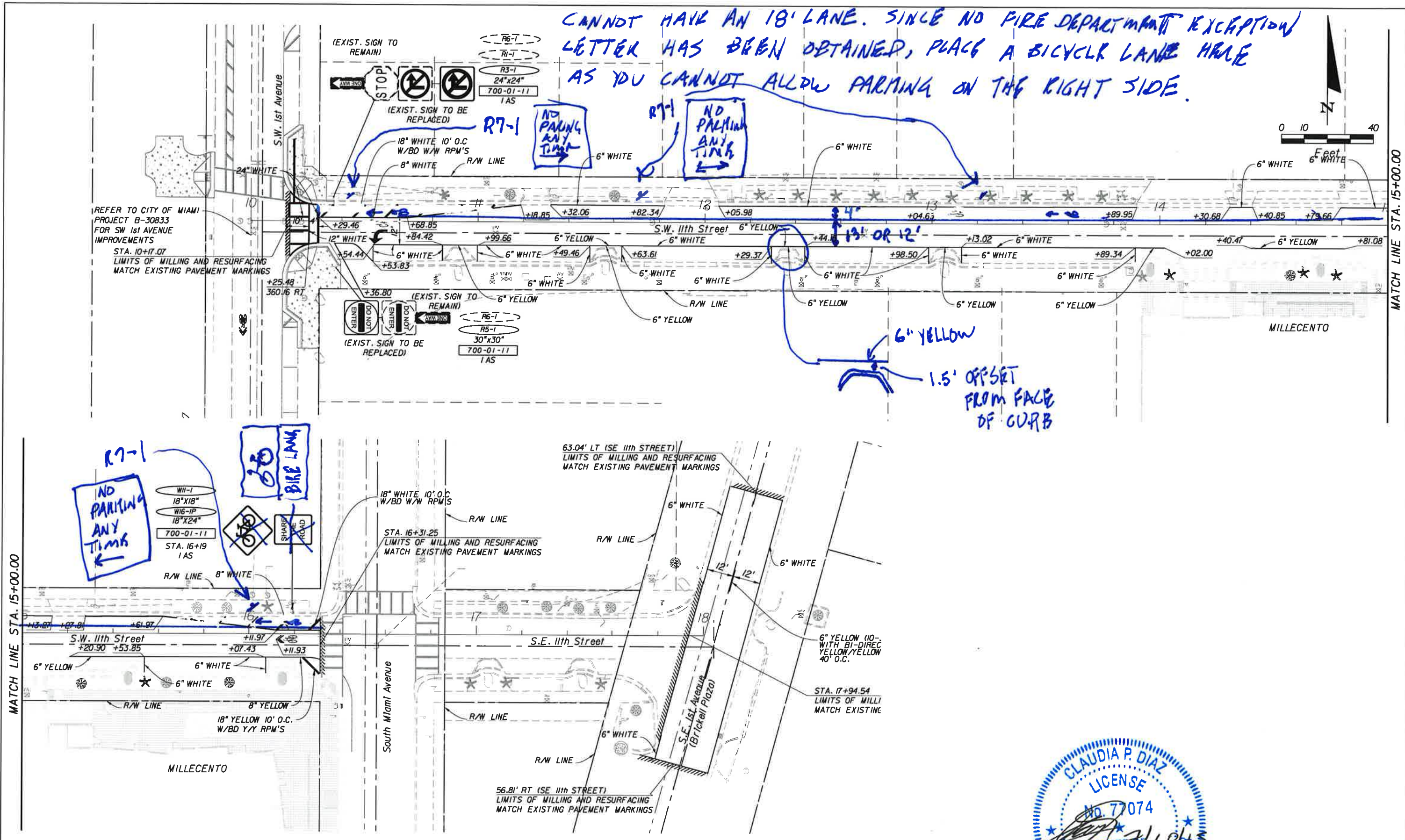

R7-1
NO PARKING ANY TIME
BIKE LANE

CLAUDIA P. DIAZ
 LICENSE
 No. 77074
 STATE OF FLORIDA
 PROFESSIONAL ENGINEER

REVISIONS			
DATE	DESCRIPTION	DATE	DESCRIPTION

T·Y·LIN INTERNATIONAL
 201 ALHAMBRA CIRCLE SUITE 900
 Coral Gables, Florida. 33134
 Phone: 305 / 567-1888 Fax: 305 / 567-1771



CITY OF MIAMI
 MARY BRICKELL VILLAGE
 DRAINAGE AND ROADWAY IMPROVEMENTS - PHASE
 SW/SE 9th STREET FROM W 1st AVENUE TO SOUTH MIAMI AVENUE
 SW/SE 10th STREET FROM W 1st AVENUE TO SOUTH MIAMI AVENUE
 SW/SE 11th STREET FROM W 1st AVENUE TO SOUTH MIAMI AVENUE
 SW/SE 12th STREET FROM W 1st AVENUE TO SOUTH MIAMI AVENUE
 CITY OF MIAMI PROJECT NUMBER: B-30637

PAVEMENT MARKING PLAN
S.W./S.E. 11th STREET

SHEET NO.
35

100% PLANS - NOT FOR CONSTRUCTION

REFER TO CITY OF MIAMI PROJECT B-30833 FOR SW 1st AVENUE IMPROVEMENTS

STA. 10+25.42, 500' RT LIMITS OF MILLING AND RESURFACING

(EXIST. SIGN TO REMAIN)



(EXIST. SIGN TO BE REPLACED)

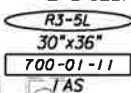

6" DOUBLE YELLOW (50') WITH BI-DIRECTIONAL YELLOW/YELLOW RPM'S @ 20' O.C.

(EXIST. SIGN TO REMAIN)

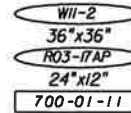

6" YELLOW (10-30 SKIP) WITH BI-DIRECTIONAL YELLOW/YELLOW RPM'S @ 40' O.C.

STA. 13+82 IAS

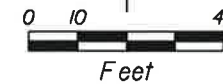

MATCH LINE STA. 15+00.00

12" WHITE

+31.52 7-24 LT

6" WHITE

+67.57

6" WHITE

+99.70

+48.21

+46.25

6" WHITE

+96.25

+18.56

+67.57

+99.70

+31.54 22.89 RT

6" WHITE

+67.57

+67.57

12" WHITE

+99.70

W11-1 18"X18" W16-1P 18"X24" 700-01-11 IAS STA. 10+39 IAS



AHEAD



W11-2 36"X36" R03-17AP 24"X12" 700-01-11 IAS STA. 10+82 IAS

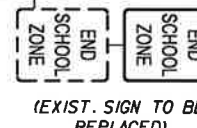

W11-2 36"X36" R03-17AP 24"X12" 700-01-11 IAS STA. 11+82 IAS

W11-1 18"X18" W16-1P 18"X24" 700-01-11 IAS STA. 16+08 IAS

STA. 16+25.39 LIMITS OF MILLING AND RESURFACING

6" DOUBLE YELLOW (100') WITH BI-DIRECTIONAL YELLOW/YELLOW RPM'S @ 20' O.C.



SHARE THE ROAD

6" WHITE

6" WHITE

24" WHITE

R/W LINE

R/W LINE

+04.08

+49.72

+23.18

South Miami Avenue

S.E. 1st Avenue (Brickell Plaza)

STOP STOP (EXIST. SIGN TO BE REPLACED)

RI-1 30"X30" 700-01-11 IAS

STOP STOP (EXIST. SIGN TO BE REPLACED)

STOP STOP (EXIST. SIGN TO BE REPLACED)

STOP STOP (EXIST. SIGN TO BE REPLACED)

STOP STOP (EXIST. SIGN TO BE REPLACED)

STOP STOP (EXIST. SIGN TO BE REPLACED)

STOP STOP (EXIST. SIGN TO BE REPLACED)

REVISIONS

DATE	DESCRIPTION	DATE	DESCRIPTION

T·Y·LIN INTERNATIONAL
 201 ALHAMBRA CIRCLE SUITE 900
 Coral Gables, Florida. 33134
 Phone: 305 / 567-1888 Fax: 305 / 567-1771



CITY OF MIAMI
 MARY BRICKELL VILLAGE
 DRAINAGE AND ROADWAY IMPROVEMENTS - PHASE I
 SW/SE 9th STREET FROM W 1st AVENUE TO SOUTH MIAMI AVENUE
 SW/SE 10th STREET FROM W 1st AVENUE TO SOUTH MIAMI AVENUE
 SW/SE 11th STREET FROM W 1st AVENUE TO SOUTH MIAMI AVENUE
 SW 12th STREET FROM W 1st AVENUE TO SOUTH MIAMI AVENUE
 CITY OF MIAMI PROJECT NUMBER: B-30637



SIGNING & RAVEMENT MARKING PLAN
 S.W. 12th STREET

SHEET NO. 36

100% PLANS - NOT FOR CONSTRUCTION