

Commission:

Mayor

Tomas P. Regalado

Chairman / D1 Commissioner

Wifredo (Willy) Gort

Vice Chairman / D5 Commissioner

Keon Hardemon

D2 Commissioner

Marc Sarnoff

D3 Commissioner

Frank Carollo

D4 Commissioner

Francis Suarez

City Manager

Daniel J. Alfonso

CITY OF MIAMI
CAPITAL IMPROVEMENTS PROGRAM

JEOVANNY RODRIGUEZ, P.E., DIRECTOR

SW 1st AVE
FROM SW 7th ST TO SW 15th RD
MILLING AND RESURFACING IMPROVEMENTS
PROJECT No. B-30833

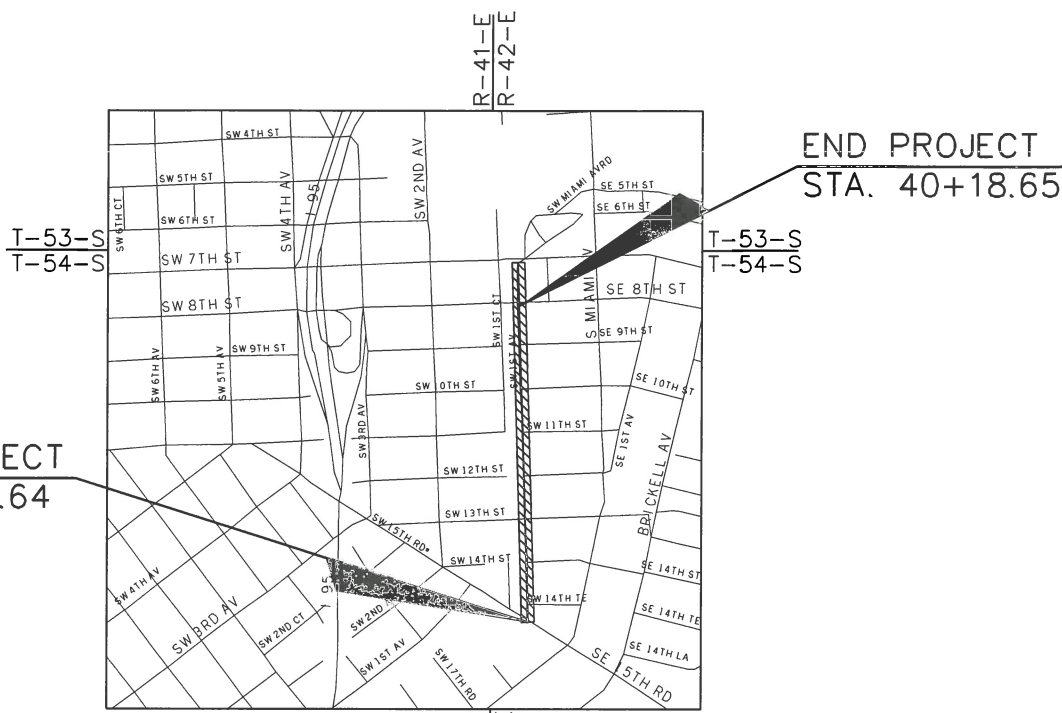
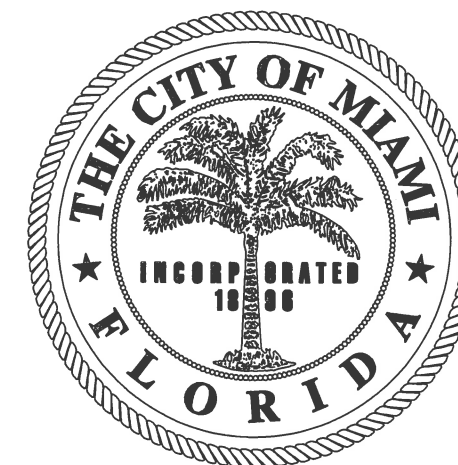

INDEX OF SHEETS

SHEET NO.	DESCRIPTION
1	KEY SHEET
2	SUMMARY OF PAY ITEMS
3 - 4	TYPICAL SECTION
5	DRIVEWAY DETAILS
6 - 7	GENERAL NOTES
8 - 13	ROADWAY PLAN
14 - 19	GRADING & DRAINAGE PLAN
20	TEMPORARY TRAFFIC CONTROL PLAN NOTES
21 - 29	TEMPORARY TRAFFIC CONTROL PLAN
30 - 35	UTILITY ADJUSTMENTS
36 - 37	SWPPP NOTES AND DETAILS
S-1 - S-6	SIGNING & PAVEMENT MARKINGS

TOPOGRAPHIC SURVEY

1 - 2 MAP OF TOPOGRAPHIC SURVEY

APPROVED

MAR 17 2016

TRAFFIC ENGINEERING DIVISION
MIAMI-DADE PUBLIC WORKS & WASTE MGMT

FOR SIGNING AND MARKING ONLY. SIGNAL LOOP PERMIT TO BE PULLED SEPARATELY.

GOVERNING STANDARDS AND SPECIFICATIONS:
- CITY OF MIAMI ENGINEERING STANDARDS FOR DESIGN AND CONSTRUCTION DATED DECEMBER 2010.
- FLORIDA DEPARTMENT OF TRANSPORTATION, DESIGN STANDARDS DATED 2015, AND STANDARD SPECIFICATIONS FOR ROAD AND BRIDGE CONSTRUCTION DATED 2015, AS AMENDED BY CONTRACT DOCUMENTS.

BEGIN PROJECT
STA. 10+61.64

END PROJECT
STA. 40+18.65

LOCATION MAP
SCALE : 1" = 1500'

ROADWAY SHOP DRAWINGS
TO BE SUBMITTED TO:

EITHEL M. SIERRA, P.E.
APCTE CORP
10305 N.W. 41 STREET, SUITE 115
MIAMI, FL 33178
(305) 592-7283

PLANS PREPARED BY:



A&P Consulting Transportation
Engineers Corporation
10305 N.W. 41 Street, Suite 115
Miami, FL 33178
(305) 592-7283 / fax: (305) 593-1594
Vendor No. : 65-0770583
CA No. : EB-0007797

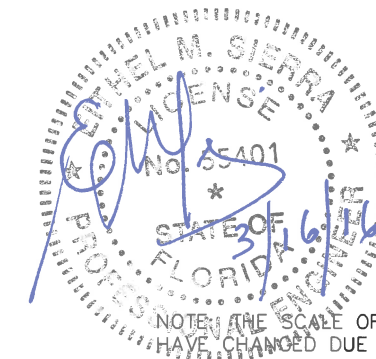

NOTE: THE SCALE OF THESE PLANS MAY
HAVE CHANGED DUE TO REPRODUCTION.

ROADWAY PLANS
ENGINEER OF RECORD: EITHEL M. SIERRA, P.E.

P.E. NO.: 55401

LENGTH OF PROJECT		
	LINEAR FEET	MILES
ROADWAY	2957.01	0.560
BRIDGES		
NET LENGTH OF PROJECT	2957.01	0.560
EXCEPTIONS		
GROSS LENGTH OF PROJECT	2957.01	0.560

CITY OF MIAMI PROJECT MANAGER: ORLANDO MISAS

CITY OF MIAMI CONSTRUCTION MANAGER: DAVID ADATO, P.E.

SHEET NO.
1

BEGIN PROJECT
 BEGING SIGNING & PAVEMENT MARKINGS
 STA. 10+40.00
 (MATCH EXIST.)

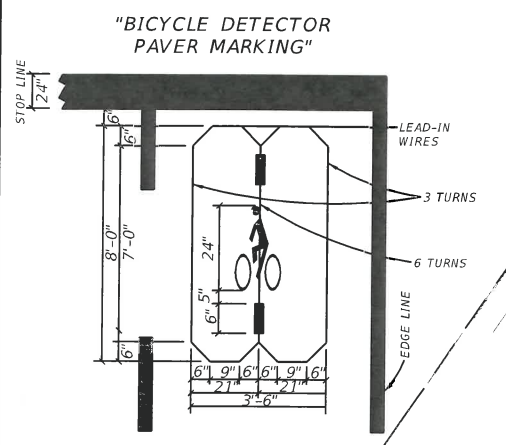
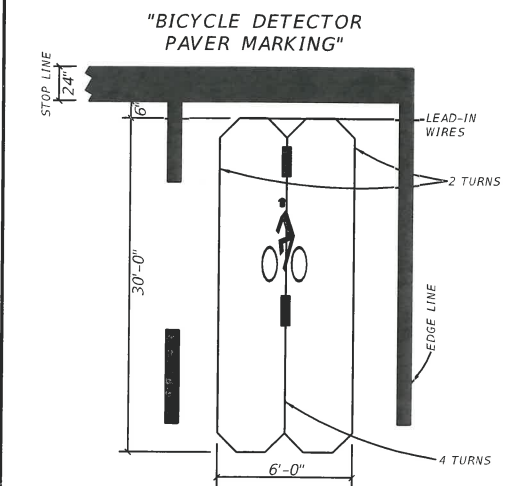
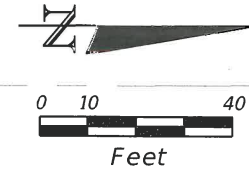

- 660-1-101 1 EA
 - 660-2-101 1 AS
 - 660-2-106 2 AS
- CONNECT TO EXIST.
 LOOP WINDOW

PROP. NEW SIGN
 R10-22
 12" X 18"
 STA. 10+53.00
 700-1-11 1 AS

EXIST. SIGN
 (TO BE REMOVED)
 PROP. NEW SIGN
 R2-1
 24" X 30"
 STA. 12+60.00
 700-1-60 1 AS
 700-1-11 1 AS

EXIST. SIGN
 (TO REMAIN)
 700-1-60 1 AS
 700-1-11 1 AS

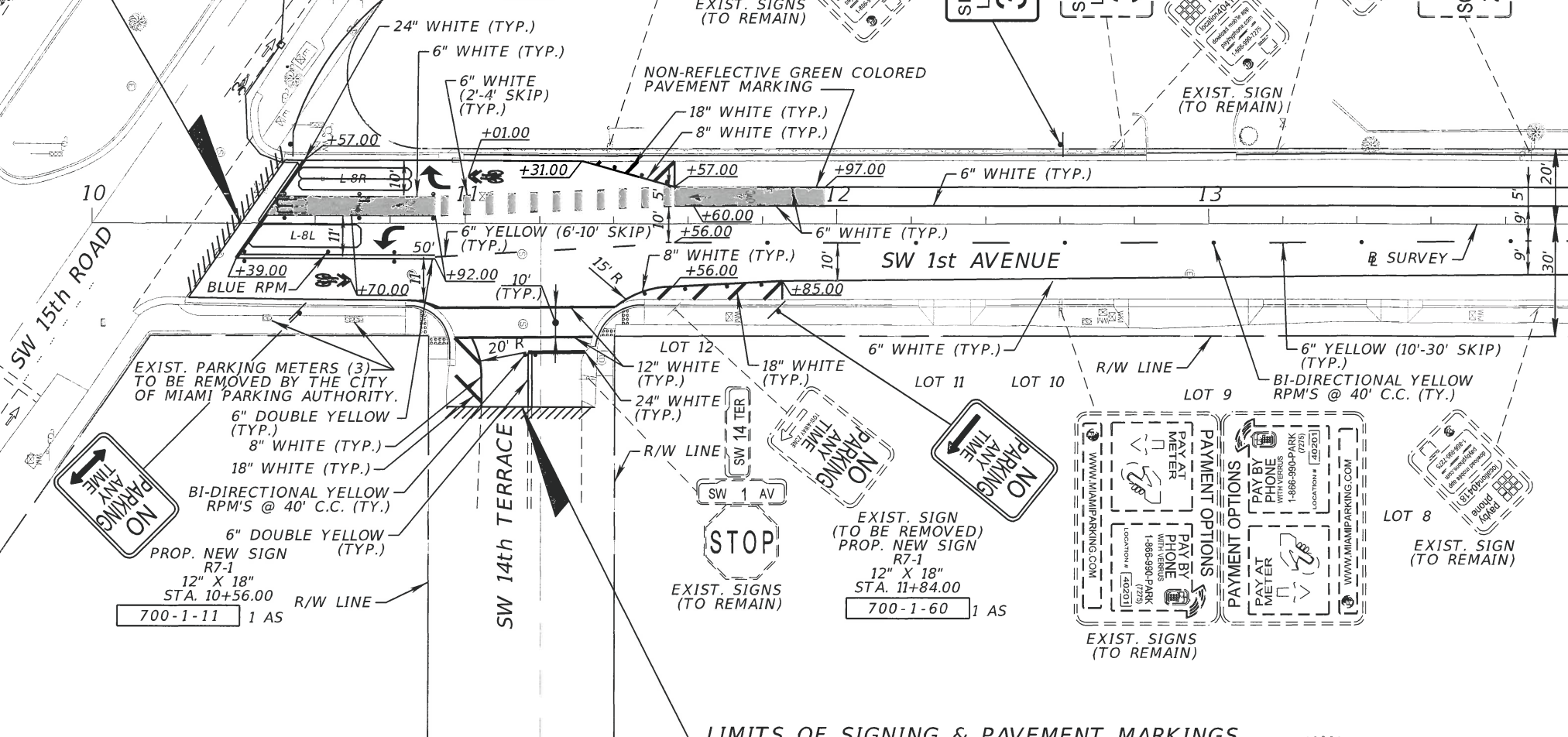

EXIST. PARKING METERS (3)
 TO BE REMOVED BY THE CITY
 OF MIAMI PARKING AUTHORITY.
 6" DOUBLE YELLOW
 (TYP.)
 8" WHITE (TYP.)
 18" WHITE (TYP.)
 BI-DIRECTIONAL YELLOW
 RPM'S @ 40' C.C. (TY.)
 6" DOUBLE YELLOW
 (TYP.)
 PROP. NEW SIGN
 R7-1
 12" X 18"
 STA. 10+56.00
 700-1-11 1 AS

EXIST. SIGN
 (TO BE REMOVED)
 PROP. NEW SIGN
 R7-1
 12" X 18"
 STA. 11+84.00
 700-1-60 1 AS

EXIST. SIGN
 (TO REMAIN)
 PAYMENT OPTIONS
 PAY BY PHONE
 WITH VERBUS
 1-888-990-PARK
 (7273)
 LOCATION # [20503]
 WWW.MIAMIPARKING.COM

LIMITS OF SIGNING & PAVEMENT MARKINGS
 49.00' RT (MATCH EXIST.)

MATCH LINE STA. 14+00.00

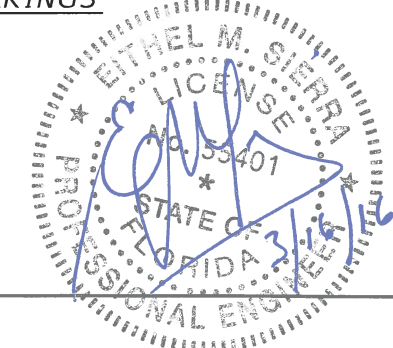

REVISIONS		DESCRIPTION
DATE	BY	

ENGINEER OF RECORD:
 A&P Consulting Transportation
 Engineers Corporation
 10305 N.W. 41 Street, suite 115
 Miami, FL 33178
 (305) 592-7283 / fax: (305) 593-1594
 CA No.: EB-0007797
 Ethel M. Sierra, P.E. No. 55401

CITY OF MIAMI
 CAPITAL IMPROVEMENTS PROGRAM
 444 S.W. 2ND AVENUE, 8TH FLOOR
 MIAMI, FLORIDA 33130
 (305) 416-1213 FAX (305) 416-1253

CITY OF MIAMI
 CAPITAL IMPROVEMENTS PROGRAM
 PROJECT NAME: SW 1st AVENUE IMPROVEMENTS
 PROJECT No.: B-30833

SIGNING & PAVEMENT MARKING PLANS
 SHEET NO. S-1

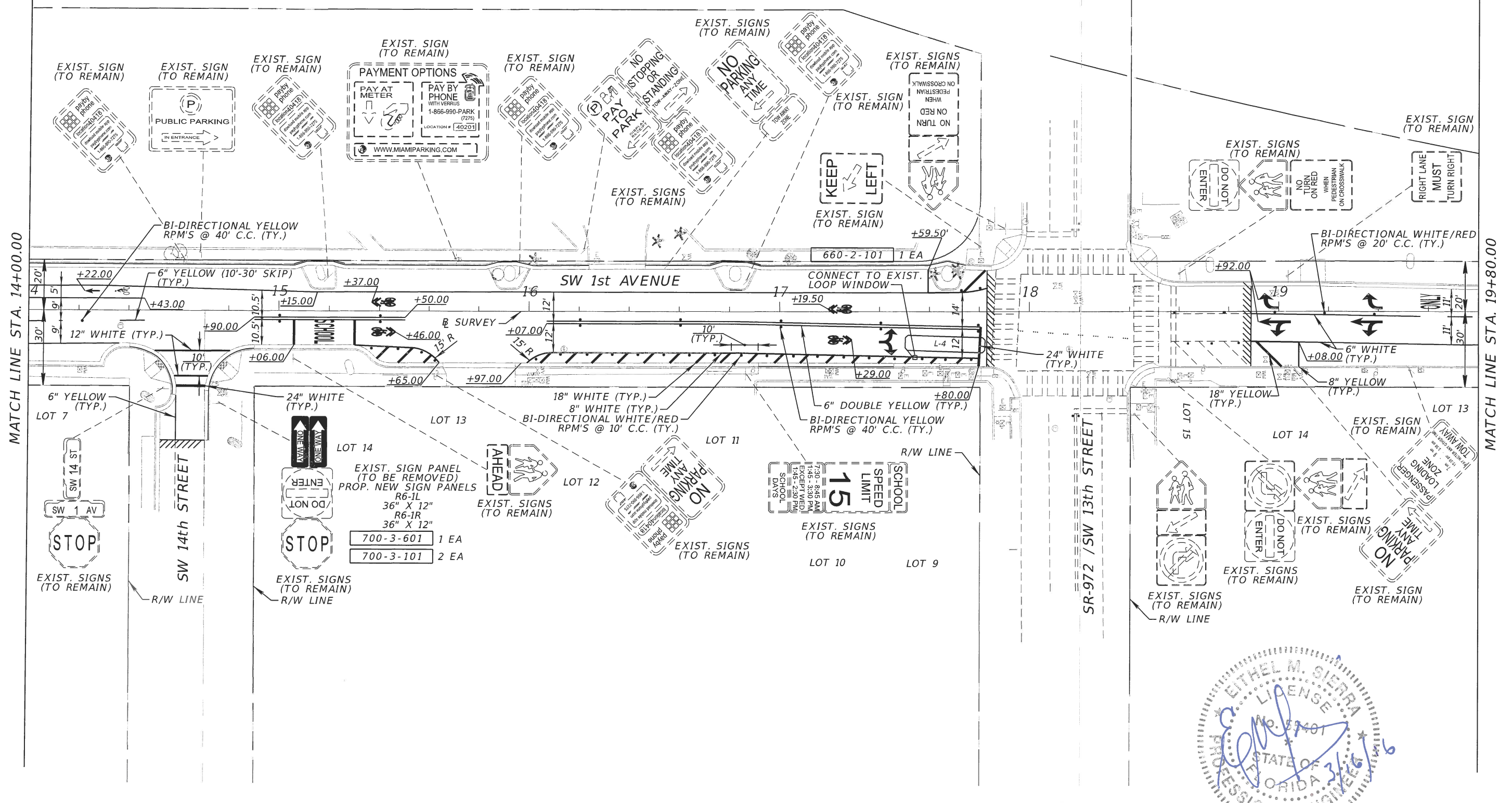
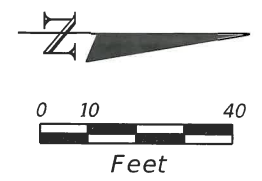

MATCH LINE STA. 14+00.00

MATCH LINE STA. 19+80.00



REVISIONS		
DATE	BY	DESCRIPTION

ENGINEER OF RECORD:
A&P ENGINEERS
 A&P Consulting Transportation Engineers Corporation
 10305 N.W. 41 Street, suite 115
 Miami, FL 33178
 (305) 592-7283 / fax: (305) 593-1594
 CA No.: EB-0007797
 Ethel M. Sierra, P.E. No. 55401

CITY OF MIAMI
 CAPITAL IMPROVEMENTS PROGRAM
 444 S.W. 2ND AVENUE, 8TH FLOOR
 MIAMI, FLORIDA 33130
 (305) 416-1213 FAX (305) 416-1253

CITY OF MIAMI
 CAPITAL IMPROVEMENTS PROGRAM
 PROJECT NAME: **SW 1st AVENUE IMPROVEMENTS**
 PROJECT No.: **B-30833**

SIGNING & PAVEMENT MARKING PLANS

SHEET NO.
S-2

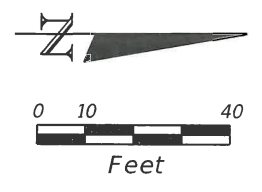

MATCH LINE STA. 19+80.00

MATCH LINE STA. 25+60.00

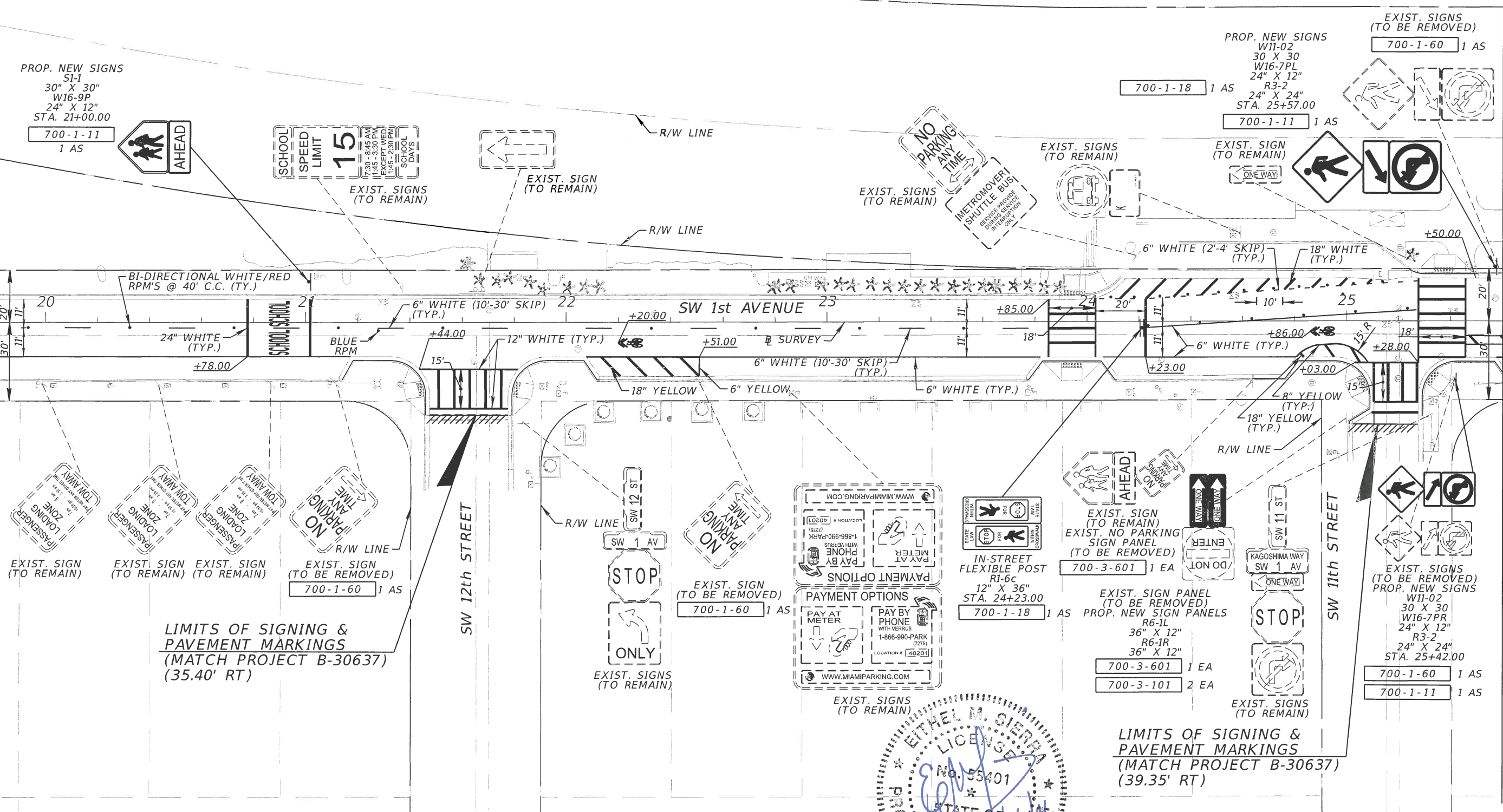

LIMITS OF SIGNING & PAVEMENT MARKINGS (MATCH PROJECT B-30637) (35.40' RT)

LIMITS OF SIGNING & PAVEMENT MARKINGS (MATCH PROJECT B-30637) (39.35' RT)

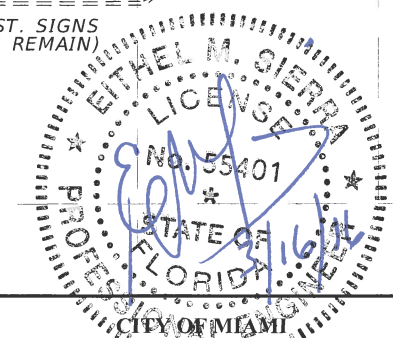

REVISIONS		
DATE	BY	DESCRIPTION

ENGINEER OF RECORD:
A&P ENGINEERS
 A&P Consulting Transportation Engineers Corporation
 10305 N.W. 41 Street, suite 115
 Miami, FL 33178
 (305) 592-7283 / fax: (305) 593-1594
 CA No.: EB-0007797
 Eithel M. Sierra, P.E. No. 55401

CITY OF MIAMI
CAPITAL IMPROVEMENTS PROGRAM
 444 S.W. 2ND AVENUE, 8TH FLOOR
 MIAMI, FLORIDA 33130
 (305) 416-1213 FAX (305) 416-1253

CITY OF MIAMI CAPITAL IMPROVEMENTS PROGRAM	
PROJECT NAME	PROJECT No.
SW 1st AVENUE IMPROVEMENTS	B-30833

SIGNING & PAVEMENT MARKING PLANS

SHEET NO.
S-3

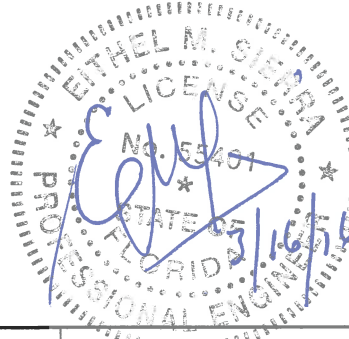
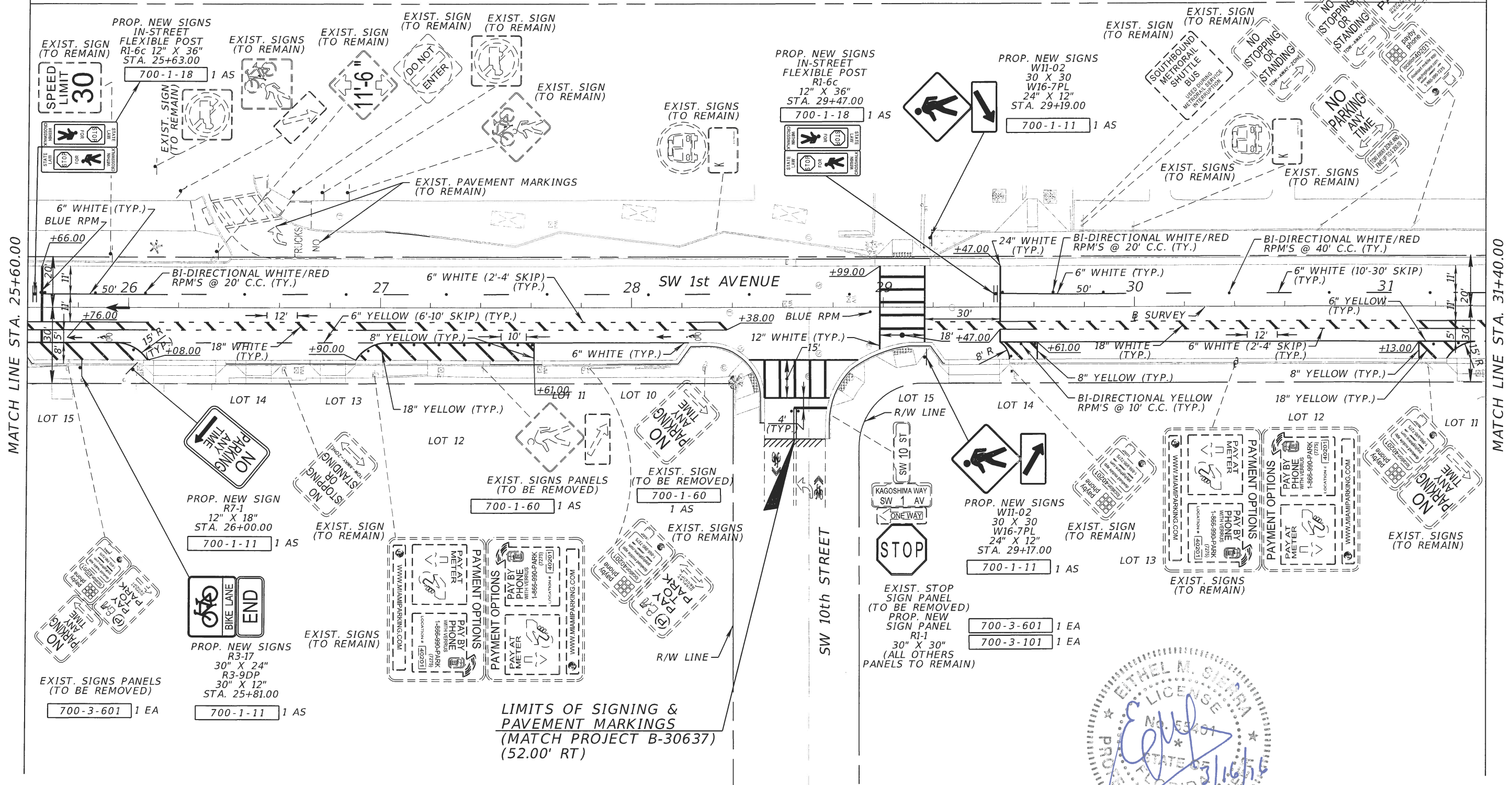
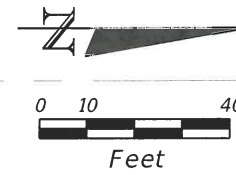

REVISIONS		
DATE	BY	DESCRIPTION

ENGINEER OF RECORD:
A&P ENGINEERS
 A&P Consulting Transportation
 Engineers Corporation
 10305 N.W. 41 Street, suite 115
 Miami, FL 33178
 (305) 592-7283 / fax: (305) 593-1594
 CA No.: EB-0007797
 Eithel M. Sierra, P.E. No. 55401

CITY OF MIAMI
 CAPITAL IMPROVEMENTS PROGRAM
 444 S.W. 2ND AVENUE, 8TH FLOOR
 MIAMI, FLORIDA 33130
 (305) 416-1213 FAX (305) 416-1253

CITY OF MIAMI
 CAPITAL IMPROVEMENTS PROGRAM
 PROJECT NAME: SW 1st AVENUE IMPROVEMENTS
 PROJECT No.: B-30833

SIGNING & PAVEMENT MARKING PLANS

SHEET NO.
S-4

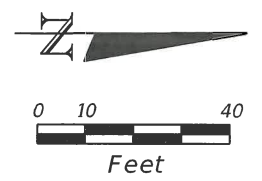

END PROJECT B-30833
 BEGIN PROJECT
 TO BE CONSTRUCTED
 BY BRICKELL CITYCENTRE
 STA. 35+04.50

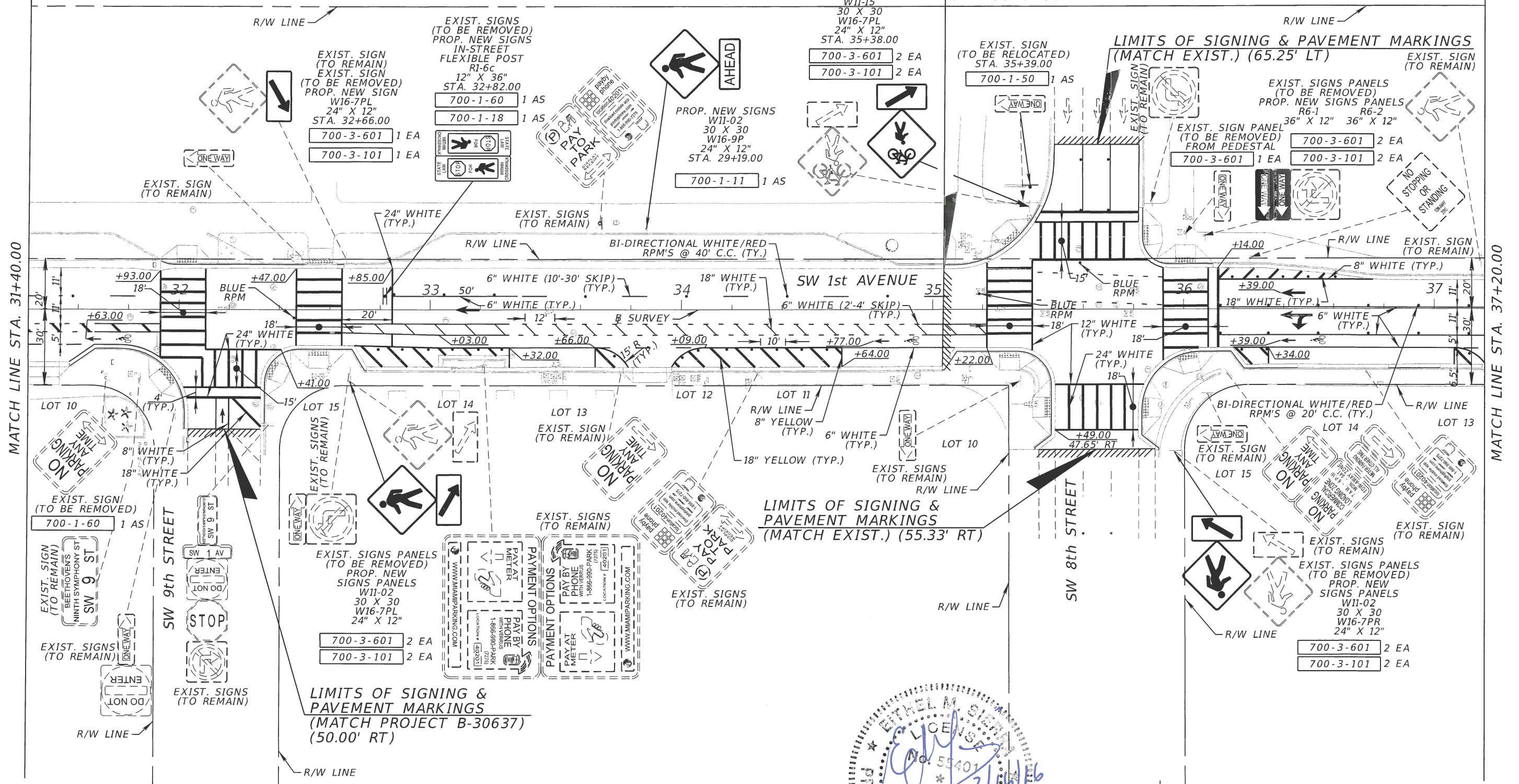

MATCH LINE STA. 31+40.00

MATCH LINE STA. 37+20.00



REVISIONS		
DATE	BY	DESCRIPTION

ENGINEER OF RECORD:
 A&P Consulting Transportation Engineers Corporation
 10305 N.W. 41 Street, suite 115
 Miami, FL 33178
 (305) 592-7283 / fax: (305) 593-1594
 CA No.: EB-0007797
 Ethel M. Sierra, P.E. No. 55401

CITY OF MIAMI
 CAPITAL IMPROVEMENTS PROGRAM
 444 S.W. 2ND AVENUE, 8TH FLOOR
 MIAMI, FLORIDA 33130
 (305) 416-1213 FAX (305) 416-1253

CITY OF MIAMI CAPITAL IMPROVEMENTS PROGRAM	
PROJECT NAME	PROJECT No.
SW 1st AVENUE IMPROVEMENTS	B-30833

SIGNING & PAVEMENT MARKING PLANS

SHEET NO.
S-5

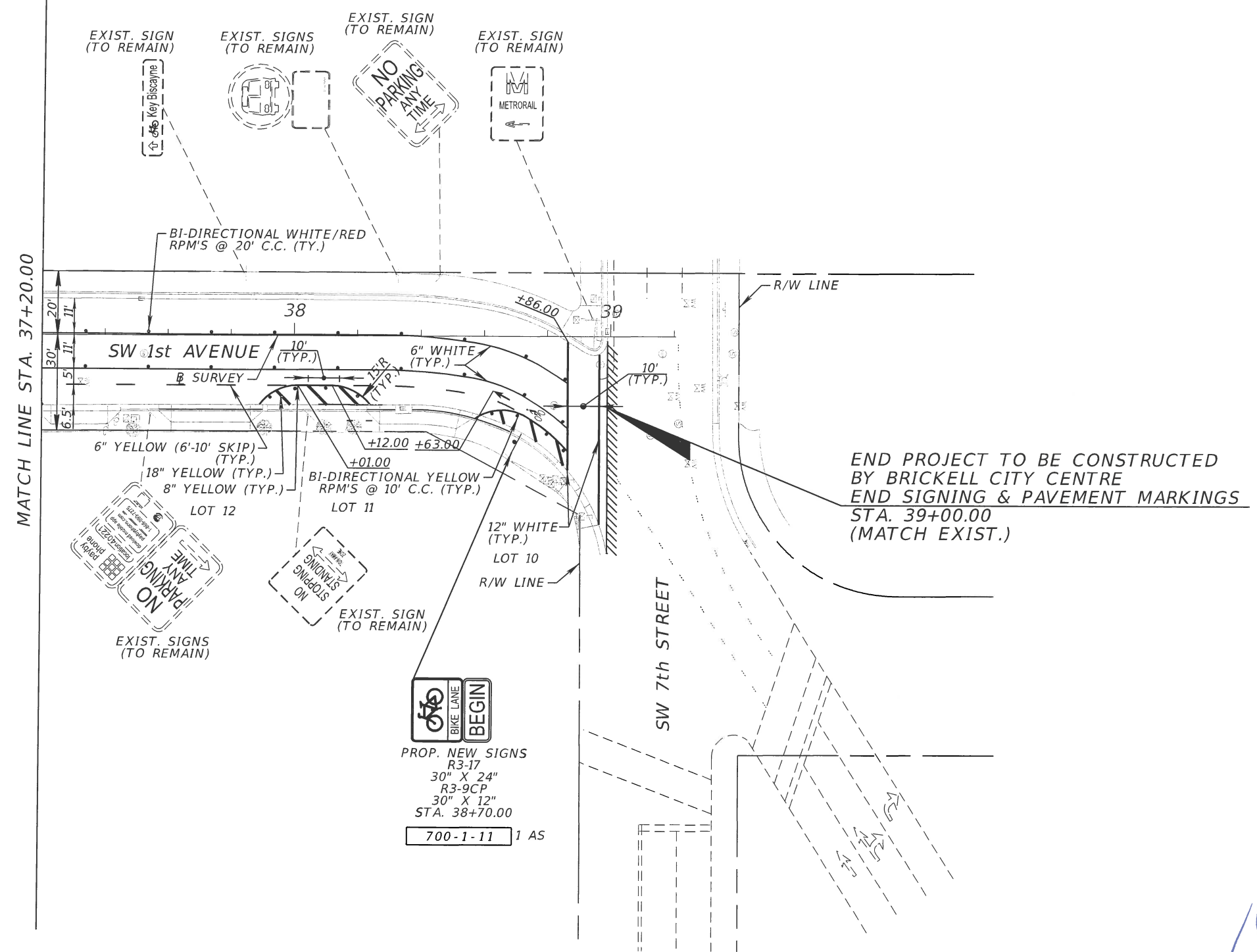
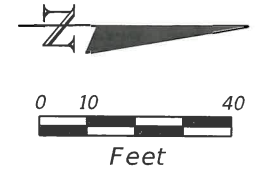

PROP. NEW SIGNS
 R3-17
 30" X 24"
 R3-9CP
 30" X 12"
 STA. 38+70.00
 700-1-11 1 AS



REVISIONS		
DATE	BY	DESCRIPTION

ENGINEER OF RECORD:
 A&P Consulting Transportation Engineers Corporation
 10305 N.W. 41 Street, suite 115
 Miami, FL 33178
 (305) 592-7283 / fax: (305) 593-1594
 CA No.: EB-0007797
 Ethel M. Sierra, P.E. No. 55401

 CITY OF MIAMI
 CAPITAL IMPROVEMENTS PROGRAM
 444 S.W. 2ND AVENUE, 8TH FLOOR
 MIAMI, FLORIDA 33130
 (305) 416-1213 FAX (305) 416-1253

CITY OF MIAMI CAPITAL IMPROVEMENTS PROGRAM	
PROJECT NAME	PROJECT No.
SW 1st AVENUE IMPROVEMENTS	B-30833

SIGNING & PAVEMENT MARKING PLANS

SHEET NO.
S-6