



City of Miami

ADDENDUM NO. 2

June 28, 2017

REQUEST FOR QUALIFICATIONS (RFQ) NO.: 16-17-044

WYNWOOD STREETScape AND TREE SCape MASTER PLAN

TO: ALL PROSPECTIVE BIDDERS:

The following changes, additions, clarifications, and/or deletions amend the above-captioned Request for Proposals and shall become an integral part of the Proposals submitted and the Wynwood Streetscape and Street Tree Master Plan–Request for Proposals No.: 15-16-044 (the “Project”). Please note the contents herein and affix same to the documents you have on hand.

All attachments (if any) are available on the Office of Capital Improvements' website and are part of this Addendum.

- A. Attached are the sign-in sheets from the Pre-Proposal Conference held on Wednesday, June 28, 2017.
- B. All references to Attachment A in this Solicitation, shall mean the draft Professional Services Agreement (PSA)
- C. Section 2.1, Purpose, first Paragraph, third sentence, is being amended to replace "Attachment A" with "Exhibit 1" which is the map that identifies the area requiring that referred to in this section.
- D. Proposer, item (7) was deleted in its entirety prior to release as this RFQ as this Form is not applicable to this solicitation.
 - ~~7) Submit the Proposer's Standard Form (SF) 254 (linked attachment to RFQ) and provide any other documentation which demonstrates their ability to satisfy all of the minimum qualifications requirements. Submittals which do not contain such documentation may be deemed non-responsive.~~
- E. Section 4.1, Subsection A.5, Qualification of the Proposer's Team, item (1) was deleted in its entirety prior to the release of this RFQ as this Form is not applicable to this solicitation.
 - ~~1) Submit Standard Form (SF) 255 (linked Attachment to RFQ) for this engagement.~~

THIS ADDENDUM IS AN ESSENTIAL PORTION OF THE RFQ AND SHALL BE MADE A PART THEREOF.



Annie Perez, CPPO, Director

City of Miami Department of Procurement



ATTENDANCE SHEET

RFQ 16-17-044 - Wynwood Streetscape and Street Tree Master Plan
 RFP/RFQ NUMBER: RFQ 16-17-049 - Wynwood 3rd Avenue Woonerf Streetscape and Street Tree Master
 LOCATION: 310 NW 26th Street Suite 1 - Wynwood Business Improvement District Office
 PURPOSE: Pre-Proposal Conference
 DATE: 28-Jun-17

Completing this attendance sheet is optional.

NAME	COMPANY	ADDRESS	PHONE	E-MAIL
Lydia Osborne	City of Miami	444 SW 2nd Avenue 6th Floor	(305) 416-1907	losborne@miamigov.com
Angela Biagi	WGI	2035 Vista Parkway West Palm Beach, FL 33411	(561) 478-8501	angela.biagi@wgin.com
Patricia Caripa	Callison RTKL	3940 Alhambra Ave. #84500	(786) 268-3286	patricia.caripa@rtkl.com
Luiza Leite	Dover-Kohl	1571 Sunset Drive	() ()	lleite@dovertkl.com
Jordan Tashenberg	Tashenberg LLC	6310 NW 2nd Ave. Munnig	(305) 962-2474	jordan@tashenbergllc.com
MONICA GRIGORESCU	ARQUITECTONICA	2900 OAK AVE MIAMI, FL	(305) 372-1812	mgrigorescu@arquitonica.com
KYMNIK STEPHENSON	EDSA	1512 E. BROWARD BLVD Ft. Lauderdale	(954) 524-3330	astethen@edsa.com
ANDRES ARCILLA	NATURAL FICIAL	6915 P&O ROAD S. 224 CORAL GABLES, FL 33134	(305) 521-2341	andres@naturalficial.com
MICHAEL PHILLIPS	KEITH ASSOC.	6915 P&O ROAD S. 224 CORAL GABLES, FL 33134	(305) 521-2341	mphilips@keith-associates.com
AIDA CURTIS	Curtis + Rogers	7520 S Red Road Ste 100 Miami, FL	(305) 467-5474	aidac@curtisrogers.com
Christos Botanacourt	OSI	469 So. Dixie Hwy Coral Gables, FL	(305) 525-6461	cbotanacourt@osiconsult.com
HARRY Corp		1795 Ave	(786) 286-3490	harrycorp@harry.com



ATTENDANCE SHEET

RFQ 16-17-044 - Wynwood Streetscape and Street Tree Master Plan
 RFP/RFQ NUMBER: RFQ 16-17-049 - Wynwood 3rd Avenue Woonerf Streetscape and Street Tree Master
 LOCATION: 310 NW 26th Street Suite 1 - Wynwood Business Improvement District Office
 PURPOSE: Pre-Proposal Conference
 DATE: 28-Jun-17

Completing this attendance sheet is optional.

NAME	COMPANY	ADDRESS	PHONE	E-MAIL
Lydia Osborne	City of Miami	444 SW 2nd Avenue 6th Floor	(305) 416-1907	losborne@miamigov.com
Babara Lamb	Dre Kohl & part	571 Sunset drive	()	blamb@ctokkari.com
Phyllis Wozniak	EDWARDS & KELLY	2601 S. BAYSHORE DR 1000	(784) 865-5267	phillingworth@baniemini.com
Steve Wozniak	Phyllis & Desor	2916 SW 27 Ave B/A	(35) 776-3231	steve@psurbia.com
PAUL WENBANK	KENTH ASSOC	301 ATLANTIC AVE	954 593 7818	pweinbank@gmail.com
CHAD COWART	AECOM	150 No. OXANGET AVE	(407) 284-4787	chad.cowart@aecom.com
Sophia Allen	SAMMO & MILLER	12345 NE Lkn Ave	(305) 895 9082	sophia@scsumo.mill.com
Irène Balzo	StreetPlans	221 Aragon Avenue	(305) 581 4484	irene@streetplans.com
Giordy Vazquez	Rodriguez Duran	2100 Ponce de Leon Blvd	(305) 419 9117	gvazquez@rodriguezduros.com
ABRAHAM BACHTINA	City of Miami, NV	444 SW 2nd, 8th Fl	(305) 416 1959	abacbtina@miacmgv.com
			()	
			()	
			()	
			()	
			()	
			()	



ATTENDANCE SHEET

RFQ 16-17-044 - Wynwood Streetscape and Street Tree Master Plan

RFP/RFQ NUMBER: RFQ 16-17-049 - Wynwood 3rd Avenue Woonerf Streetscape and Street Tree Master

LOCATION: 310 NW 26th Street Suite 1 - Wynwood Business Improvement District Office

PURPOSE: Pre-Proposal Conference

DATE: 28-Jun-17

Completing this attendance sheet is optional.

NAME	COMPANY	ADDRESS	PHONE	E-MAIL
Lydia Osborne	City of Miami	444 SW 2nd Avenue 6th Floor	(305) 416-1907	losborne@miamigov.com
MIKE BROWN	AECOM	150 H. DRAYAGE AVE Ste 200	(407) 843 6552	michael.brown@aecom.com
			()	
			()	
			()	
			()	
			()	
			()	
			()	
			()	
			()	
			()	
			()	
			()	
			()	
			()	
			()	
			()	
			()	
			()	
			()	
			()	
			()	
			()	

SECTION 8 - STREET MASTER PLAN

8.1 NRD-1 STREET MASTER PLAN

The Wynwood District is transitioning from an Industrial District into an active, diverse, mixed-use Neighborhood. The current character of the Neighborhood is demarcated, traversed, and connected by atypical block compositions and narrow Right-of-Ways (ROWs) attributed to the Industrial past. The Neighborhood's predominately zoned fifty foot (50') ROW combined with a high percentage of nonconforming parcels makes it a challenge to balance feasible Development and an adequate pedestrian environment.

The NRD-1 Street Master Plan will create a series of ROWs, establish appropriate Setback areas and ideal sidewalk conditions to promote pedestrian activity for the future of the Wynwood District. ROW types have been established by the City's Planning and Zoning Department and Public Works Department, and applied to Wynwood's Thoroughfare network based on ROW width and conditions, as identified on the NRD-1 Street Master Plan Map. The NRD-1 Street Master Plan will also serve as an organizing principle for a NRD-1 Street Tree Master Plan.

a. NRD-1 Street Hierarchy

The NRD-1 Street Master Plan acknowledges the relative importance of several significant Corridors, known as Wynwood Corridors and NRD-1 Corridors. Due to their importance, these Corridors are given established setback provisions that are different from that of the underlying Transect Zone.

Wynwood Corridors

- NW 29 Street
- NW 20 Street

NRD-1 Corridors

- NW 2 Avenue
- NW 5 Avenue

Wynwood Thoroughfares

- All other street ROWs within NRD-1 that are not specified as Corridors above.

b. NRD-1 Setbacks:

1. Wynwood Thoroughfares: Principal and Secondary Frontage Setback is five (5) feet.
2. Wynwood Corridors: Principal and Secondary Frontage Setback is ten (10) feet.
3. NRD-1 Corridors: Principal Frontage Setback is zero (0) feet.

c. Alternative Rights-of-Way

Alternative ROW sections have been created for thoroughfares between fifty (50) and one hundred (100) feet in width. A woonerf has also been provided as an alternative ROW type, and applied to several locations throughout the NRD-1. The application of these Alternative ROW conditions can be seen in Section 8.2.

d. NRD-1 Street Tree Master Plan

Street Tree Contribution:

For street tree improvements along Wynwood Thoroughfares and Wynwood/NRD Corridor, the applicant shall provide street trees pursuant to Street Tree Master Plan or provide a cash contribution into the Wynwood Public Benefit Trust Fund for the sum of three thousand dollars (\$3,000.00) for each street tree required along a corridor Frontage.

8.2 NRD-1 STREET MASTER PLAN - MAP

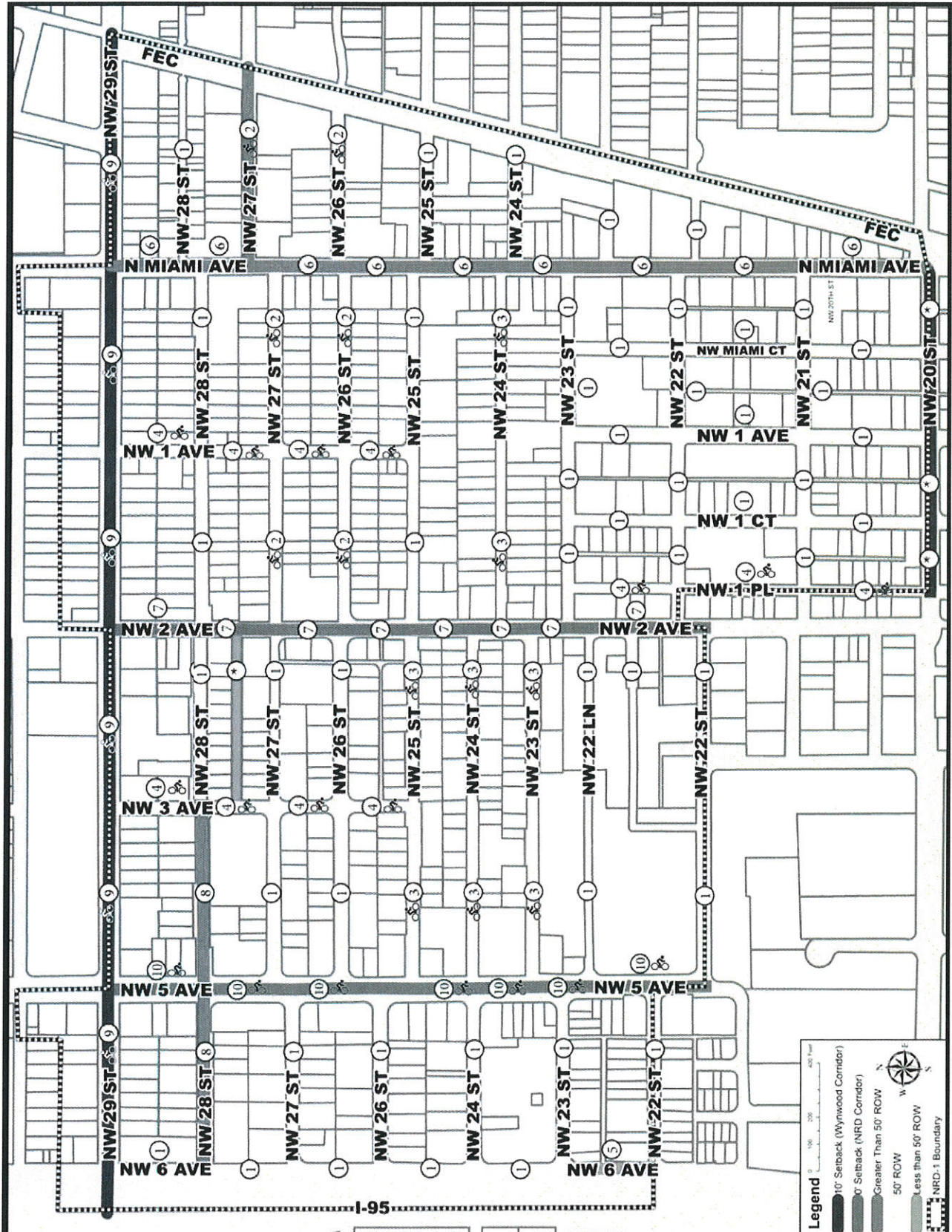

* ZONED ROW DOES NOT FIT A STANDARD STREET SECTION AND WILL REMAIN AS EXISTING CONDITION.

8.3 NRD-1 STREET MASTER PLAN - RIGHT-OF-WAY SECTIONS

City Public Works:
Standard 50-F
5' Established Setback

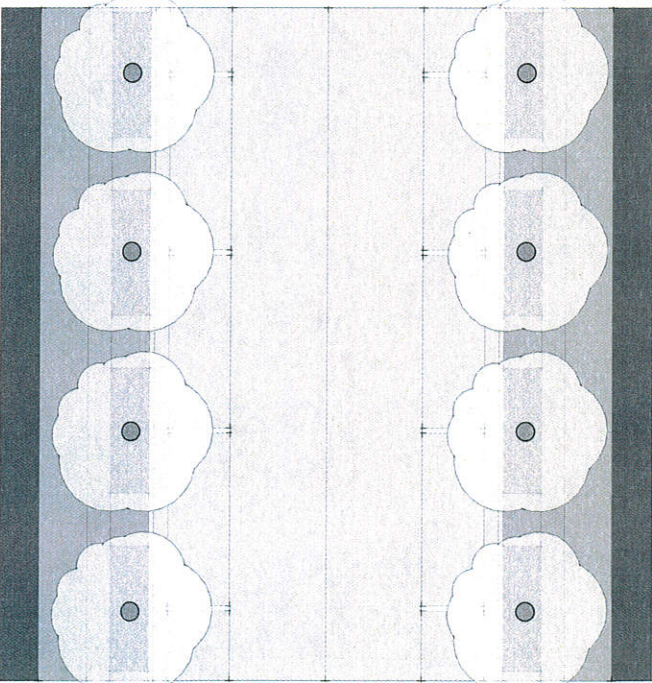
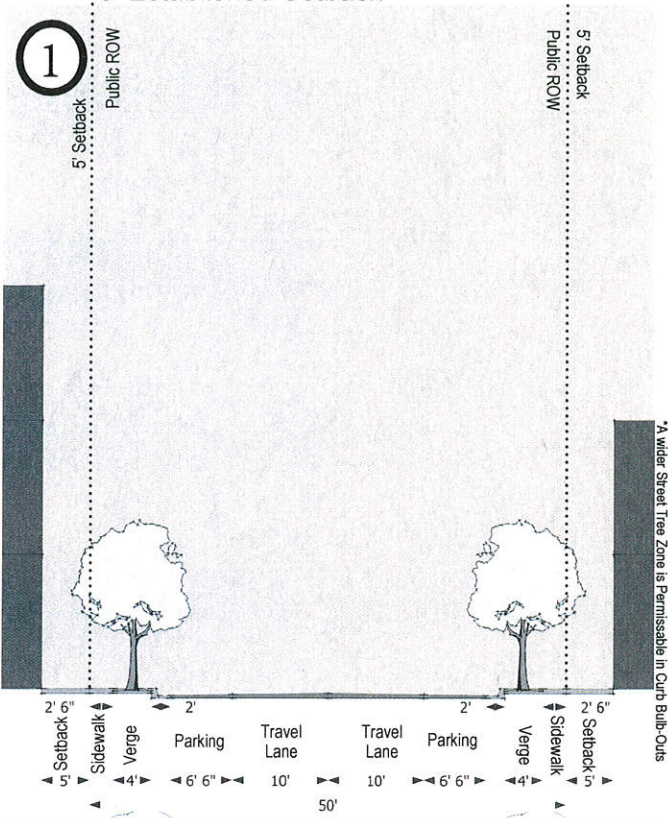

Affected Thoroughfares:
This is the standard thoroughfare condition for Wynwood, and is the most prevalent section applied in the NRD-1 SMP. For specific application, please reference SMP Map.

City Public Works:
Standard 50-F Modified With a Bike Lane
5' Established Setback

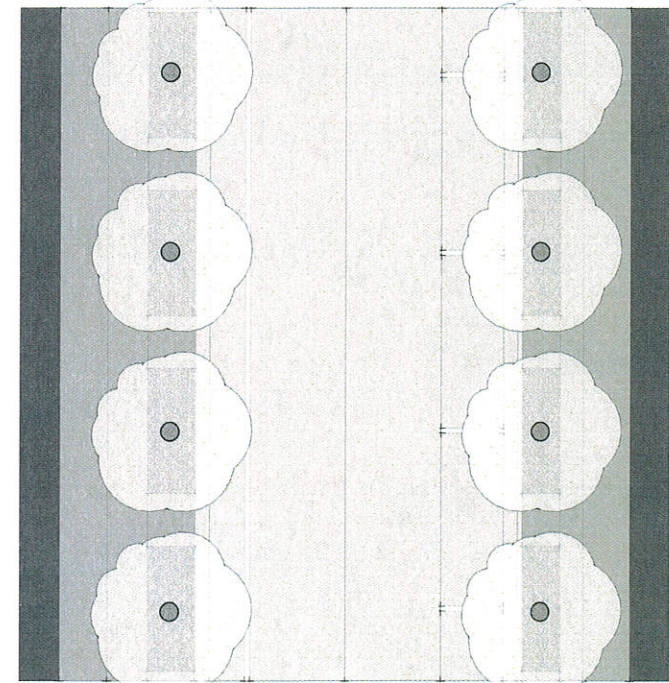
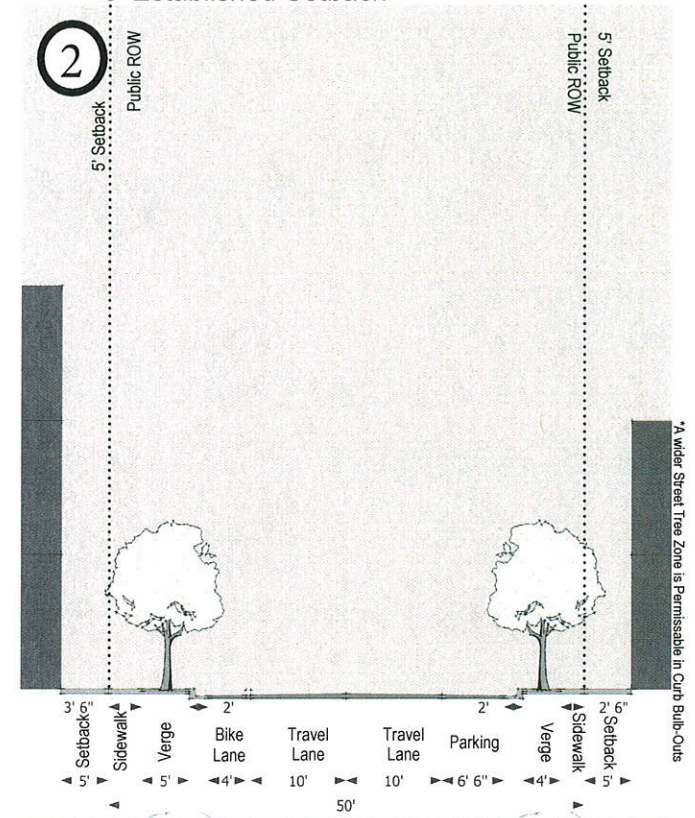

Affected Thoroughfares:
27th ST between NE 2nd AV and the FEC corridor
26th ST between NW 5th AV and the FEC corridor

City Capital Improvements:
One-Way With Bike Lane
5' Established Setback

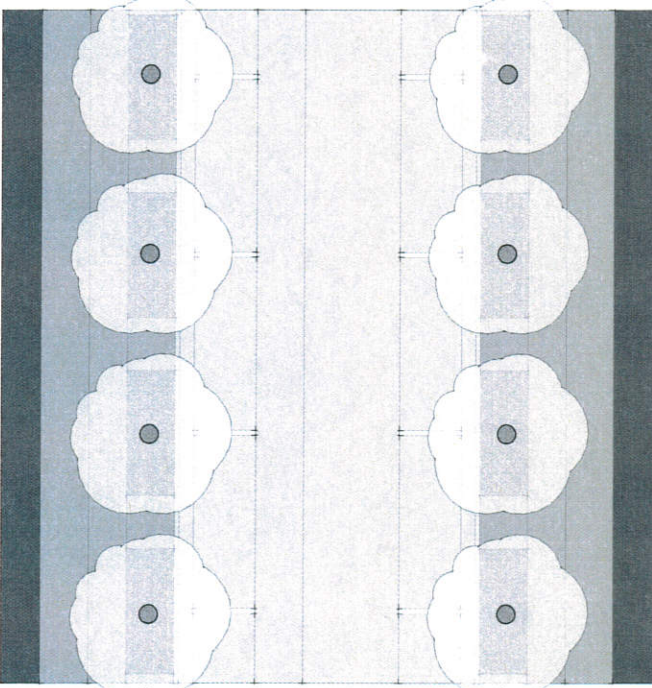
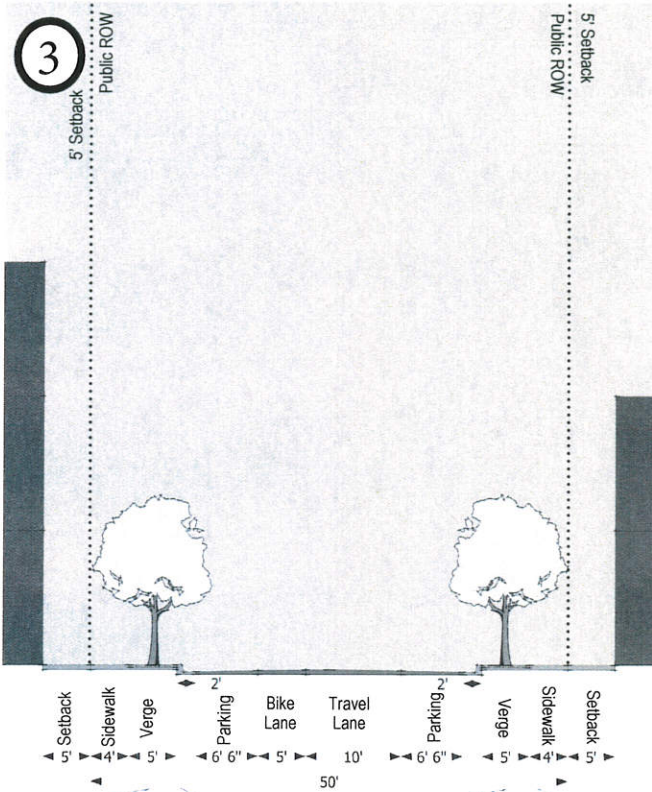

Affected Thoroughfares:
 NW 25th ST between NW 5th AV and NW 2nd AV
 NW 24th ST between NW 5th AV and N Miami AV
 NW 23th ST between NW 5th AV and NW 2nd AV

City Planning Department:
Woonerf*
5' Established Setback

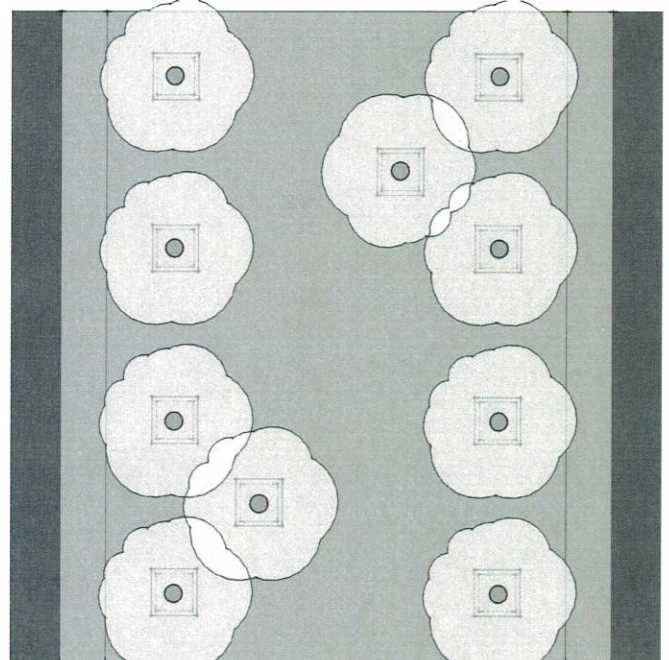
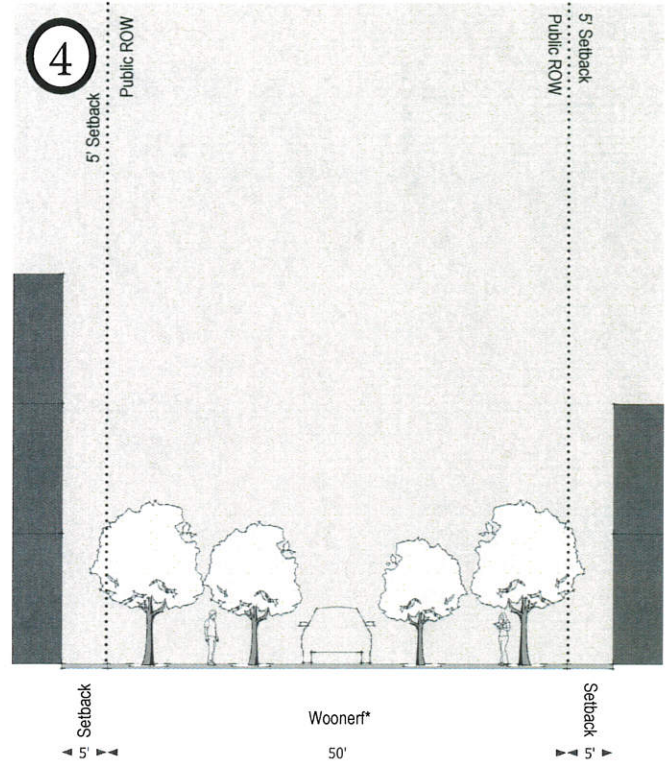

* Illustration is intended to convey Woonerf concept, not actual design

Affected Thoroughfares:
 NW 3rd AV between NW 29th ST and NW 25th ST
 NW 1st AV between NW 29th ST and NW 25th ST
 NW 1st PL between NW 23rd ST and NW 20th ST

City Planning Department:
45' ROW against I-95
5' Established Setback

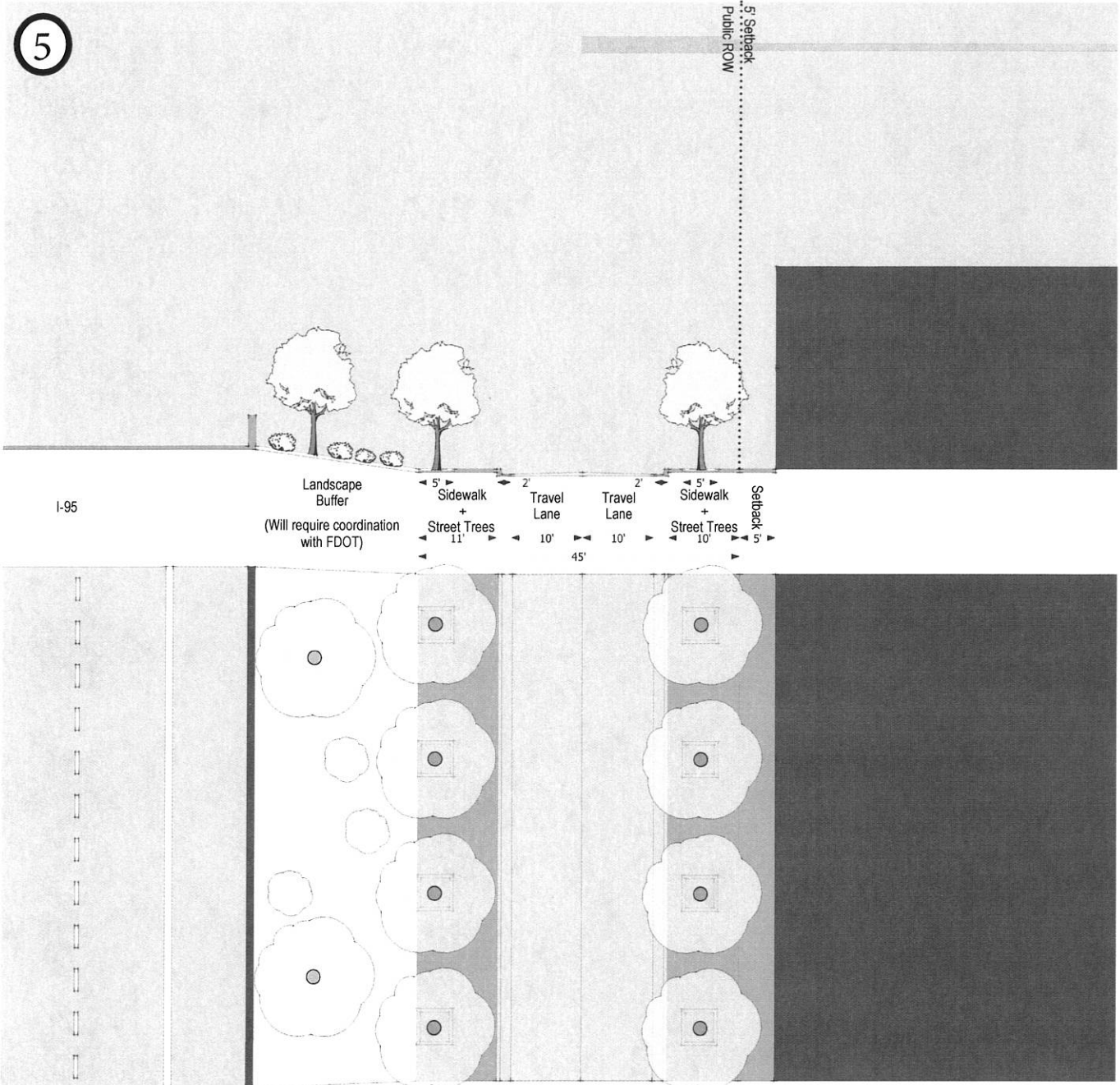

Affected Thoroughfare:
NW 6th AV between NW 22nd ST and NW 23th ST

Miami Dade County Public Works:
North Miami Avenue Proposed Road Diet
5' Established Setback

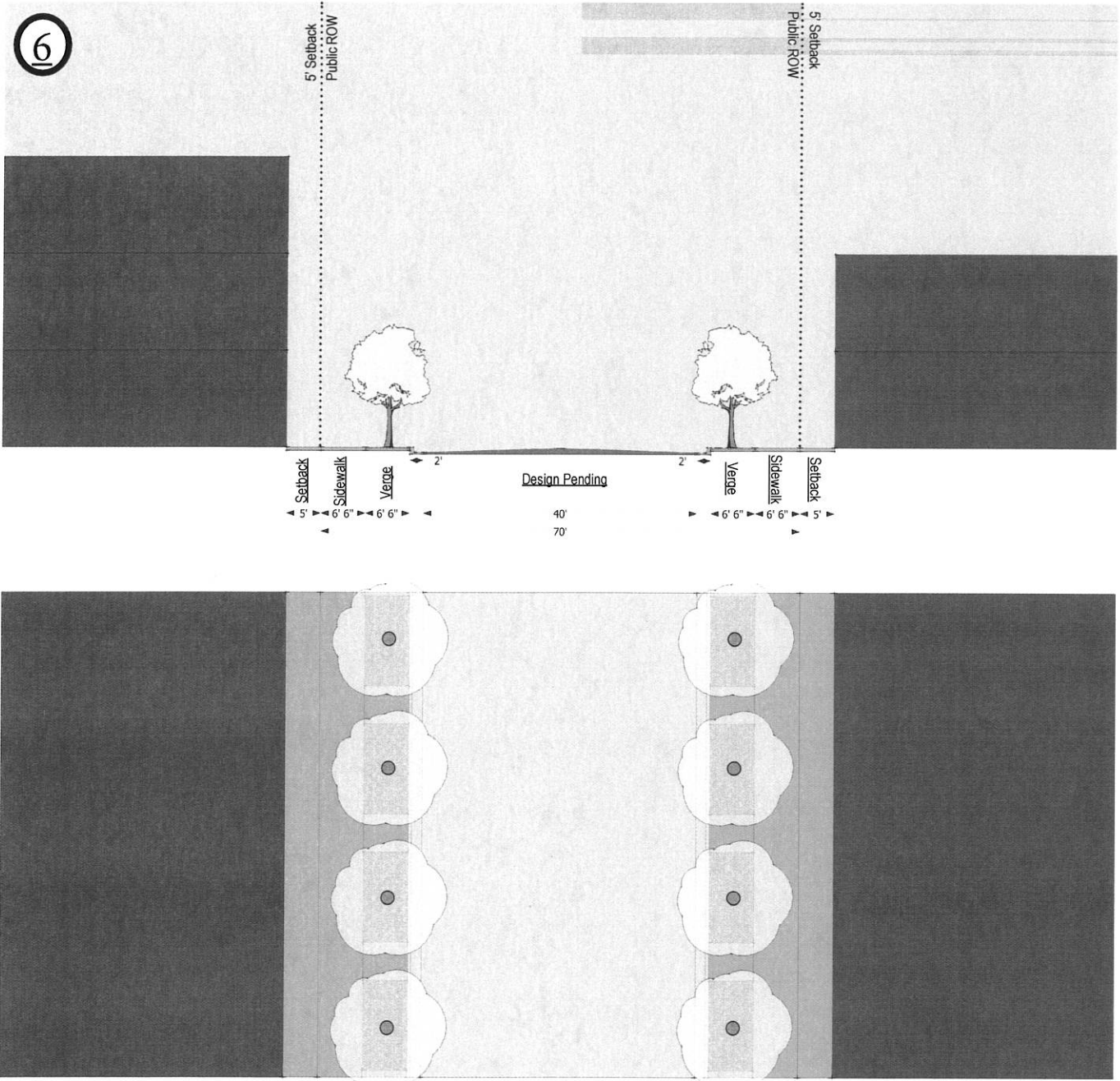

Affected Thoroughfare:
N Miami AV between N 29th ST and N 20th ST

City Public Works:
70-F
0' Established Setback

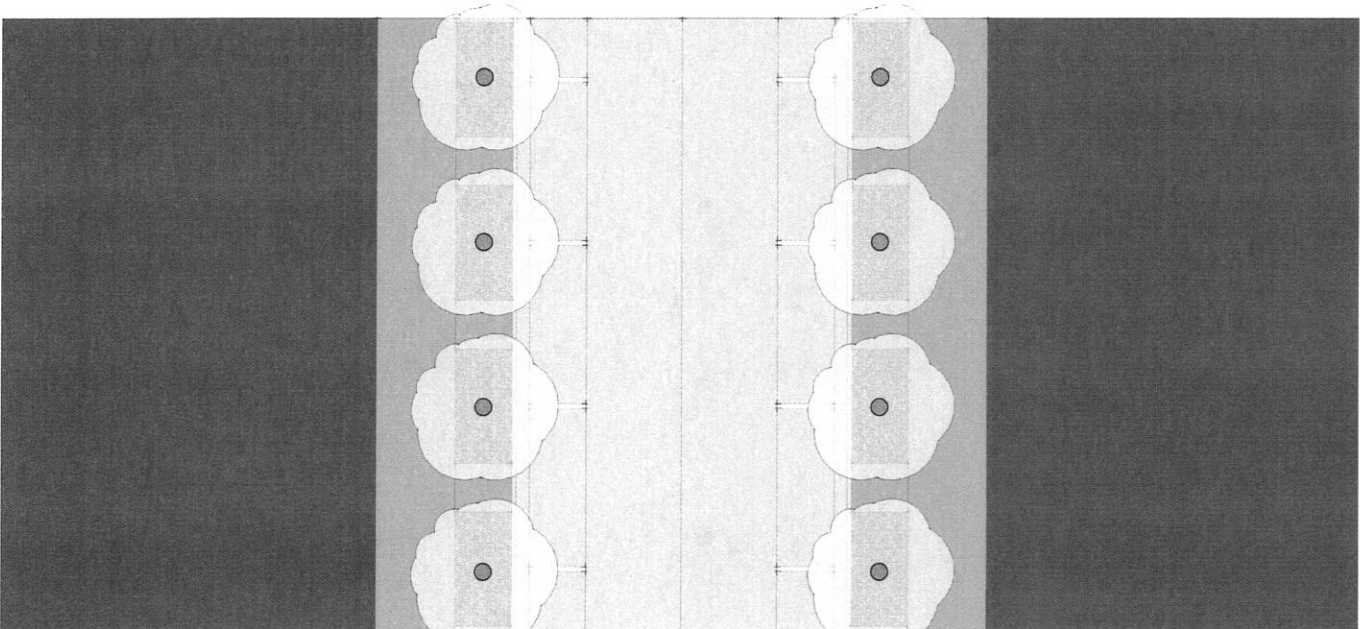
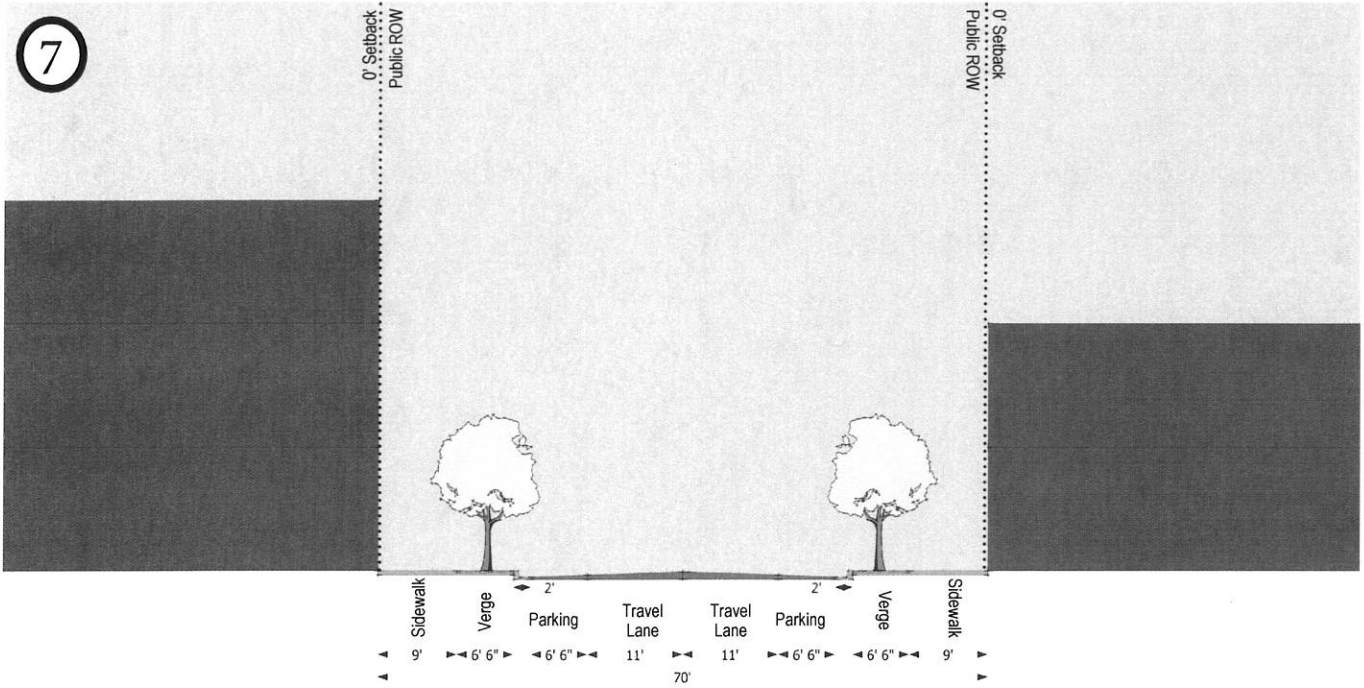

Affected Thoroughfare:
NW 2nd AV between NW 29th ST and NW 22th ST

City Planning Department:
 70' With Linear Parkway
 5' Established Setback

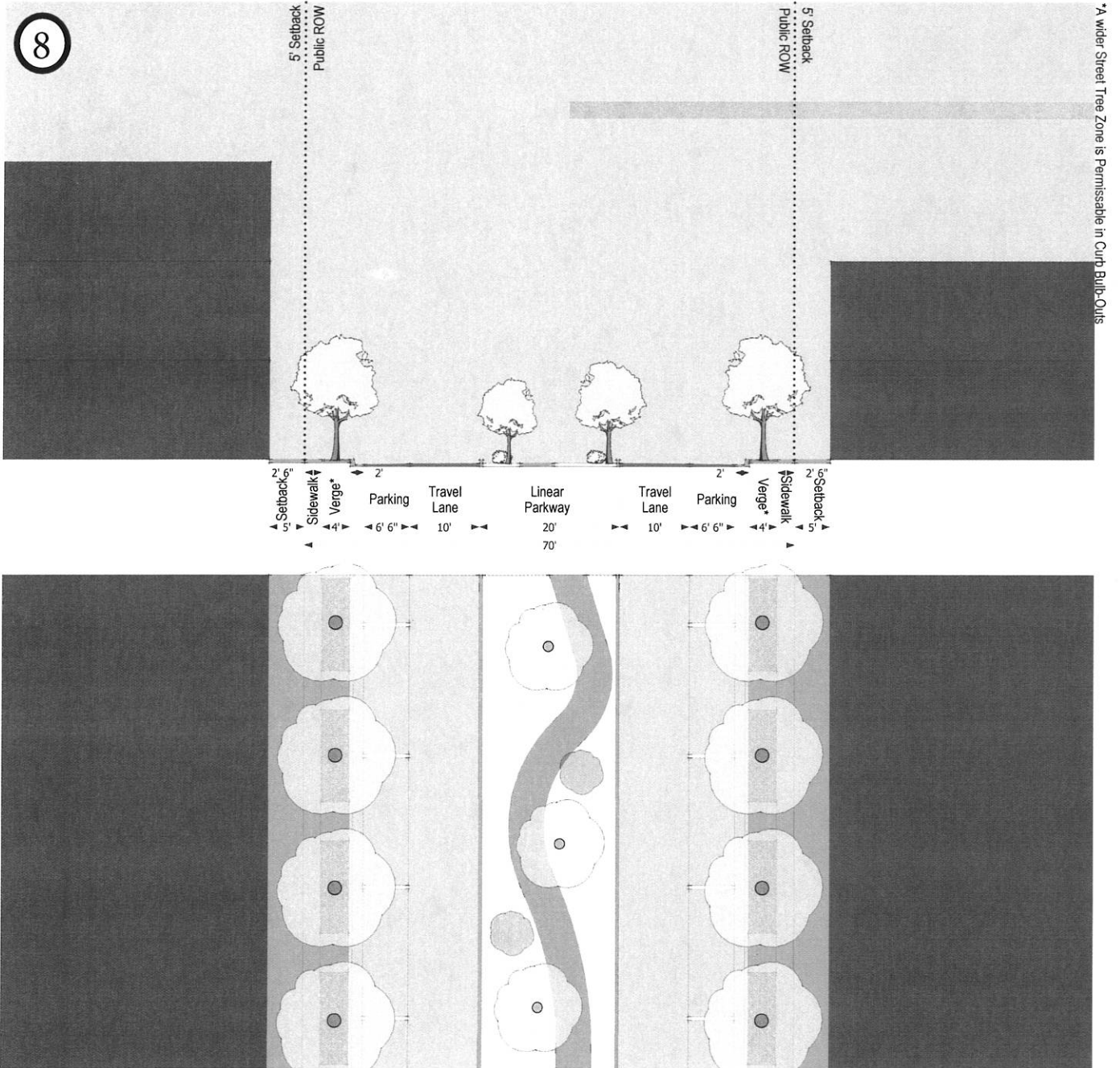

Affected Thoroughfare:
 NW 28th ST between NW 6th AV and NW 3rd AV

City Capital Improvements:
NW 29th Approved Road Diet
10' Established Setback

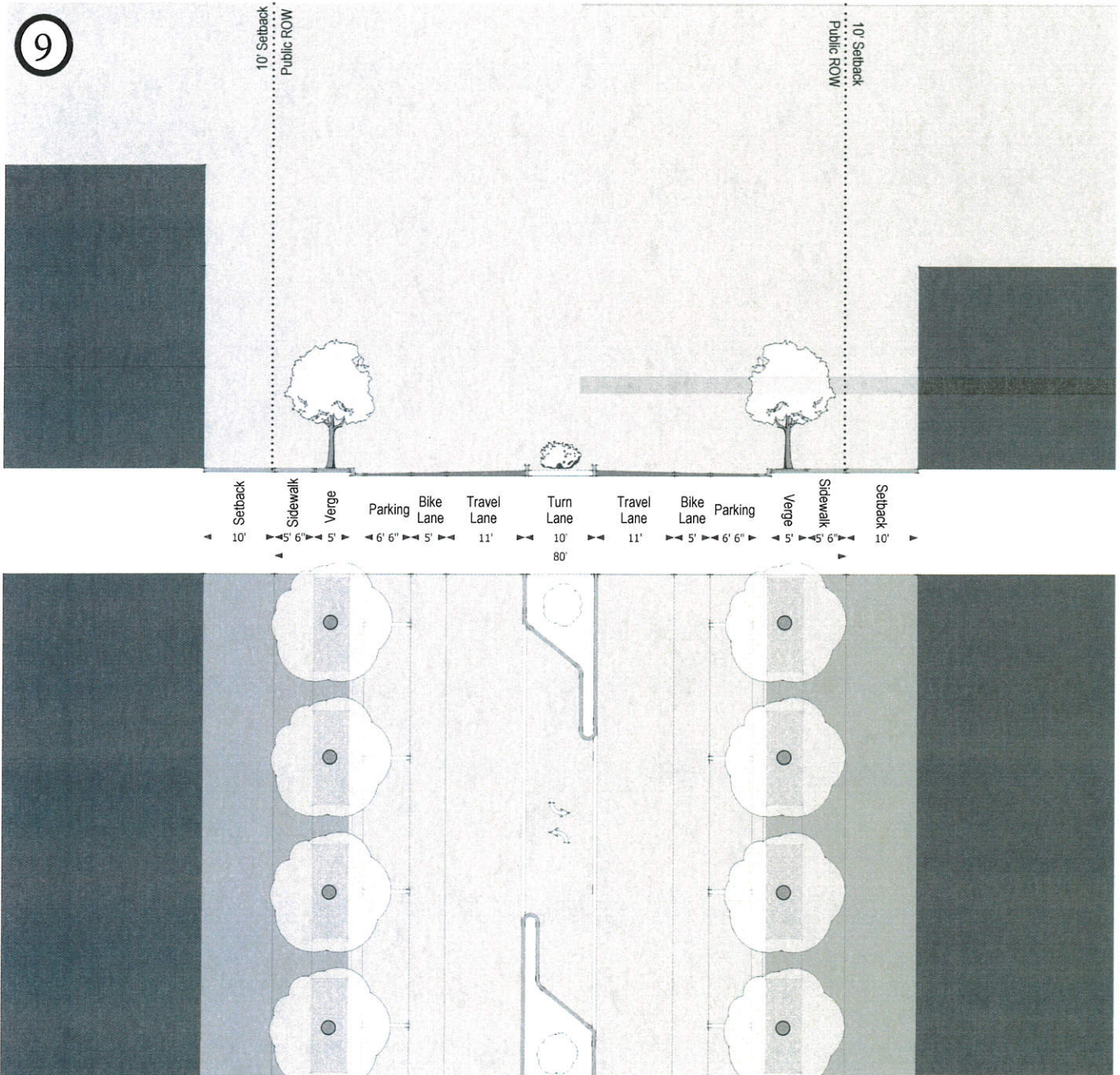

Affected Wynwood Corridor:
NW 29th ST between I-95 and the FEC

City Capital Improvements:
 Modified 100-D with Bike Lanes
 0' Established Setback

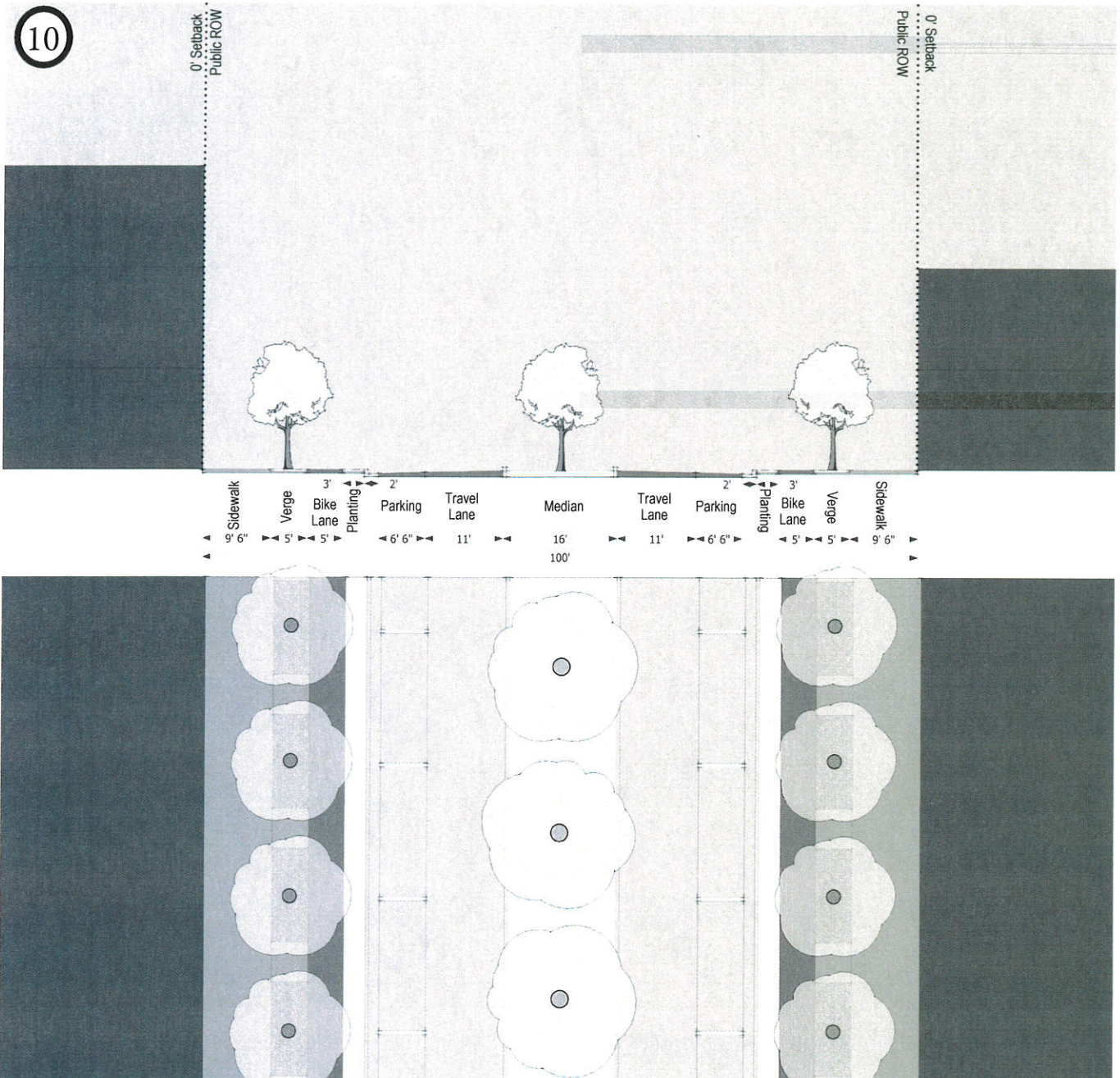

Affected NRD Corridor:
 NW 5th AV between NW 29th ST and NW 22nd ST

THIS PAGE LEFT INTENTIONALLY BLANK.